



**GREATER
CAMBRIDGE
PARTNERSHIP**

Growing and sharing prosperity

— Delivering our City Deal —



Histon Road Preliminary Concept

Paul van de Bulk / Neil Poulton
05 March 2018



Programme and Timescales 2018

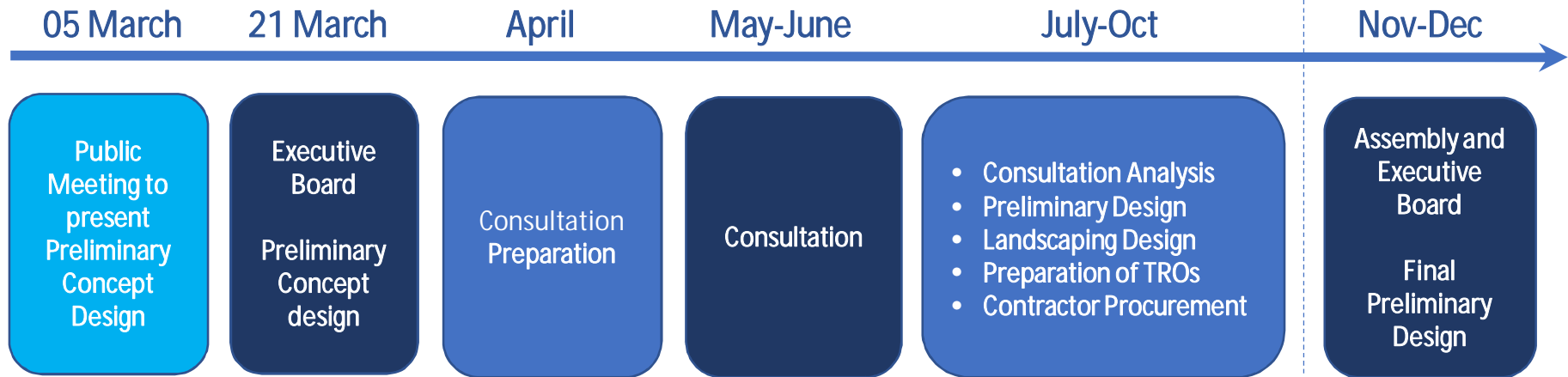

Histon Road Project Objectives

- Comprehensive priority for buses in both directions wherever practicable;
- Safer and more convenient routes for cycling and walking, segregated where practical and possible;
- Enhance the environment, streetscape and air quality;
- Additional capacity for sustainable trips to employment/education sites;
- Increased bus patronage and new services; and
- Maintain or reduce general traffic levels.



Design Workshops / Engagement / LLF Resolutions

The Preliminary Concept Design has been influenced from a number of past workshops and ideas from LLF. Which included:

- Six Stakeholder Workshops (1A / 1B / 2A / 2B/ 3 & 4) were held in the later half of 2016. These were independently facilitated and focused on design parameters and constraints
 - First two workshops focussed on highway cross sections, main junction designs and bus lanes;
 - Second two workshops focussed on minor side roads, bus stops and landscaping, drainage and street furniture;
 - Workshop 3 - focussed on junctions of Victoria Rd and Gilbert Rd;
 - Workshop 4 - focussed on parking and off-route traffic management (rat running).
- 2016/17 - LLF Resolution meetings and discussions
- 2017 - LLF Meeting to discuss Parking Survey Methodology



Design Workshops / Engagement / LLF Resolutions

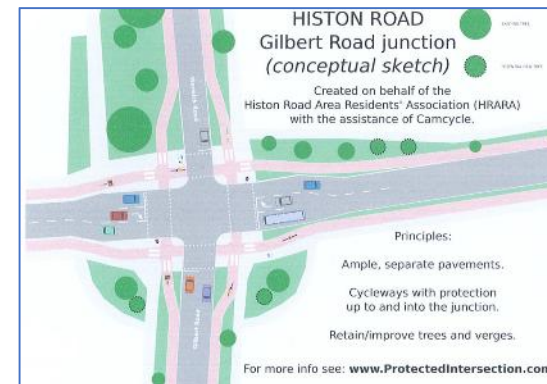
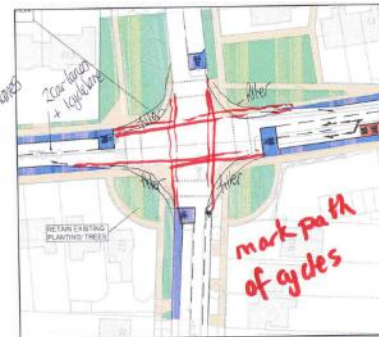
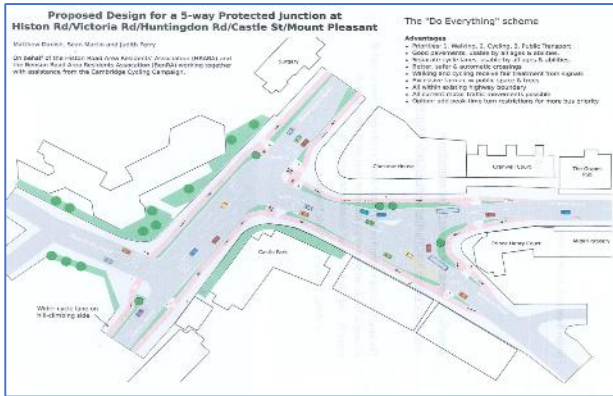

Histon Road Parking

- Proposals for Histon Road include removal of Highway Parking.
- Removal of parking from this area needs to be mitigated.
- Survey work has been undertaken to assess parking requirements and space within the general area.
- Methodology agreed with the Histon Road LLF in November 2017.

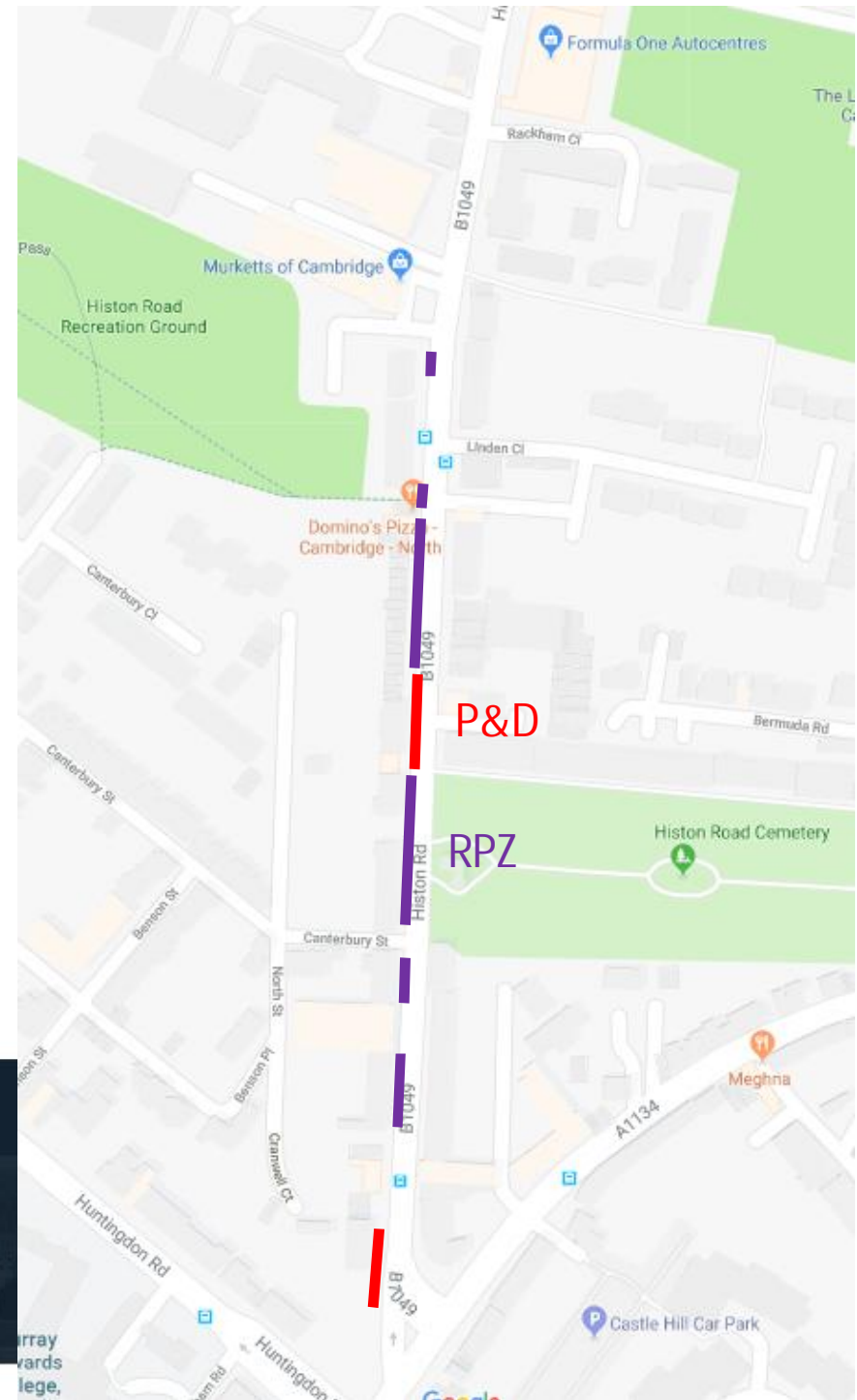

Parking Survey

Beat Times:

- 06:30 – 09:30
- 18:00 – 21:30

The survey included:

- On-street parking including residents bays;
- Pay and display;
- Single and double yellow lines;
- Time of restrictions; and
- Disabled parking

Parking survey repeated in 15 minute intervals to measure duration of stay based on vehicle licence plates.

3 consecutive days - Tuesday 28th, Wednesday 29th and Thursday 30th November 2017

Survey Area

- Histon Road (to Gilbert Rd junction)
- Huntingdon Road (to Halifax Rd)
- Akeman Street
- Windsor Road
- Rackham Close
- Linden Close
- Entire Benson CPZ

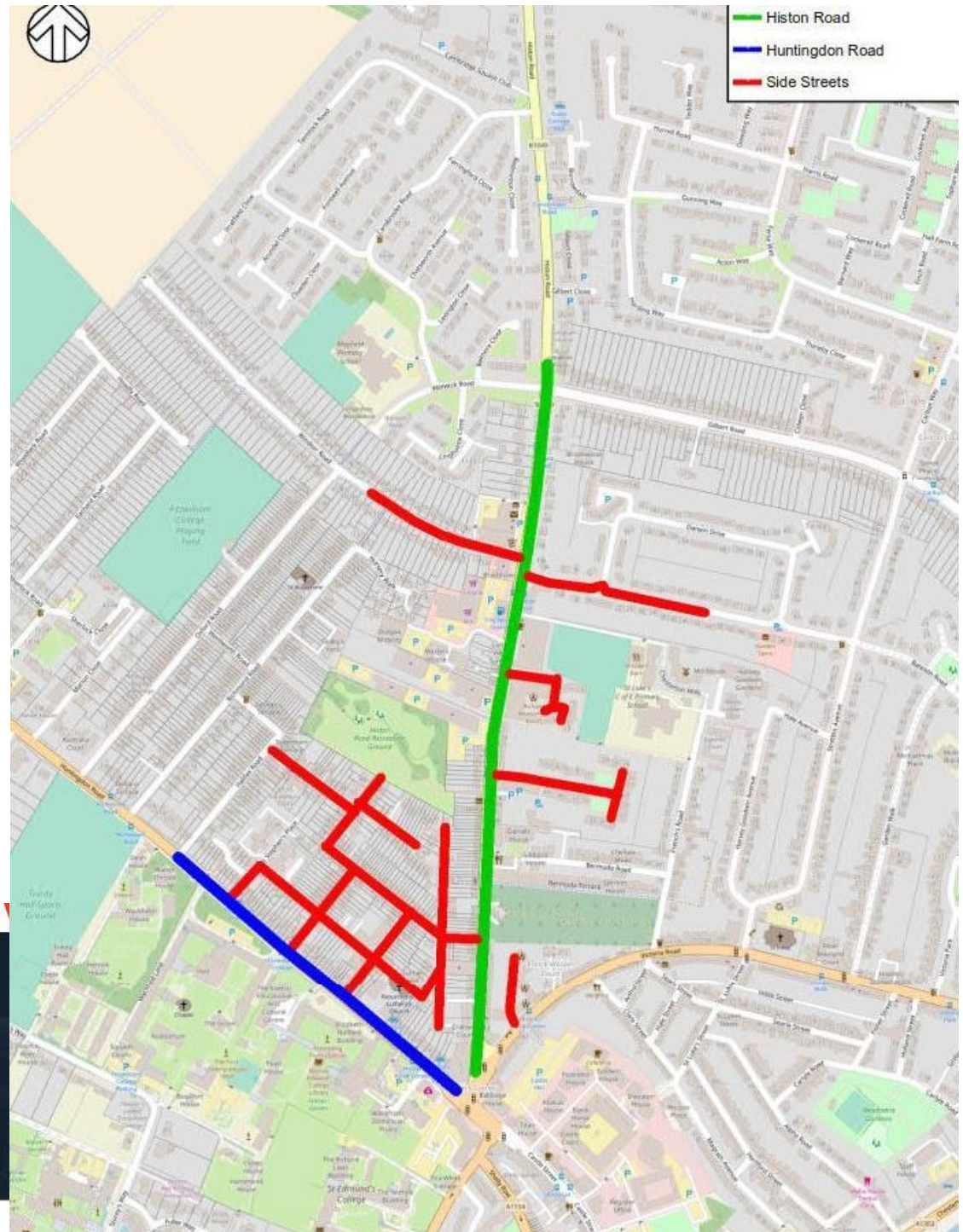

Survey Results

28/11/2017

	No of Parking Bays	No of P&D	Max Occupancy Excl P&D	Max Occupancy P&D	Spare Spaces
AKEMAN STREET	35		16		19
HISTON ROAD SIDE ROAD	1		4		-3
LINDEN CLOSE	58		32		26
RACKHAM CLOSE	7		6		1
WINDSOR ROAD	22		10		12
HISTON ROAD Excluding P&D	62		30		32
HISTON ROAD P&D		11		6	
BENSON PLACE	5		4		1
BENSON STREET	38		23		15
CANTERBURY CLOSE	7		7		0
CANTERBURY STREET Excluding P&D	56		37		19
CANTERBURY STREET P&D		4		2	
HUNTINGDON ROAD Excluding P&D	30		14		16
HUNTINGDON ROAD P&D		10		2	
NORTH STREET	14		11		3
PRIORY STREET	28		18		10
WESTFIELD LANE	4		2		2
WESTFIELD ROAD	6		2		4
Benson Area RPZ	188		118		70



Histon Road Preliminary Concept: Victoria Road Junction

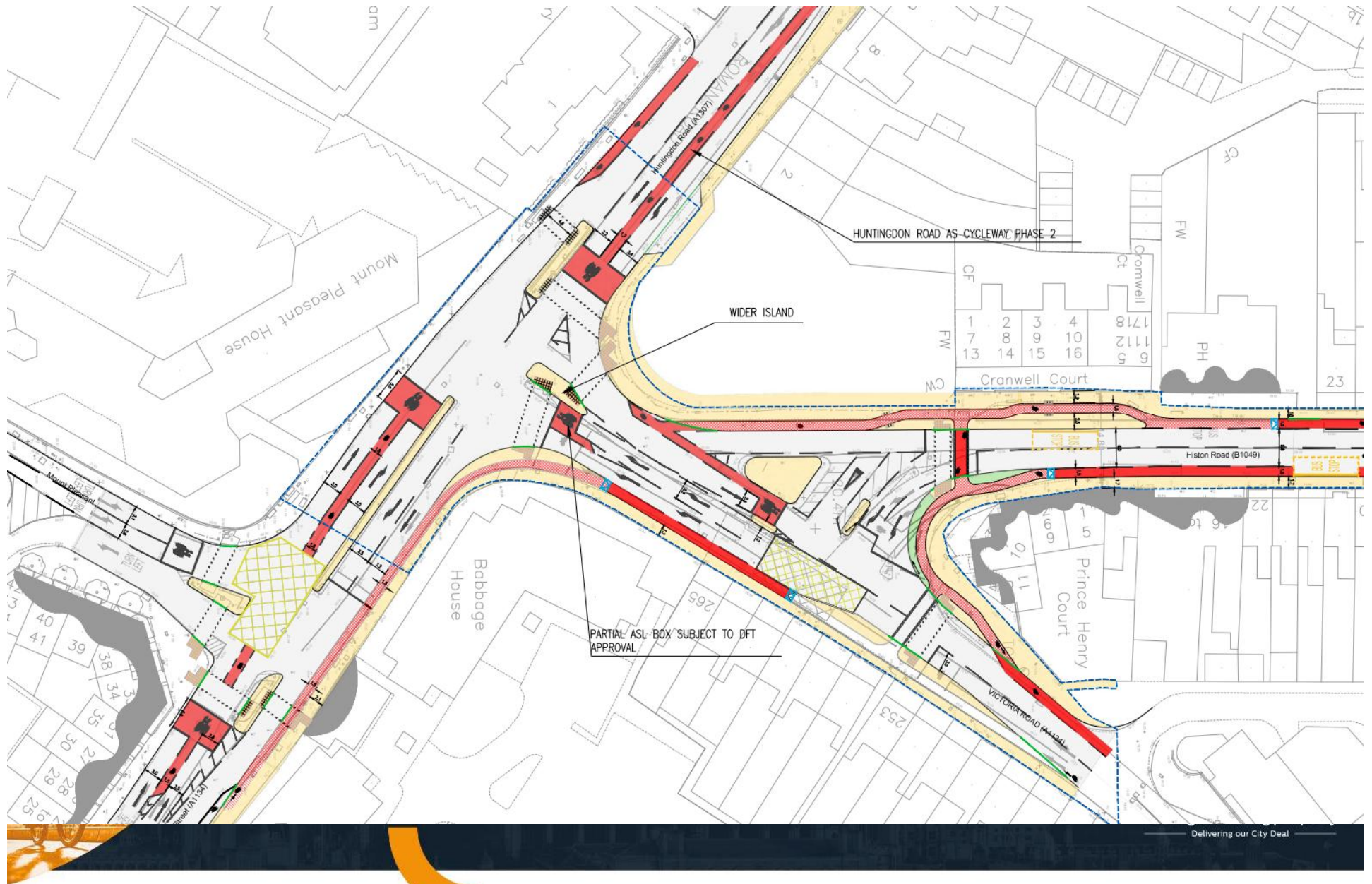

Histon Road Preliminary Concept: Gilbert Road Junction

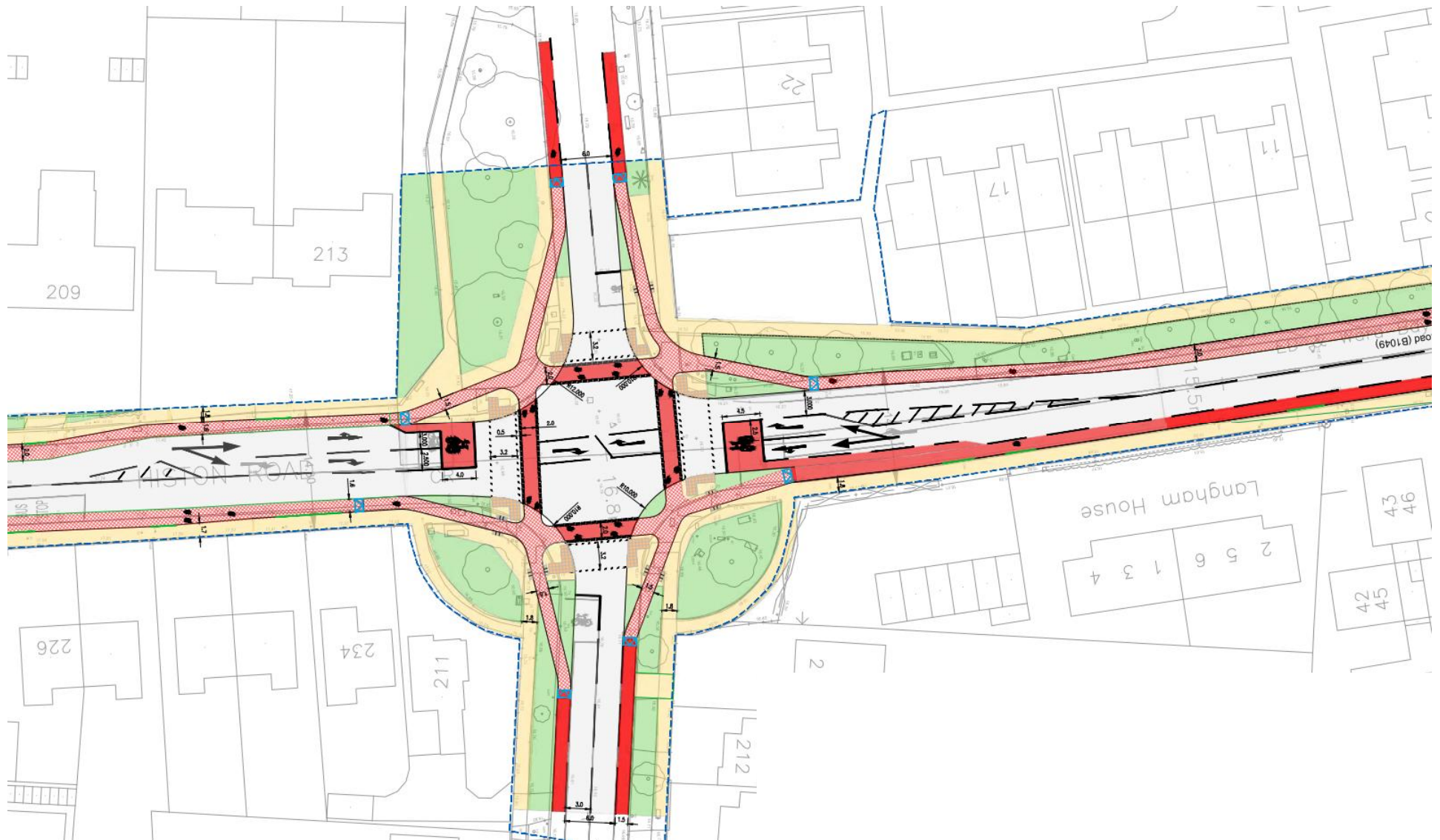

Histon Road Preliminary Concept: Darwin Green Junction

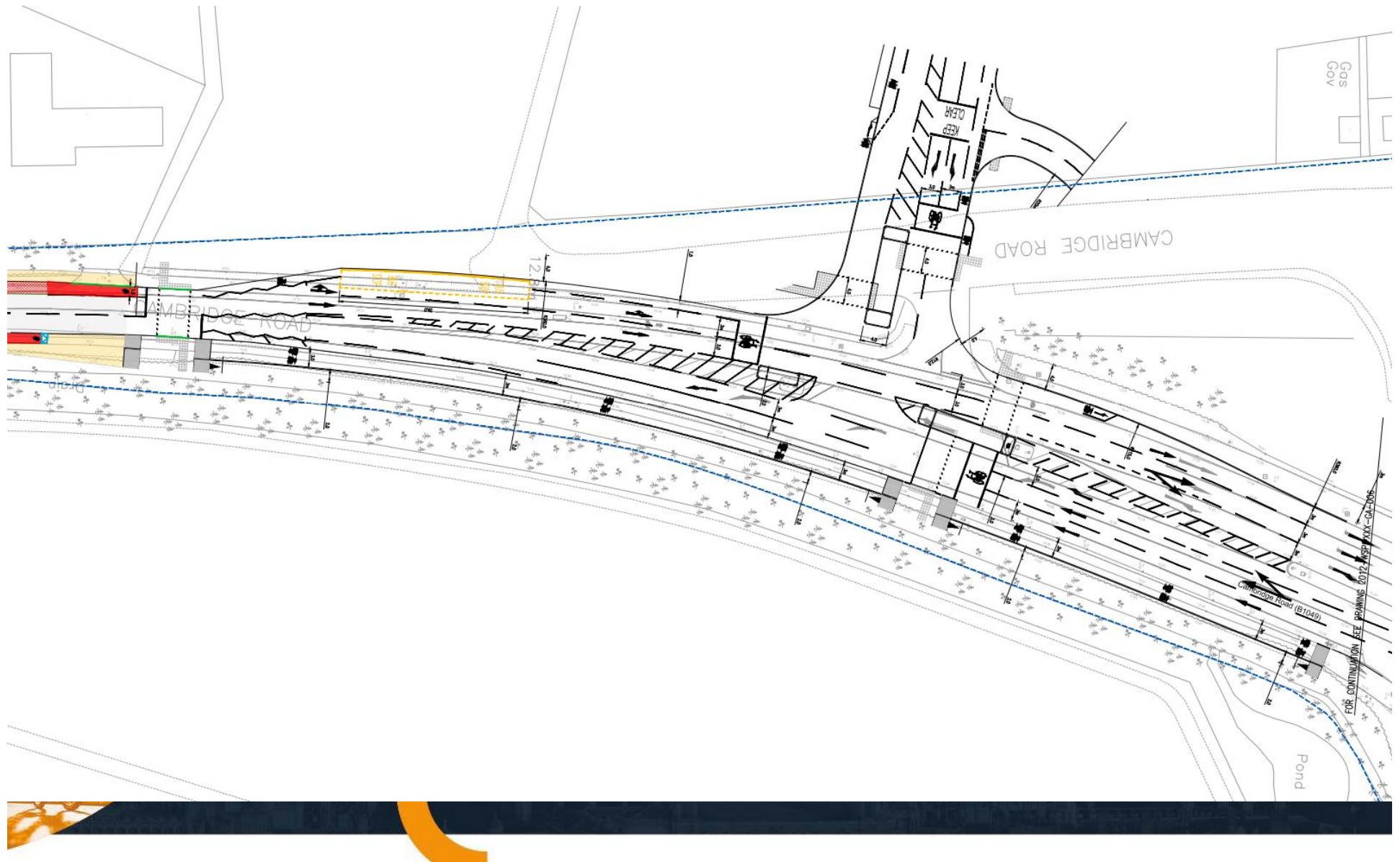

Bus Stops & Crossings

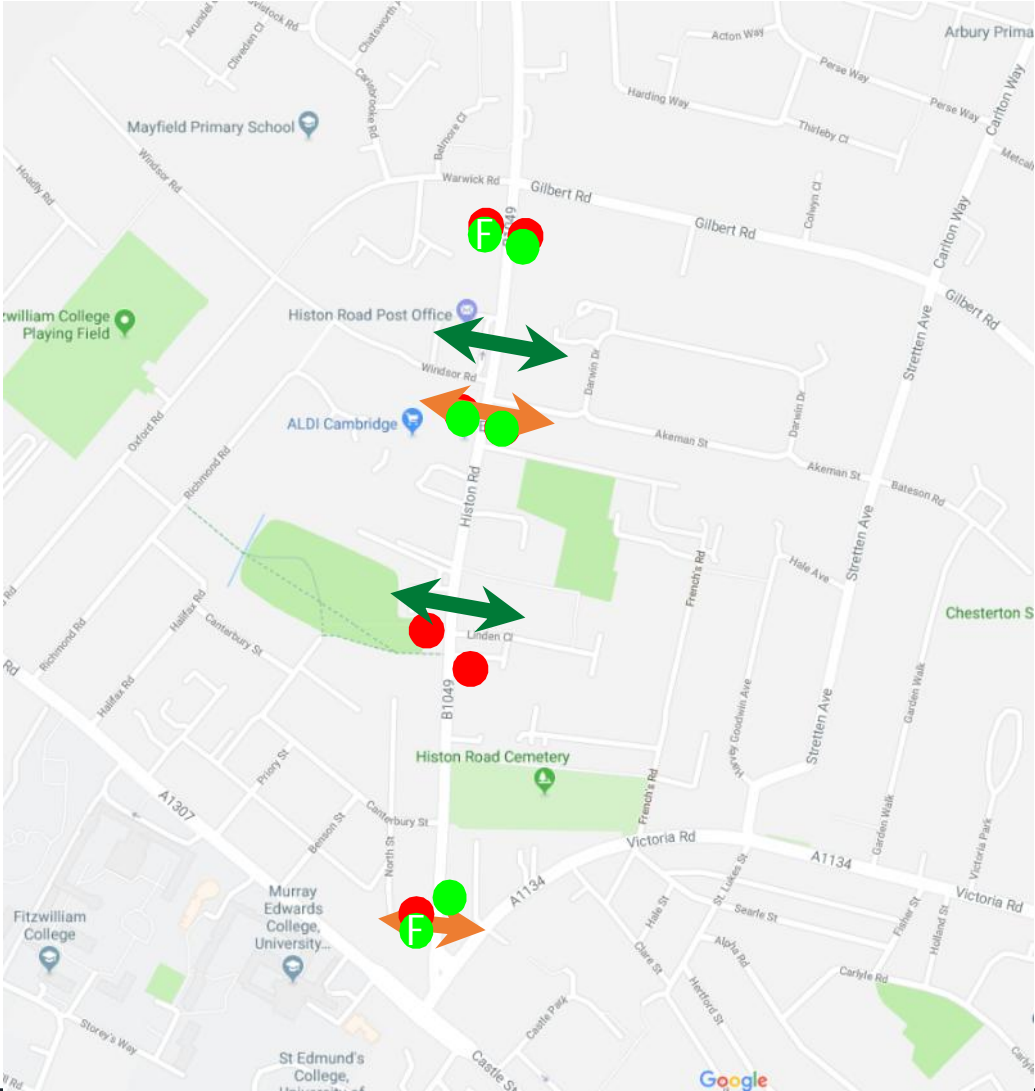

- Current bus stops
- Suggested Bus stops Location
- ↔ Current crossings
- ↔ Suggested additional crossings



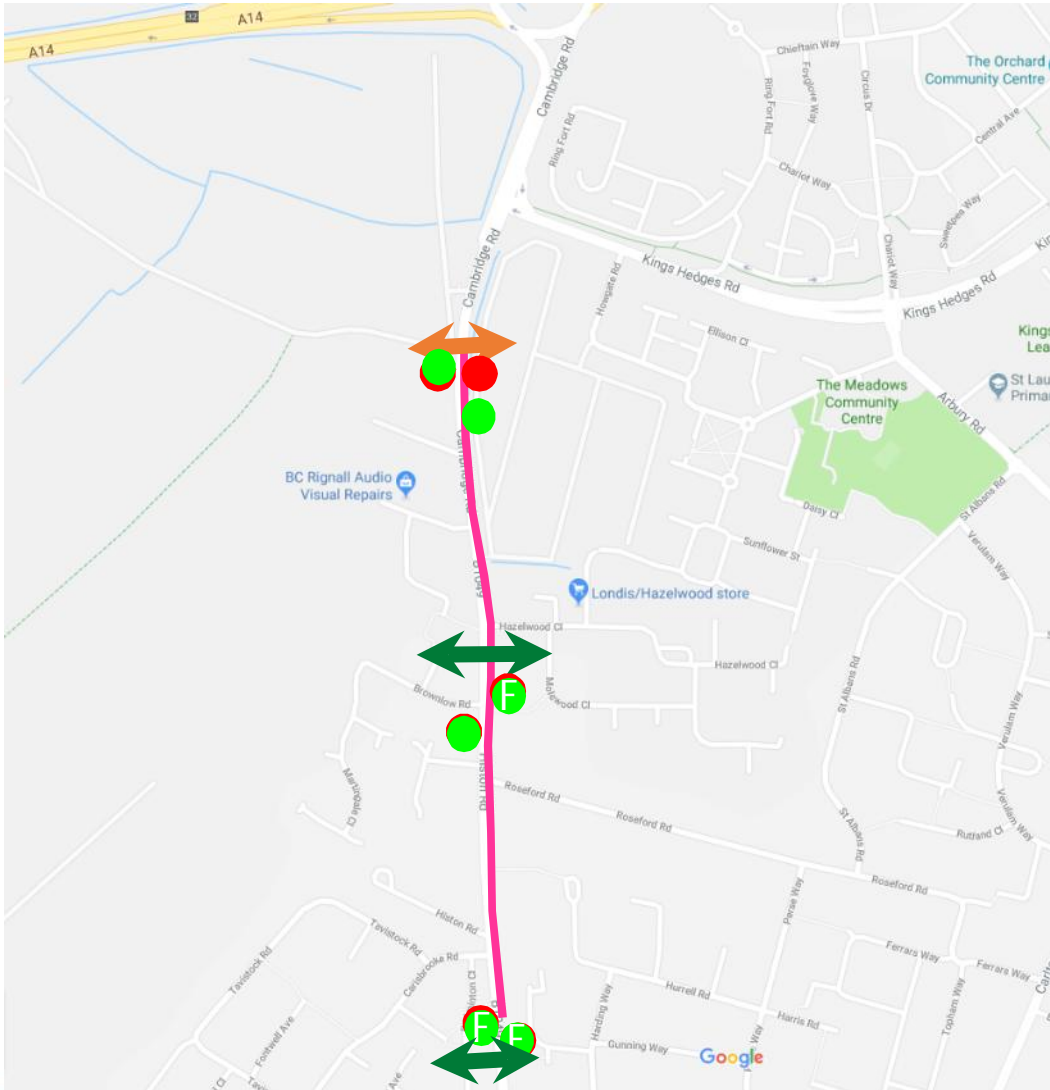

Bus Stops, & Crossings Bus Lane

- Current bus stops
- Suggested Bus stops Location
- ↔ Current crossings
- ↔ Suggested additional crossings
- Proposed Bus Lane



Bus Lanes

Bus Lane commences at Blackhall Road due to physical constraints of drainage ditch & levels, on western side of the road further north



Bus Lanes

Following discussions with tree officer, Bus Lane terminated at Carisbrooke Road to maintain current row of trees

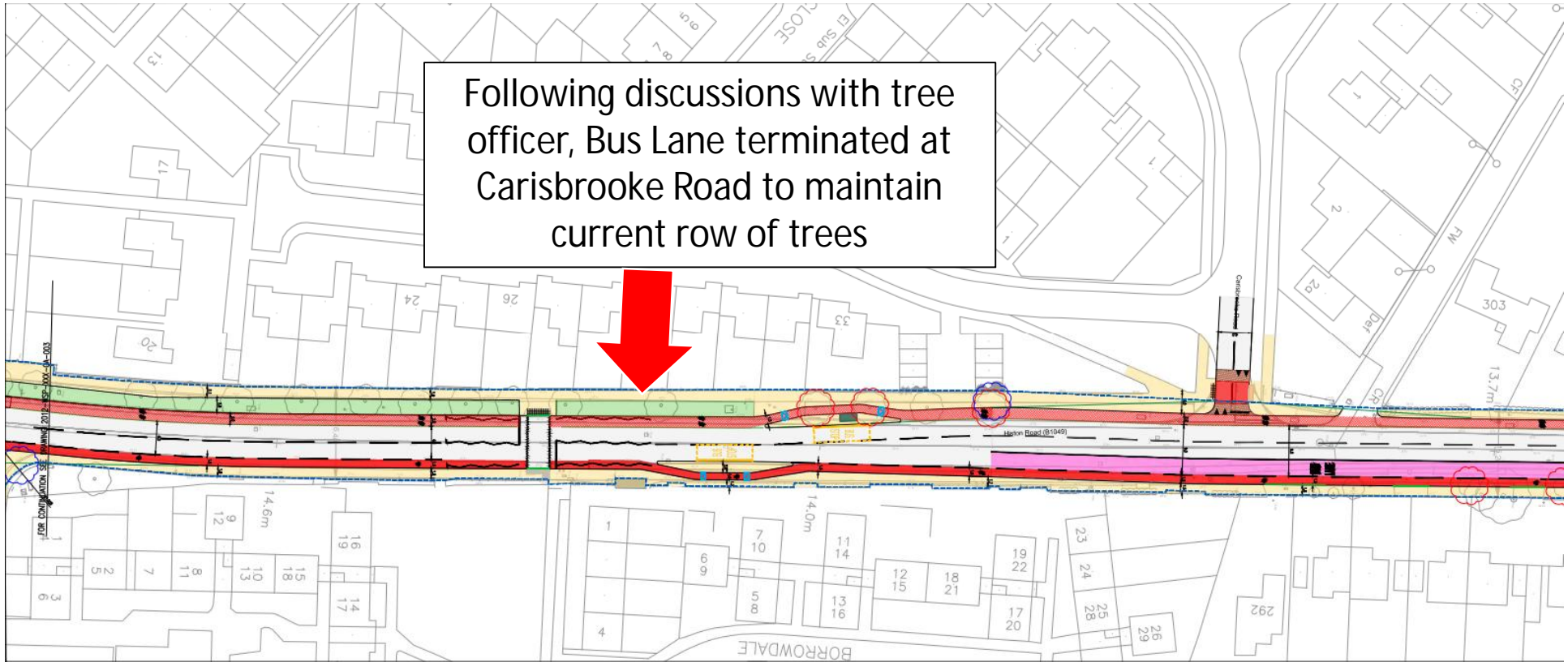

Bus Stops

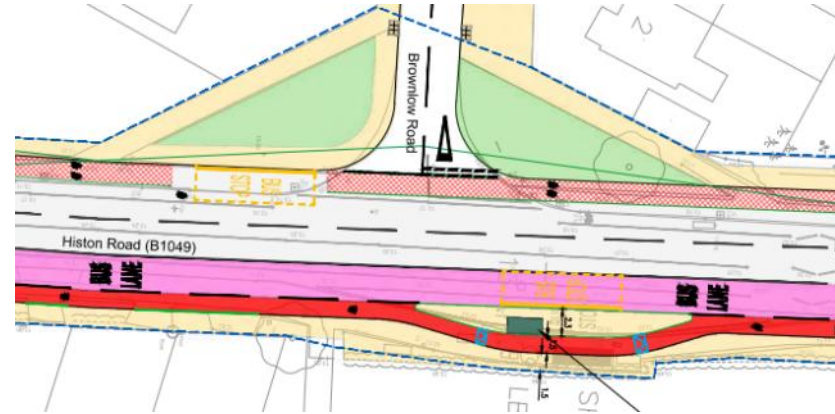

Cycle Lanes

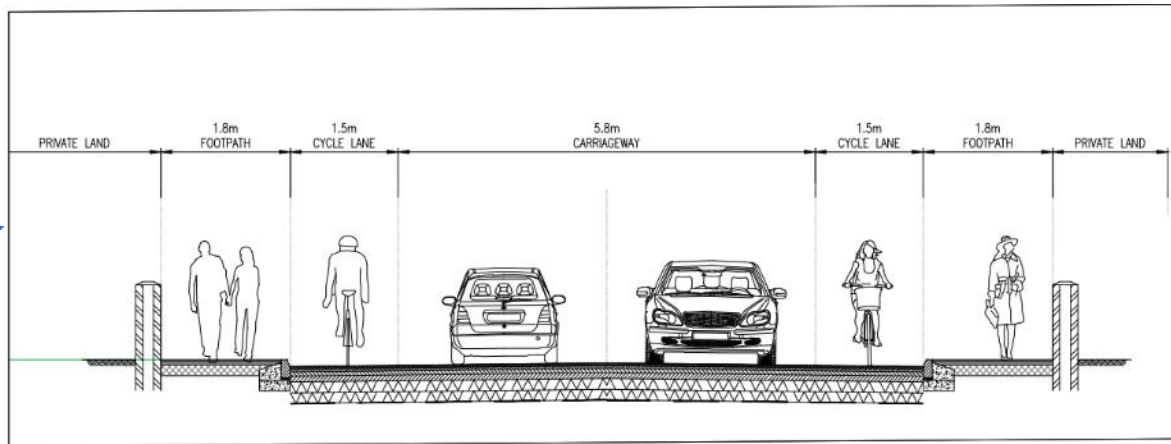
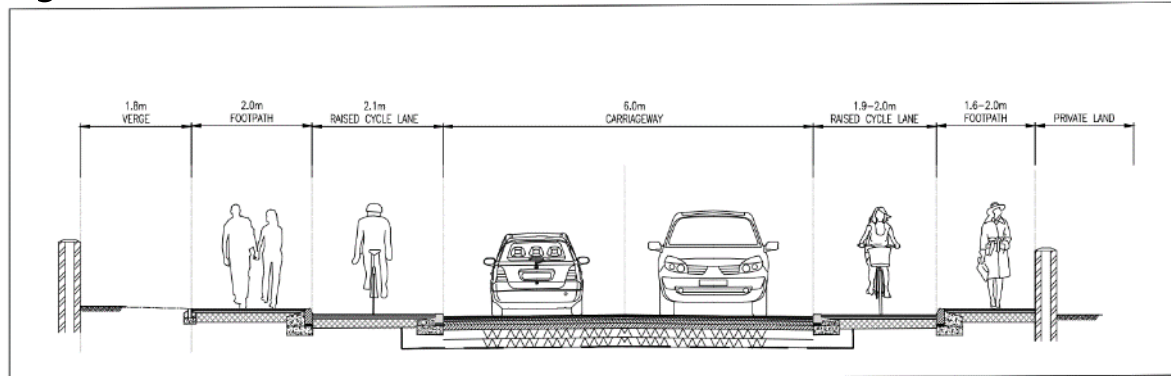
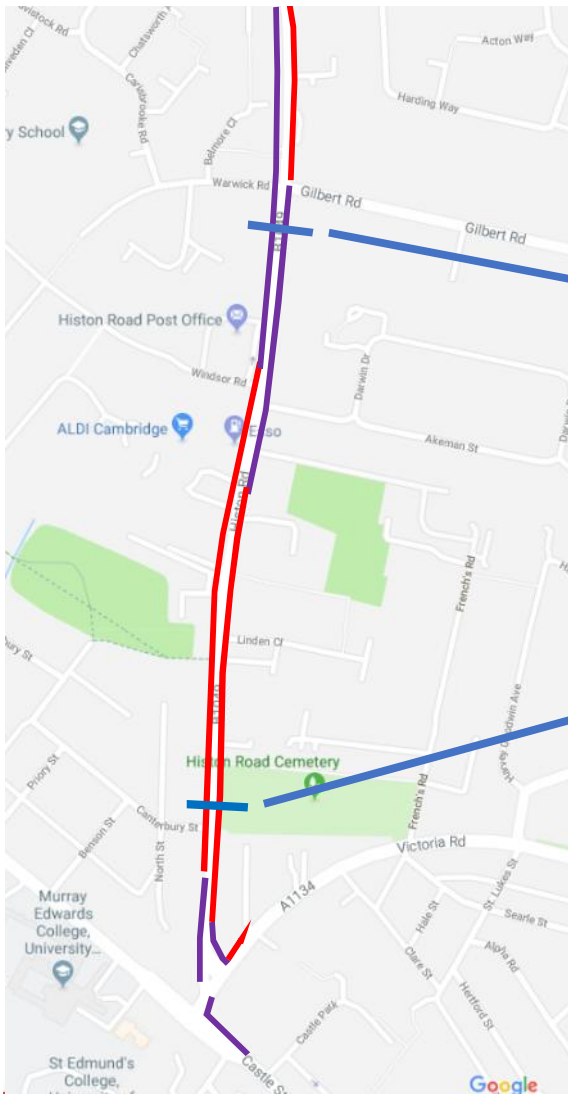

- Raised Cycle Way
- Advisory Cycle Lane
- Bus Lane



Cycle Lanes

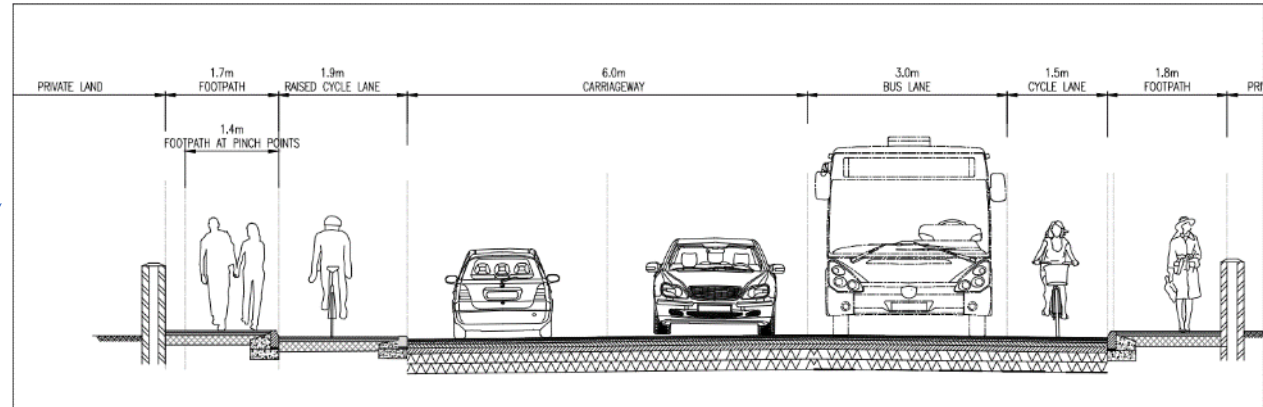
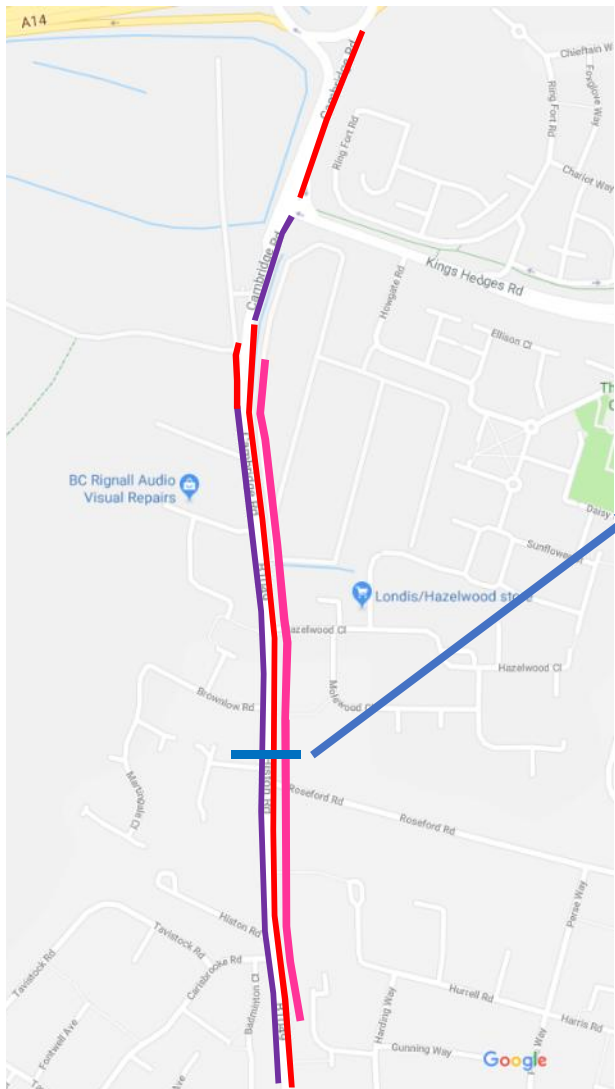

- Raised Cycle Way
- Advisory Cycle Lane
- Bus Lane

Side Road Treatments

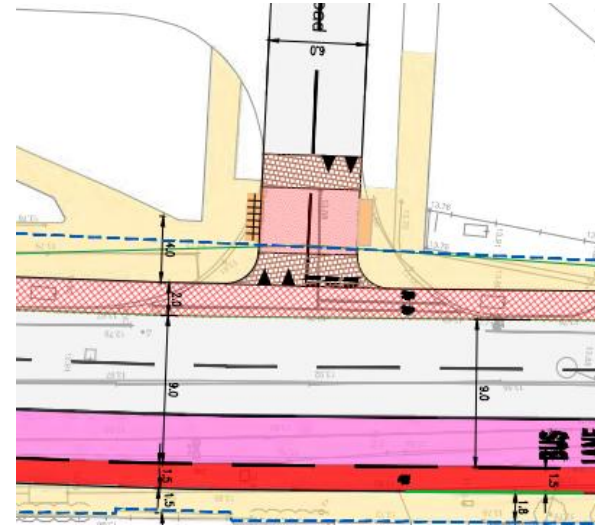

Trees and Landscaping

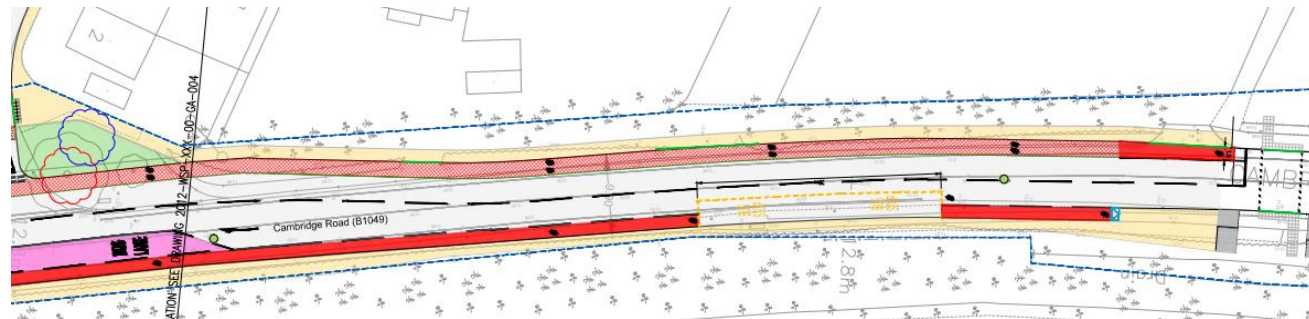

Next Steps

Further Development of the Preliminary Design

Alongside the consultation, extensive work will be taking place with the Signals and Safety team to ensure the junction designs are both safe and function correctly.

Side road crossings will be re-reviewed based on consultation feedback

A full mitigation package will be put together with regard to parking

The landscape architect will finalise plans for the landscaping areas.



Programme and Timescales 2018

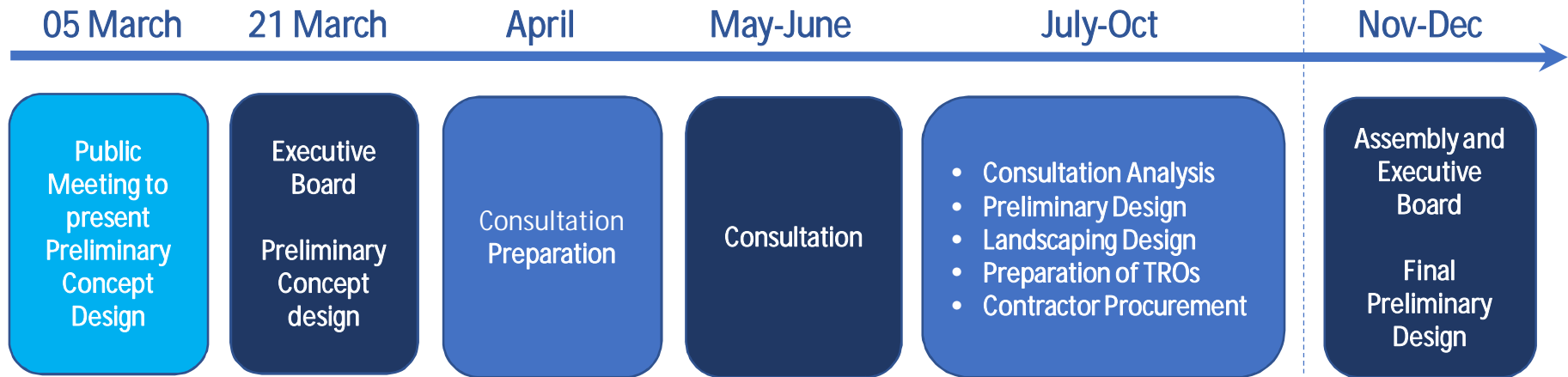

Discussion



Growing and sharing prosperity
— Delivering our City Deal —