

DO NOT SCALE

Millimetres

0 10 100

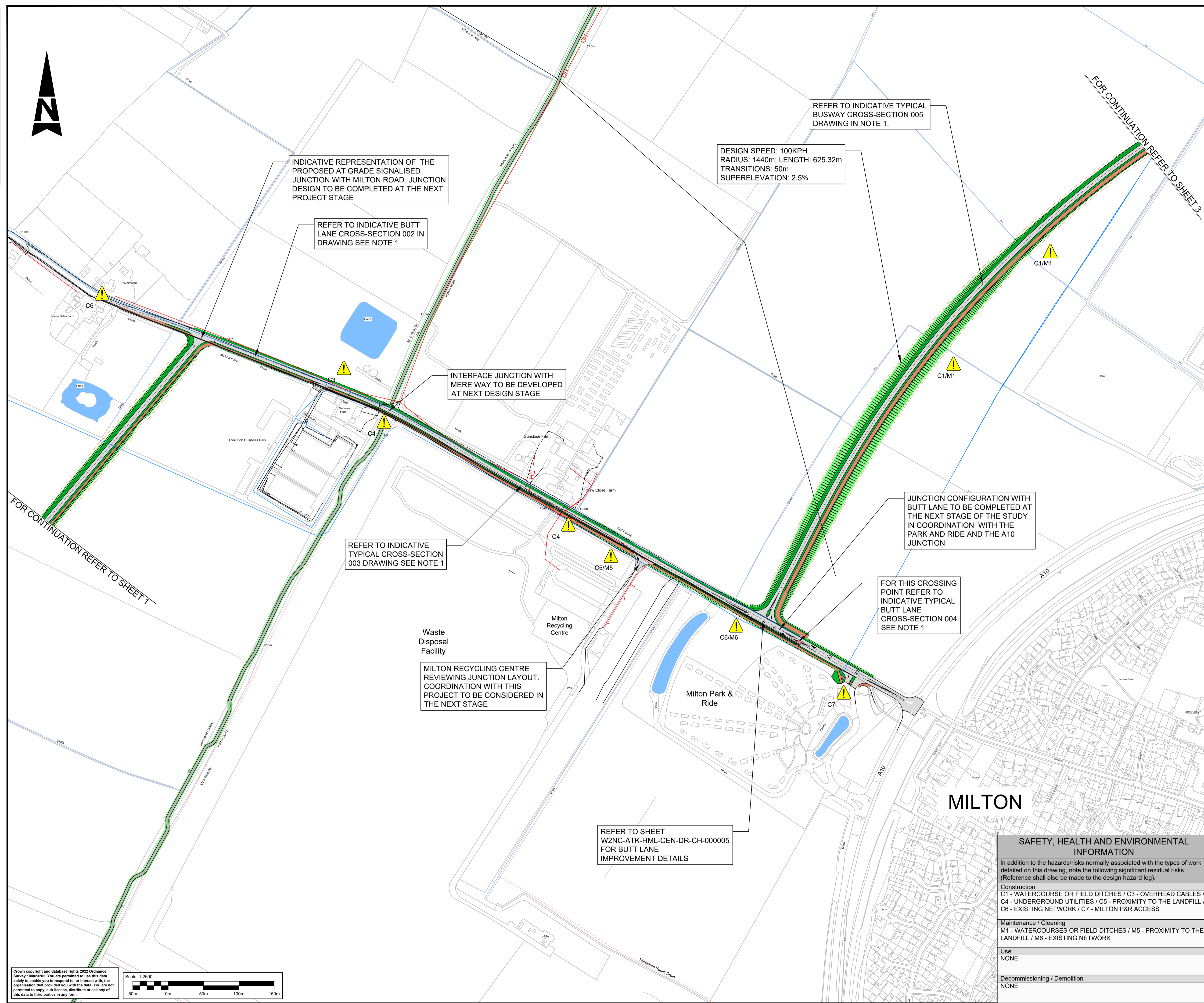
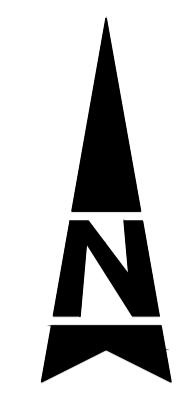

- NOTES:**
- THIS SHOULD BE READ IN CONJUNCTION WITH THE TYPICAL CROSS-SECTIONS W2NC-ATK-HGN-XX-DR-CH-000001 TO 000003 AND DESIGN REPORT W2NC-ATK-HGN-XX-RP-CH-000001.
  - PROPOSED EARTHWORK SLOPES TO BE 1(H) : 3(V) . THIS IS INDICATIVE ONLY AND TO BE CONFIRMED IN NEXT STAGES AFTER GROUND INVESTIGATIONS
  - PLANTING AND LANDSCAPING DETAILS ARE FOR ILLUSTRATIVE PURPOSES ONLY.
  - WATERBODY CROSSINGS TO BE DESIGNED IN NEXT STAGES.
  - SOME MINOR MODIFICATION TO SIDE ROADS MAY BE NECESSARY. THESE WILL BE CONSIDERED IN DETAIL IN THE NEXT STAGE.
  - DEPARTURES IDENTIFIED ARE INDICATIVE AT THIS STAGE AND TO BE CONFIRMED AT THE NEXT ONE.
  - DRAINAGE AND SUDS FEATURES TO BE DESIGNED IN THE NEXT STAGE. THESE ARE TO BE INCORPORATED WITH THE HIGHWAY BOUNDARY.
  - MERE WAY WORKS ARE BEING DEVELOPED BY OTHERS

**KEY:**

	PROPOSED BUSWAY / CARRAGEWAY
	PROPOSED VERGE/SWALE
	PROPOSED EARTHWORKS
	PROPOSED FOOTWAY/CYCLEWAY
	EXISTING PONDS / LAKES
	EXISTING RELEVANT FIELD / HIGHWAY DITCHES
	UNDERGROUND UTILITIES
	OVERHEAD CABLE
	PERMITTED WASTE BOUNDARY - MILTON RECYCLING CENTRE
	CAMBRIDGE WATER COMPANY - WATER MAINS
	PROPOSED HIGHWAY BOUNDARY FENCE

Description	Status	Revision	Drawn	Checked	Reviewed	Authorised	Issue Date

Description	Status	Revision	Drawn	Checked	Reviewed	Authorised	Issue Date
AMENDMENTS AFTER GCP AND AUTHORISED COMMENTS	A1	CO2	TFL	DS	PRM	AB	28/11/22

Description	Status	Revision	Drawn	Checked	Reviewed	Authorised	Issue Date
FIRST ISSUE	A1	CO1	TFL	DS	PRM	AB	20/10/22

APPROVED - PUBLISHED A1

**SNC-LAVALIN**  
**ATKINS**  
Member of the SNC-Lavalin Group  
Copyright © SNC Lavalin (2022)

5 Wellbrook Court  
Girton Road  
Cambridge  
Cambridgeshire  
CB3 0NA  
Tel: +44 (0)1223 276002  
Fax: +44 (0)1223 277529  
www.atkinsglobal.com

**GREATER CAMBRIDGE PARTNERSHIP**  
Growing and sharing prosperity  
Delivering our City Deal

Project Title: WATERBEACH TO CAMBRIDGE BUSWAY

Drawing Title: CENTRAL CORRIDOR

Drawing Number: W2NC - ATK - HML -  
Project: CEN - DR - CH - 000002

Original Size: A1	Scale: 1:2500	Project Ref. No: 5209223	Sheet: 2 of 5	Rev: C02
-------------------	---------------	--------------------------	---------------	----------

**SAFETY, HEALTH AND ENVIRONMENTAL INFORMATION**

In addition to the hazards/risks normally associated with the types of work detailed on this drawing, note the following significant residual risks (Reference shall also be made to the design hazard log).

**Construction**  
C1 - WATERCOURSE OR FIELD DITCHES / C3 - OVERHEAD CABLES / C4 - UNDERGROUND UTILITIES / C5 - PROXIMITY TO THE LANDFILL / C6 - EXISTING NETWORK / C7 - MILTON P&R ACCESS

**Maintenance / Cleaning**  
M1 - WATERCOURSES OR FIELD DITCHES / M5 - PROXIMITY TO THE LANDFILL / M6 - EXISTING NETWORK

**Use**  
NONE

**Decommissioning / Demolition**  
NONE

Crown copyright and database rights 2022 Ordnance Survey 100023206. You are permitted to use this data solely to enable you to respond to, or interact with, the organisation that provided you with the data. You are not permitted to copy, sub-license, distribute or sell any of this data to third parties in any form.

Scale 1:2500