

- NOTES**
- DO NOT SCALE FROM THIS DRAWING.
 - ALL DIMENSIONS ARE IN METRES UNLESS OTHERWISE STATED.
 - LIMITS OF WORK ARE APPROXIMATE AND ARE TO BE AGREED ON SITE WITH THE OVERSEEING ORGANISATION.
 - ANY WORK OUTSIDE THE HIGHWAY BOUNDARY NEEDS PRIOR PERMISSION FROM THE LAND OWNER.
 - HEALTH AND SAFETY:
THE CONTRACTOR SHALL BE AWARE OF ALL STATUTORY UNDERTAKERS PLANT THAT MAY BE LOCATED WITHIN THE SITE. PLANS SHOWING APPROXIMATE LOCATIONS HAVE BEEN SUPPLIED BY ASSET OWNER. A SET OF CURRENT (LESS THAN 90 DAYS OLD) C2 RETURNS WILL BE PROVIDED TO THE CONTRACTOR AT THE START OF WORKS.

SAFETY, HEALTH AND ENVIRONMENTAL INFORMATION

In addition to the hazards/risks normally associated with the types of work detailed on this drawing, note the following significant residual risks (Reference shall also be made to the design hazard log).

Construction
Presence of live traffic and utilities.
Presence of tar, soil contamination, asbestos and breaking of concrete not known.

Maintenance / Cleaning
None

Use
None

Decommissioning / Demolition
None

P01	RG	PM	AC	28/06/24
-----	----	----	----	----------

First Issue

P02	SS	ANV	AC	29/01/25
-----	----	-----	----	----------

Road Humps Location Updated and Added 20mph Roundel

P03	DM	ANV	AC	05/02/25
-----	----	-----	----	----------

Lighting Column and Traffic Signal added with other Updates

P04	DM	ANV	AC	17/02/25
-----	----	-----	----	----------

Proposal Updated

Rev	Drawn / Des	Checked	Approved	Date
-----	-------------	---------	----------	------

Description

Drawing Status

FOR INFORMATION

S2

5 Wellbrook Court,
Cambridge
CB3 0NA

Tel: +44 (0) 1223276002

Copyright © AtkinsRéalis (2025)

Client

GREATER CAMBRIDGE PARTNERSHIP

Growing and sharing prosperity
Delivering our City Deal

Project Title

Melbourn Greenway Detailed Design

Drawing Title

HIGHWAYS LAYOUT PLAN

MELBOURN (SCHEME 6)

(SHEET 1 OF 4)

Scale	Designed / Drawn	Checked	Approved	Authorised
-------	------------------	---------	----------	------------

1:1000	DM	ANV	AC	---
--------	----	-----	----	-----

Original Size	Date	Date	Date	Date
---------------	------	------	------	------

A1	17/02/25	17/02/25	17/02/25	---
----	----------	----------	----------	-----

Drawing Number	Project	Originator	Volume	Job No.
----------------	---------	------------	--------	---------

5228275	ATK	HGN	MELB	5228275
---------	-----	-----	------	---------

Location	Type	Role	Number	Revision
----------	------	------	--------	----------

DR	CH	000001	P04	
----	----	--------	-----	--

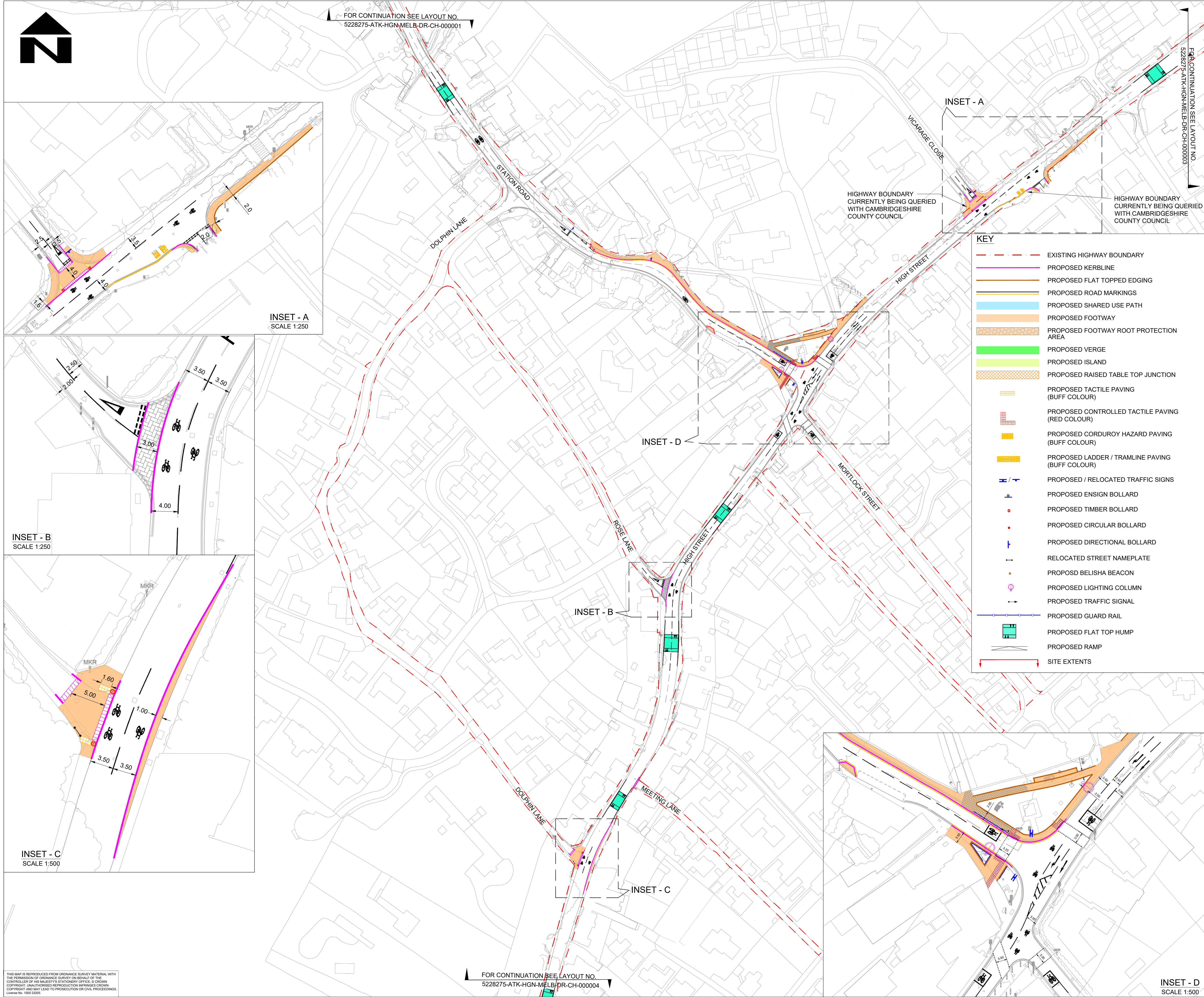

NOTES

- DO NOT SCALE FROM THIS DRAWING.
- ALL DIMENSIONS ARE IN METRES UNLESS OTHERWISE STATED.
- LIMITS OF WORK ARE APPROXIMATE AND ARE TO BE AGREED ON SITE WITH THE OVERSEEING ORGANISATION.
- ANY WORK OUTSIDE THE HIGHWAY BOUNDARY NEEDS PRIOR PERMISSION FROM THE LAND OWNER.
- HEALTH AND SAFETY:
THE CONTRACTOR SHALL BE AWARE OF ALL STATUTORY UNDERTAKERS PLANT THAT MAY BE LOCATED WITHIN THE SITE. PLANS SHOWING APPROXIMATE LOCATIONS HAVE BEEN SUPPLIED BY ASSET OWNER A SET OF CURRENT (LESS THAN 90 DAYS OLD) C2 RETURNS WILL BE PROVIDED TO THE CONTRACTOR AT THE START OF WORKS.

SAFETY, HEALTH AND ENVIRONMENTAL INFORMATION

In addition to the hazards/risks normally associated with the types of work detailed on this drawing, note the following significant residual risks (Reference shall also be made to the design hazard log).

Construction
Presence of live traffic and utilities.
Presence of tar, soil contamination, asbestos and breaking of concrete not known.

Maintenance / Cleaning
None

Use
None

Decommissioning / Demolition
None

	P01	RG	PM	AC	28/06/24
First Issue	P02	SS	ANV	AC	29/01/25
Road Humps Location Updated and Added 20mph Roundel	P03	DM	ANV	AC	05/02/25
Lighting Column and Traffic Signal added with other Updates	P04	DM	ANV	AC	17/02/25

Proposal Updated

Rev	Drawn / Des	Checked	Approved	Date
Description				

Drawing Status	Suitability
FOR INFORMATION	S2

5 Wellbrook Court,
Cambridge
CB3 0NA

Tel: +44 (0) 1223276002
www.atkinsrealis.com

Copyright © AtkinsRéalis (2025)

Client

GREATER CAMBRIDGE PARTNERSHIP
Growing and sharing prosperity
Delivering our City Deal

Project Title
Melbourn Greenway Detailed Design

Drawing Title
**HIGHWAYS LAYOUT PLAN
MELBOURN (SCHEME 6)
(SHEET 2 OF 4)**

Scale	Designed / Drawn	Checked	Approved	Authorised
1:1000	DM	ANV	AC	---
Original Size	Date	Date	Date	Date
A1	17/02/25	17/02/25	17/02/25	---

Drawing Number	Project	Originator	Volume	Job No.
5228275	ATK HGN	MELB	000002	5228275
DR	CH			Revision
				P04

FOR CONTINUATION SEE LAYOUT NO. 5228275-ATK-HGN-MELB-DR-CH-000001

FOR CONTINUATION SEE LAYOUT NO. 5228275-ATK-HGN-MELB-DR-CH-000003

FOR CONTINUATION SEE LAYOUT NO. 5228275-ATK-HGN-MELB-DR-CH-000004

THIS MAP IS REPRODUCED FROM ORDNANCE SURVEY MATERIAL WITH THE PERMISSION OF ORDNANCE SURVEY ON BEHALF OF THE CONTROLLER OF HIS MAJESTY'S STATIONERY OFFICE. © CROWN COPYRIGHT. UNAUTHORISED REPRODUCTION INFRINGES CROWN COPYRIGHT AND MAY LEAD TO PROSECUTION OR CIVIL PROCEEDINGS. License No. 1000 23055

CAD FILE: C:\projectwise\atkins_transportation_uk\0439168\5228275-ATK-HGN-MELB-DR-CH-000002.dwg

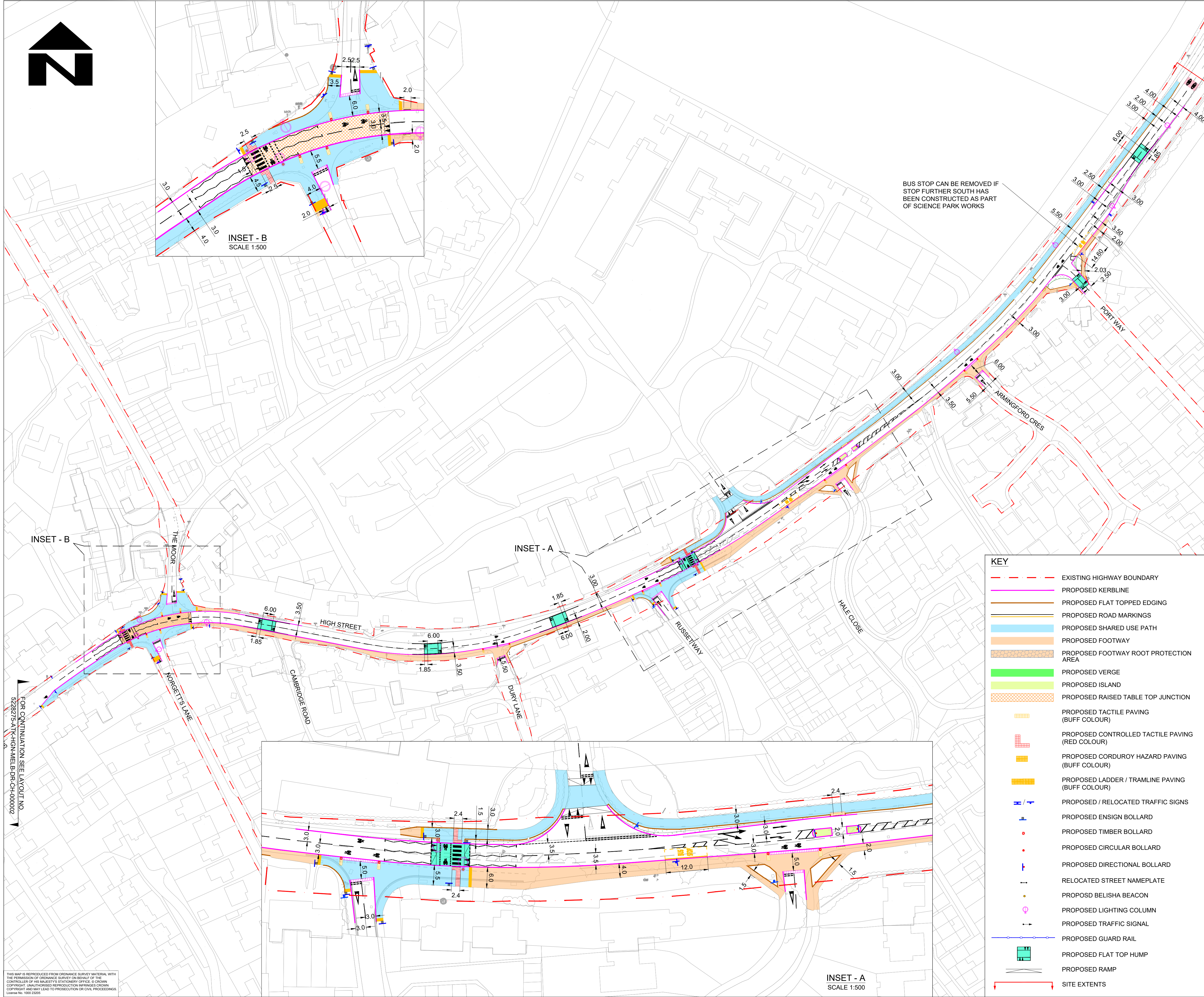

NOTES

- DO NOT SCALE FROM THIS DRAWING.
- ALL DIMENSIONS ARE IN METRES UNLESS OTHERWISE STATED.
- LIMITS OF WORK ARE APPROXIMATE AND ARE TO BE AGREED ON SITE WITH THE OVERSEEING ORGANISATION.
- ANY WORK OUTSIDE THE HIGHWAY BOUNDARY NEEDS PRIOR PERMISSION FROM THE LAND OWNER.
- HEALTH AND SAFETY:
THE CONTRACTOR SHALL BE AWARE OF ALL STATUTORY UNDERTAKERS PLANT THAT MAY BE LOCATED WITHIN THE SITE. PLANS SHOWING APPROXIMATE LOCATIONS HAVE BEEN SUPPLIED BY ASSET OWNER. A SET OF CURRENT (LESS THAN 90 DAYS OLD) C2 RETURNS WILL BE PROVIDED TO THE CONTRACTOR AT THE START OF WORKS.

SAFETY, HEALTH AND ENVIRONMENTAL INFORMATION

In addition to the hazards/risks normally associated with the types of work detailed on this drawing, note the following significant residual risks (Reference shall also be made to the design hazard log).

Construction
Presence of live traffic and utilities.
Presence of tar, soil contamination, asbestos and breaking of concrete not known.

Maintenance / Cleaning
None

Use
None

Decommissioning / Demolition
None

	P01	RG	PM	AC	28/06/24
First Issue	P02	SS	ANV	AC	29/01/25
Road Humps Location Updated and Added 20mph Roundel	P03	DM	ANV	AC	05/02/25
Lighting Column and Traffic Signal added with other Updates	P04	DM	ANV	AC	17/02/25
Proposal Updated	Rev	Drawn / Des	Checked	Approved	Date
Description					
Drawing Status					Suitability
					S2

5 Wellbrook Court,
Cambridge
CB3 0NA

Tel: +44 (0) 1223276002
www.atkinsrealis.com

Copyright © AtkinsRéalis (2025)

Client

GREATER CAMBRIDGE PARTNERSHIP
Growing and sharing prosperity
Delivering our City Deal

Project Title
Melbourn Greenway Detailed Design

Drawing Title
**HIGHWAYS LAYOUT PLAN
MELBOURN (SCHEME 6)
(SHEET 3 OF 4)**

Scale	Designed / Drawn	Checked	Approved	Authorised
1:1000	DM	ANV	AC	---
Original Size	Date	Date	Date	Date
A1	17/02/25	17/02/25	17/02/25	---
Drawing Number	Project	Originator	Volume	Job No.
5228275	5228275	ATK HGN	MELB	5228275
DR	CH	000003	000003	Revision
Location	Type	Role	Number	P04

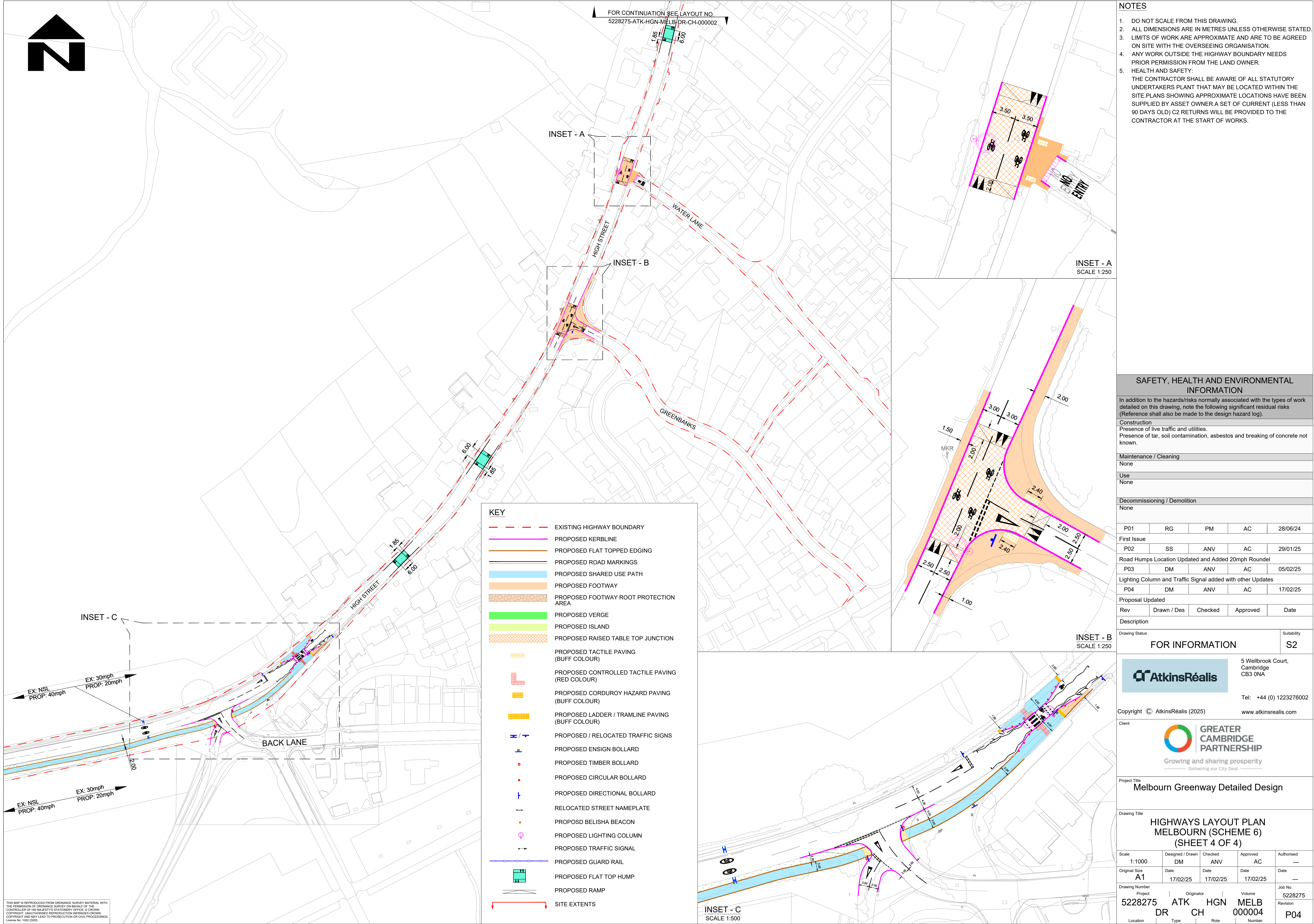

- NOTES
- DO NOT SCALE FROM THIS DRAWING.
 - ALL DIMENSIONS ARE IN METRES UNLESS OTHERWISE STATED.
 - LIMITS OF WORK ARE APPROXIMATE AND ARE TO BE AGREED ON SITE WITH THE OVERSEEING ORGANISATION.
 - ANY WORK OUTSIDE THE HIGHWAY BOUNDARY NEEDS PRIOR PERMISSION FROM THE LAND OWNER.
 - HEALTH AND SAFETY:
THE CONTRACTOR SHALL BE AWARE OF ALL STATUTORY UNDERTAKERS PLANT THAT MAY BE LOCATED WITHIN THE SITE. PLANS SHOWING APPROXIMATE LOCATIONS HAVE BEEN SUPPLIED BY ASSET OWNER. A SET OF CURRENT (LESS THAN 90 DAYS OLD) C2 RETURNS WILL BE PROVIDED TO THE CONTRACTOR AT THE START OF WORKS.

SAFETY, HEALTH AND ENVIRONMENTAL INFORMATION

In addition to the hazards/risks normally associated with the types of work detailed on this drawing, note the following significant residual risks (Reference shall also be made to the design hazard log).

Construction
Presence of live traffic and utilities.
Presence of tar, soil contamination, asbestos and breaking of concrete not known.

Maintenance / Cleaning
None

Use
None

Decommissioning / Demolition
None

P01	RG	PM	AC	28/06/24
-----	----	----	----	----------

First Issue

P02	SS	ANV	AC	29/01/25
-----	----	-----	----	----------

Road Humps Location Updated and Added 20mph Roundel

P03	DM	ANV	AC	05/02/25
-----	----	-----	----	----------

Lighting Column and Traffic Signal added with other Updates

P04	DM	ANV	AC	17/02/25
-----	----	-----	----	----------

Proposal Updated

Rev	Drawn / Des	Checked	Approved	Date
-----	-------------	---------	----------	------

Description

Drawing Status	Suitability
----------------	-------------

FOR INFORMATION S2

5 Wellbrook Court,
Cambridge
CB3 0NA

Tel: +44 (0) 1223276002

Copyright © AtkinsRéalis (2025) www.atkinsrealis.com

Client

GREATER
CAMBRIDGE
PARTNERSHIP
Growing and sharing prosperity
Delivering our City Deal

Project Title

Melbourn Greenway Detailed Design

Drawing Title

HIGHWAYS LAYOUT PLAN
MELBOURN (SCHEME 6)
(SHEET 4 OF 4)

Scale	Designed / Drawn	Checked	Approved	Authorised
1:1000	DM	ANV	AC	---
Original Size	Date	Date	Date	Date
A1	17/02/25	17/02/25	17/02/25	---
Drawing Number	Project	Originator	Volume	Job No.
5228275	DR	ATK HGN	MELB 000004	5228275
Location	Type	Role	Number	Revision
				P04

THIS MAP IS REPRODUCED FROM ORDNANCE SURVEY MATERIAL WITH THE PERMISSION OF ORDNANCE SURVEY ON BEHALF OF THE CONTROLLER OF HIS MAJESTY'S STATIONERY OFFICE. © CROWN COPYRIGHT. UNAUTHORISED REPRODUCTION INFRINGES CROWN COPYRIGHT AND MAY LEAD TO PROSECUTION OR CIVIL PROCEEDINGS. License No. 1000 23055