

- KEY**
- EXISTING HIGHWAY BOUNDARY
 - PROPOSED KERBLINE (BN3) (25mm UPSTAND)
 - PROPOSED FLAT TOPPED EDGING
 - PROPOSED CHANNEL BLOCK (FLUSH)
 - PROPOSED / RELOCATED TRAFFIC SIGNS
 - PROPOSED GLENWOOD 170 SIGNHEAD POST
 - PROPOSED GEOCELLULAR SOAKAWAY
 - PROPOSED INSPECTION OPENING
 - PROPOSED INSPECTION CHAMBER
 - PROPOSED CORDUROY HAZARD PAVING
 - PROPOSED CYCLE STAND
 - PROPOSED FIELD GATE
 - PROPOSED LIGHTING COLUMN
 - PROPOSED FENCE (HALF ROUND POST AT 1.8m CENTRES WITH THREE SAWN TIMBER RAILS, SHW STANDARD DETAIL H15)
 - PROPOSED SHARED USE PATH
 - PROPOSED FOOTWAY
 - PROPOSED VERGE/DRAINAGE (DETAIL IN ABEYANCE PENDING LLFA ACCEPTANCE)
 - REINFORCED CONSTRUCTION VEHICLE CROSSING POINT
 - FILTER DRAIN WITH WIDTH 450MM ALONG THE EDGE OF GREEN STRIP
 - SITE EXTENTS

- NOTES**
- DO NOT SCALE FROM THIS DRAWING.
 - ALL DIMENSIONS ARE IN METRES UNLESS OTHERWISE STATED.
 - LIMITS OF WORK ARE APPROXIMATE AND ARE TO BE AGREED ON SITE WITH THE OVERSEEING ORGANISATION.
 - ANY WORK OUTSIDE THE HIGHWAY BOUNDARY NEEDS PRIOR PERMISSION FROM THE LAND OWNER.
 - HEALTH AND SAFETY: THE CONTRACTOR SHALL BE AWARE OF ALL STATUTORY UNDERTAKERS PLANT THAT MAY BE LOCATED WITHIN THE SITE. PLANS SHOWING APPROXIMATE LOCATIONS HAVE BEEN SUPPLIED BY ASSET OWNER. A SET OF CURRENT (LESS THAN 90 DAYS OLD) C2 RETURNS WILL BE PROVIDED TO THE CONTRACTOR AT THE START OF WORKS.
 - FOR SITE CLEARANCE DETAILS, REFER TO DRAWING NO. 5223864-ATK-HSC-MELB-DR-CH-000001 & 000002.
 - FOR KERBS, FOOTWAYS AND PAVEMENT DETAILS, REFER DRAWING NO. 5223864-ATK-HPV-MELB-DR-CH-000001 & 000002.
 - FOR TRAFFIC SIGNS DETAILS, REFER DRAWING NO. 5223864-ATK-HSN-MELB-DR-CH-000001 TO 000002.
 - FOR STANDARD DETAILS, REFER DRAWING NO. 5223864-ATK-HGN-XX-DR-CH-000002 TO 000004.
 - FOR DRAINAGE DETAILS, REFER DRAWING NO. 5223864-ATK-HDG-MELB-DR-CD-000001 TO 000002.
 - FOR LIGHTING DETAILS, REFER DRAWING NO. 5223864-ATK-HLG-MELB-DR-EO-000001 TO 000002.
 - FILTER STRIP TO HAVE TYPE 3 ENGINEERED SOIL OR LIGHTLY UNCOMPACTED SOIL AT 300mm WITH 150mm TOP SOIL.
 - TWO FIELD GATES TO BE 4.88m WIDE EACH, WITH 0.12m D LOOP WELDED TO ENDS TO PROVIDE 10m CLEAR WIDTH BETWEEN GATE POSTS TO BE MANUFACTURED TO OPEN ONLY AWAY FROM PROPOSED PATH AND INTO FIELD.

SAFETY, HEALTH AND ENVIRONMENTAL INFORMATION

In addition to the hazards/risks normally associated with the types of work detailed on this drawing, note the following significant residual risks (Reference shall also be made to the design hazard log).

Construction
Live traffic & utilities.
Presence of soil contamination, tar, asbestos and breaking of concrete not known.

Maintenance / Cleaning
None

Use
None

Decommissioning / Demolition
None

P03	RJ	ANV	AC	14/12/23
-----	----	-----	----	----------

For Legal agreement	P04	PM	ANV	AC	12/02/24
---------------------	-----	----	-----	----	----------

For Technical review	P05	RG	PM	AC	18/03/24
----------------------	-----	----	----	----	----------

Updates as per GCP comments	C01	RG	PM	AC	24/06/24
-----------------------------	-----	----	----	----	----------

For Construction Issue

Rev	Drawn / Des	Checked	Approved	Date
-----	-------------	---------	----------	------

Description

Drawing Status	Suitability
APPROVED - PUBLISHED	A1

	5 Wellbrook Court, Cambridge CB3 0NA Tel: +44 (0) 1223276002 www.atkinsrealis.com
--	---

Copyright © AtkinsRéalis (2024)

Client

GREATER CAMBRIDGE PARTNERSHIP
Growing and sharing prosperity
Delivering our City Deal

Project Title

GCP Early Works - Detailed Design

Drawing Title

GENERAL ARRANGEMENT
MELDRETH STATION (SCHEME 6A)
(SHEET 1 OF 2)

Scale	Designed / Drawn	Checked	Approved	Authorised
1:500	RG	PM	AC	RH
Original Size	Date	Date	Date	Date
A1	24/06/24	24/06/24	24/06/24	24/06/24
Drawing Number	Project	Originator	Volume	Job No.
5223864	MELB	ATK	HGN	5223864
	DR	CH	000001	Revision
				C01

THIS MAP IS REPRODUCED FROM ORDNANCE SURVEY MATERIAL WITH THE PERMISSION OF ORDNANCE SURVEY ON BEHALF OF THE CONTROLLER OF HIS MAJESTY'S STATIONERY OFFICE. © CROWN COPYRIGHT. UNAUTHORISED REPRODUCTION INFRINGES CROWN COPYRIGHT AND MAY LEAD TO PROSECUTION OR CIVIL PROCEEDINGS. License No. 1000 23055

CAD FILE: C:\projectwise\atkins_transportation_uk\0396925\5223864-ATK-HGN-MELB-DR-CH-000001.dwg

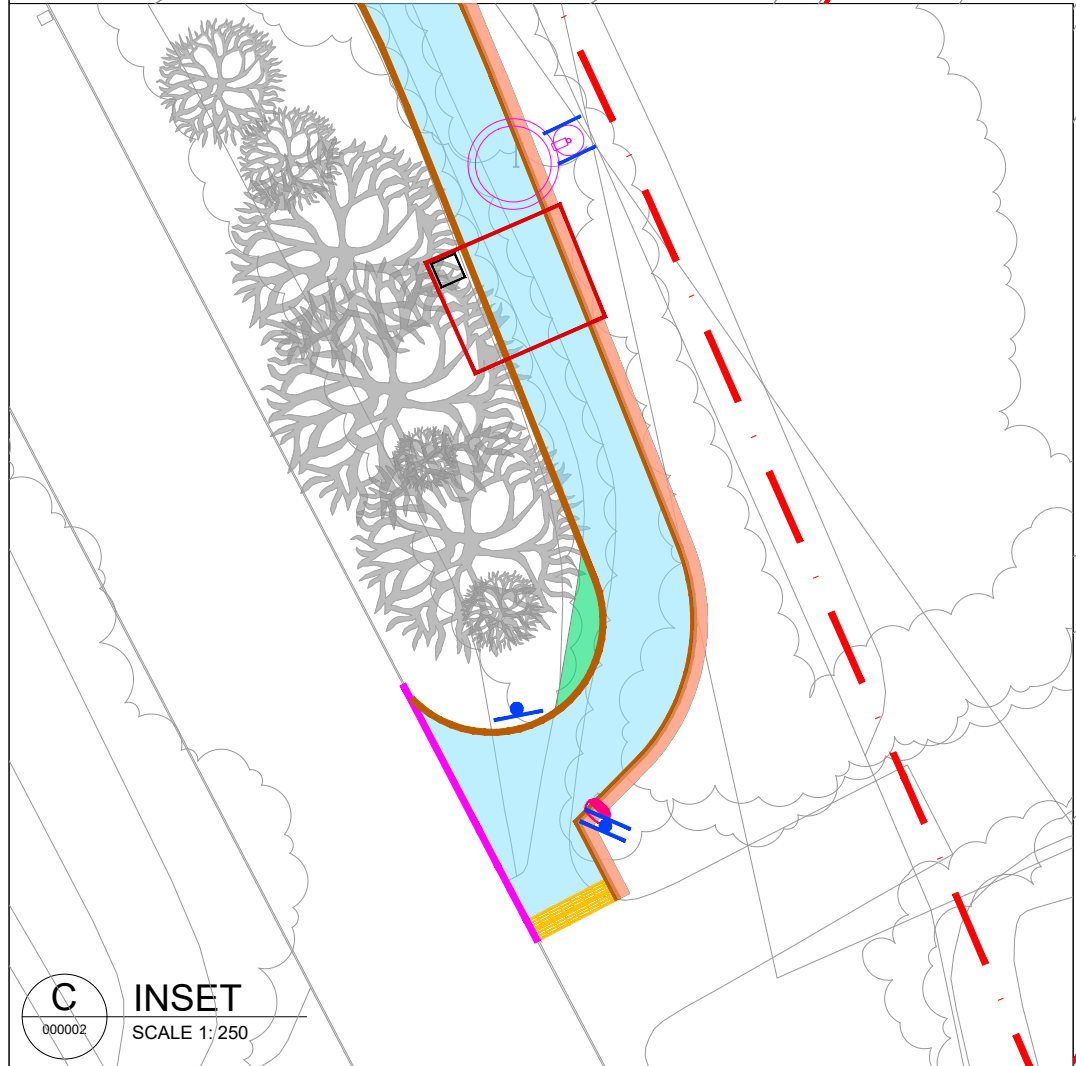
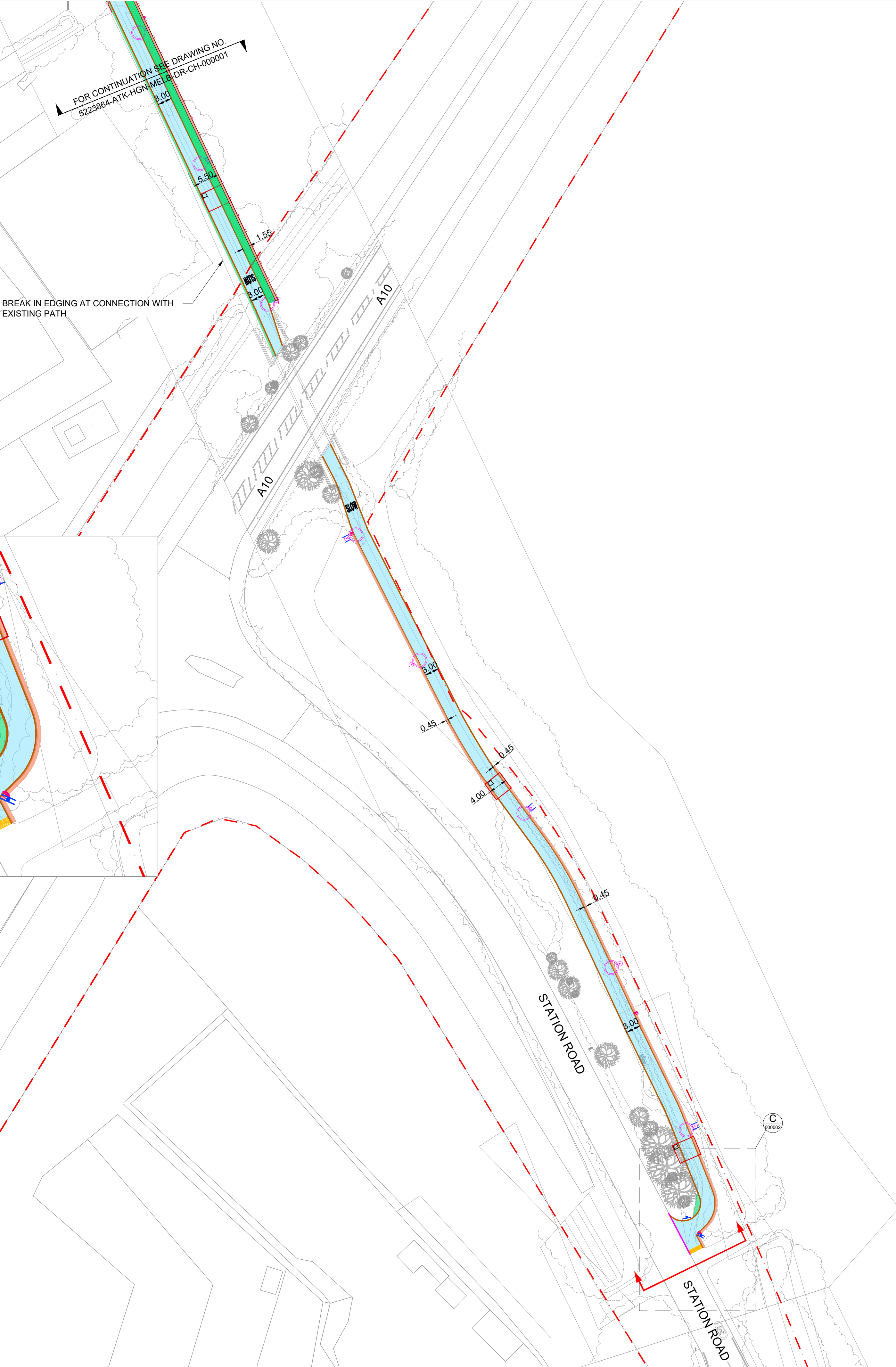
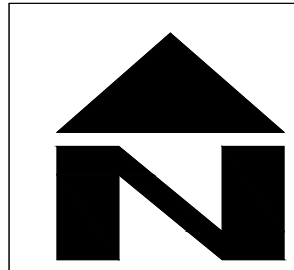

THIS MAP IS REPRODUCED FROM ORDNANCE SURVEY MATERIAL WITH THE PERMISSION OF ORDNANCE SURVEY ON BEHALF OF THE CONTROLLER OF HIS MAJESTY'S STATIONERY OFFICE. © CROWN COPYRIGHT. UNAUTHORISED REPRODUCTION INFRINGES CROWN COPYRIGHT AND MAY LEAD TO PROSECUTION OR CIVIL PROCEEDINGS. License No. 1000 23055

CAD FILE: C:\projectwise\atkins_transportation_uk\0396925\5223864-ATK-HGN-MELB-DR-CH-000002.dwg

KEY	
	EXISTING HIGHWAY BOUNDARY
	PROPOSED KERBLINE (BN3) (25mm UPSTAND)
	PROPOSED FLAT TOPPED EDGING
	PROPOSED CHANNEL BLOCK (FLUSH)
	PROPOSED / RELOCATED TRAFFIC SIGNS
	PROPOSED GLENWOOD 170 SIGNHEAD POST
	PROPOSED GEOCELLULAR SOAKAWAY
	PROPOSED INSPECTION OPENING
	PROPOSED INSPECTION CHAMBER
	PROPOSED CORDUROY HAZARD PAVING
	PROPOSED CYCLE STAND
	PROPOSED FIELD GATE
	PROPOSED LIGHTING COLUMN
	PROPOSED FENCE (HALF ROUND POST AT 1.8m CENTRES WITH THREE SAWN TIMBER RAILS, SHW STANDARD DETAIL H15)
	PROPOSED SHARED USE PATH
	PROPOSED FOOTWAY
	PROPOSED VERGE/DRAINAGE (DETAIL IN ABEYANCE PENDING LLFA ACCEPTANCE)
	REINFORCED CONSTRUCTION VEHICLE CROSSING POINT
	FILTER DRAIN WITH WIDTH 450MM ALONG THE EDGE OF GREEN STRIP
	SITE EXTENTS

- NOTES**
- DO NOT SCALE FROM THIS DRAWING.
 - ALL DIMENSIONS ARE IN METRES UNLESS OTHERWISE STATED.
 - LIMITS OF WORK ARE APPROXIMATE AND ARE TO BE AGREED ON SITE WITH THE OVERSEEING ORGANISATION.
 - ANY WORK OUTSIDE THE HIGHWAY BOUNDARY NEEDS PRIOR PERMISSION FROM THE LAND OWNER.
 - HEALTH AND SAFETY: THE CONTRACTOR SHALL BE AWARE OF ALL STATUTORY UNDERTAKERS PLANT THAT MAY BE LOCATED WITHIN THE SITE. PLANS SHOWING APPROXIMATE LOCATIONS HAVE BEEN SUPPLIED BY ASSET OWNER. A SET OF CURRENT (LESS THAN 90 DAYS OLD) C2 RETURNS WILL BE PROVIDED TO THE CONTRACTOR AT THE START OF WORKS.
 - FOR SITE CLEARANCE DETAILS, REFER TO DRAWING NO. 5223864-ATK-HSC-MELB-DR-CH-000001 & 000002.
 - FOR KERBS, FOOTWAYS AND PAVEMENT DETAILS, REFER DRAWING NO. 5223864-ATK-HPV-MELB-DR-CH-000001 & 000002.
 - FOR TRAFFIC SIGNS DETAILS, REFER DRAWING NO. 5223864-ATK-HSN-MELB-DR-CH-000001 TO 000002.
 - FOR STANDARD DETAILS, REFER DRAWING NO. 5223864-ATK-HGN-XX-DR-CH-000002 TO 000004.
 - FOR DRAINAGE DETAILS, REFER DRAWING NO. 5223864-ATK-HDG-MELB-DR-CD-000001 TO 000002.
 - FOR LIGHTING DETAILS, REFER DRAWING NO. 5223864-ATK-HLG-MELB-DR-EO-000001 TO 000002.
 - FILTER STRIP TO HAVE TYPE 3 ENGINEERED SOIL OR LIGHTLY UNCOMPACTED SOIL AT 300mm WITH 150mm TOP SOIL.
 - TWO FIELD GATES TO BE 4.88m WIDE EACH, WITH 0.12m D LOOP WELDED TO ENDS TO PROVIDE 10m CLEAR WIDTH BETWEEN GATE POSTS TO BE MANUFACTURED TO OPEN ONLY AWAY FROM PROPOSED PATH AND INTO FIELD.

SAFETY, HEALTH AND ENVIRONMENTAL INFORMATION

In addition to the hazards/risks normally associated with the types of work detailed on this drawing, note the following significant residual risks (Reference shall also be made to the design hazard log).

Construction
Live traffic & utilities.
Presence of soil contamination, tar, asbestos and breaking of concrete not known.

Maintenance / Cleaning
None

Use
None

Decommissioning / Demolition
None

P03	RJ	ANV	AC	14/12/23
-----	----	-----	----	----------

P04	PM	ANV	AC	12/02/24
-----	----	-----	----	----------

P05	RG	PM	AC	18/03/24
-----	----	----	----	----------

C01	RG	PM	AC	24/06/24
-----	----	----	----	----------

Rev	Drawn / Des	Checked	Approved	Date
-----	-------------	---------	----------	------

Description

Drawing Status	Suitability
APPROVED - PUBLISHED	A1



Tel: +44 (0) 1223276002

Copyright © AtkinsRéalis (2024) www.atkinsrealis.com

Client



Project Title
GCP Early Works - Detailed Design

GENERAL ARRANGEMENT MELDRETH STATION (SCHEME 6A) (SHEET 2 OF 2)

Scale	Designed / Drawn	Checked	Approved	Authorised
1:500	RG	PM	AC	RH
Original Size	Date	Date	Date	Date
A1	24/06/24	24/06/24	24/06/24	24/06/24
Drawing Number	Project	Originator	Volume	Job No.
5223864	MELB	ATK	HGN	5223864
	DR	CH	000002	
	Location	Type	Role	Number
				C01