

**KEY**

- EXISTING HIGHWAY BOUNDARY
- PROPOSED KERBLINE
- PROPOSED DUTCH KERB
- PROPOSED FLAT TOPPED EDGING
- EXISTING VERGE TO RETAIN
- PROPOSED VERGE
- PROPOSED FOOTWAY CONSTRUCTION
- PROPOSED ISLAND
- PROPOSED COLDRAY MMA SURFACING
- PROPOSED RAISED TABLE / FLAT TOP HUMPS
- PROPOSED RED SURFACING
- PROPOSED TACTILE PAVING (BUFF COLOUR)
- PROPOSED / RELOCATED TRAFFIC SIGNS
- RELOCATED ROAD NAME PLATE
- PROPOSED CIRCULAR BOLLARD
- PROPOSED GULLY
- PROPOSED LIGHTING COLUMN
- PROPOSED SINUSOIDAL ROAD HUMPS
- PROPOSED RAMP
- SITE EXTENTS

- NOTES**
- DO NOT SCALE FROM THIS DRAWING.
  - ALL DIMENSIONS ARE IN METRES UNLESS OTHERWISE STATED.
  - LIMITS OF WORK ARE APPROXIMATE AND ARE TO BE AGREED ON SITE WITH THE OVERSEEING ORGANISATION.
  - ANY WORK OUTSIDE THE HIGHWAY BOUNDARY NEEDS PRIOR PERMISSION FROM THE LAND OWNER.
  - HEALTH AND SAFETY:  
THE CONTRACTOR SHALL BE AWARE OF ALL STATUTORY UNDERTAKERS PLANT THAT MAY BE LOCATED WITHIN THE SITE. PLANS SHOWING APPROXIMATE LOCATIONS HAVE BEEN SUPPLIED BY ASSET OWNER. A SET OF CURRENT (LESS THAN 90 DAYS OLD) C2 RETURNS WILL BE PROVIDED TO THE CONTRACTOR AT THE START OF WORKS.
  - FOR SITE CLEARANCE DETAILS, REFER TO DRAWING NO. 5223864-ATK-HSC-FOXT-DR-CH-000001 TO 000005.
  - FOR KERB FOOTWAY AND PAVEMENT DETAILS, REFER DRAWING NO. 5223864-ATK-HPV-FOXT-DR-CH-000001 TO 000005.
  - FOR STANDARD DETAILS, REFER DRAWING NO. 5223864-ATK-HGN-XX-DR-CH-000002 TO 000004.
  - FOR TRAFFIC SIGNS DETAILS, REFER DRAWING NO. 5223864-ATK-HSN-FOXT-DR-CH-000001 TO 000005.
  - FOR ROAD MARKINGS DETAILS, REFER DRAWING NO. 5223864-ATK-HMK-FOXT-DR-CH-000001 TO 000005.
  - FOR LIGHTING DETAILS, REFER DRAWING NO. 5223864-ATK-HLG-FOXT-DR-EO-000001 TO 000006.
  - IN THE ABSENCE OF INFORMATION COVERING THE EXISTING DRAINAGE, THE DRAINAGE DESIGN IS BASED ON THE ASSUMPTION THAT THE AREAS EFFECTED BY THE MELBOURNE GREENWAY IN FOXTON DRAIN TO SOAKAWAY AND THAT THE PERFORMANCE OF THE SOAKAWAY IS ADEQUATE FOR THE EXISTING CONNECTED AREAS AND ANY FUTURE IMPERMEABLE CATCHMENT AREA. THE CONTRACTOR IS TO INVESTIGATE THE DRAINAGE ON SITE TO ESTABLISH THE PRESENCE OF DRAINAGE FEATURES AND, WHERE THERE ARE SOAKAWAYS, TO VERIFY THEIR PERFORMANCE BY SUITABLE SITE TESTS.
  - WHERE FOOTWAYS OR ROADS DRAIN TO A GREEN STRIP, THE PROFILE OF THE GREEN STRIP SHALL BE GIVEN A FLAT BASE PROFILE WITH 1 IN 3 SIDE SLOPES AND A MINIMUM DEPTH OF 200mm EXCEPT WHERE SERVICES DO NOT ALLOW THIS. WHERE SERVICES OBSTRUCT, THE DESIGNER'S INSTRUCTION MUST BE SOUGHT.

**SAFETY, HEALTH AND ENVIRONMENTAL INFORMATION**

In addition to the hazards/risks normally associated with the types of work detailed on this drawing, note the following significant residual risks (Reference shall also be made to the design hazard log).

**Construction**  
Live traffic & utilities.  
Presence of soil contamination, tar, asbestos and breaking of concrete not known.

**Maintenance / Cleaning**  
None

**Use**  
None

**Decommissioning / Demolition**  
None

P01	RJ	ANV	AC	06/09/23
Issued for pricing				
P02	RJ	ANV	AC	03/11/23
For Technical Review				
P03	RJ	PM	AC	19/12/23
RSA 2 comment updated				

Rev	Drawn / Des	Checked	Approved	Date
Description				

Drawing Status	Suitability
<b>FOR REVIEW / COMMENT</b>	<b>S3</b>

**ATKINS** 5 Wellbrook Court, Cambridge CB3 0NA

Member of the SNC-Lavalin Group Tel: +44 (0) 1223276002

Copyright © Atkins Limited (2023) www.atkinsglobal.com



Project Title: **GCP Early Works - Detailed Design**

Drawing Title: **GENERAL ARRANGEMENT FOXTON (SCHEME 4) (SHEET 1 OF 5)**

Scale	Designed / Drawn	Checked	Approved	Authorised
1:500	RJ	PM	AC	---
Original Size	Date	Date	Date	Date
A1	19/12/23	19/12/23	19/12/23	---

Drawing Number	Project	Originator	Volume	Job No.
5223864	5223864	ATK	HGN	5223864
FOXT	DR	CH	000001	Revision
Location	Type	Role	Number	P03



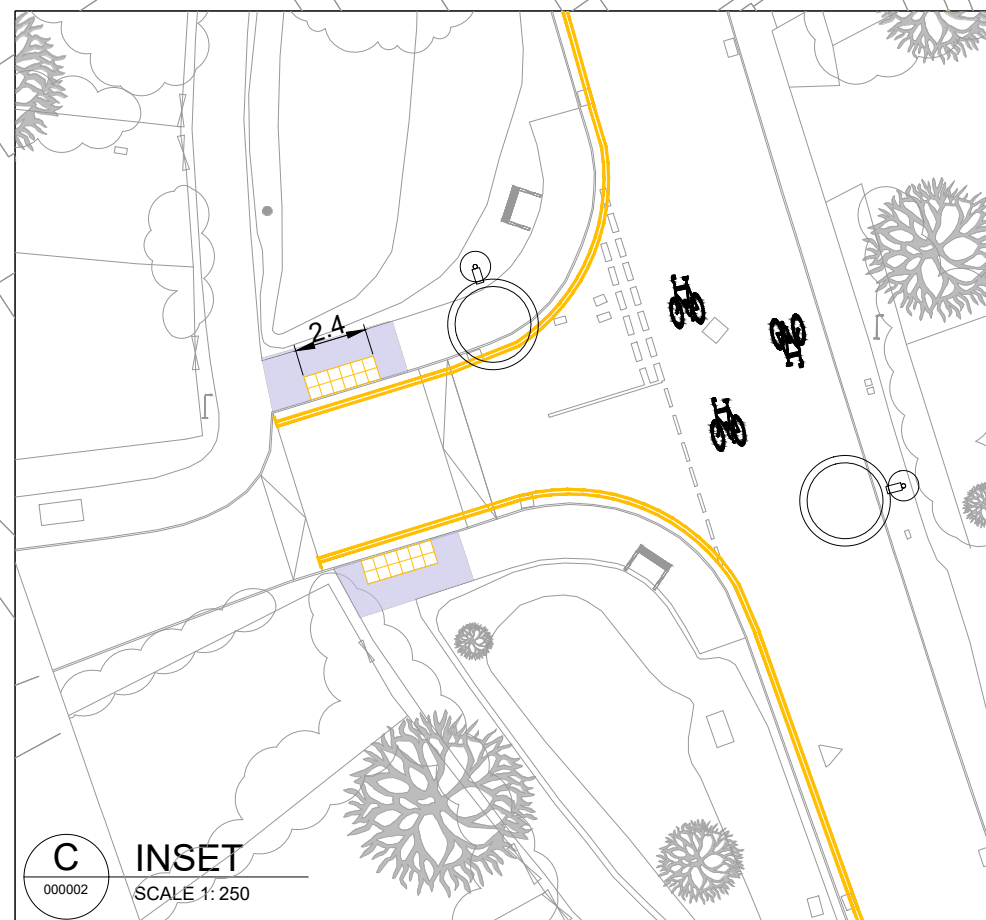
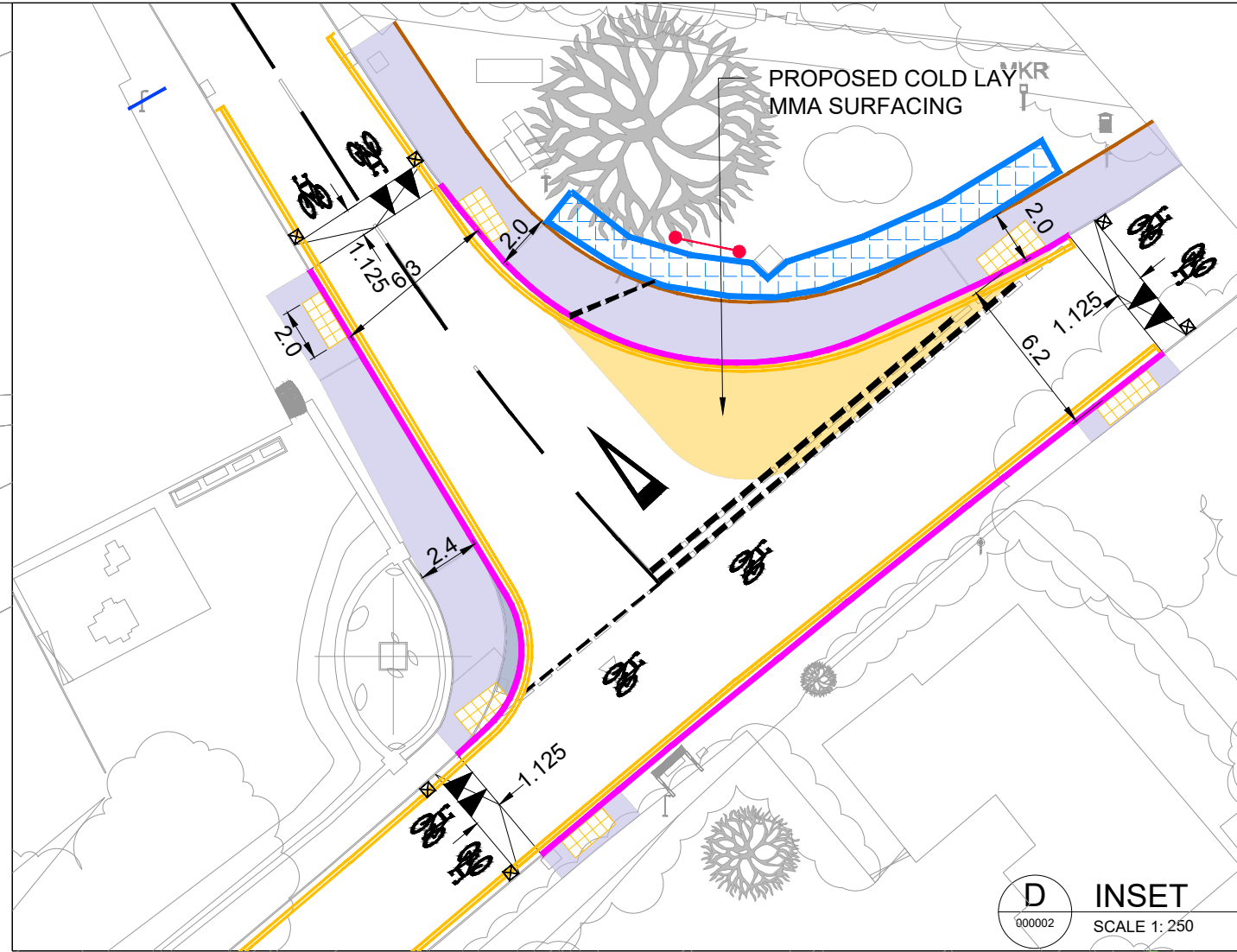
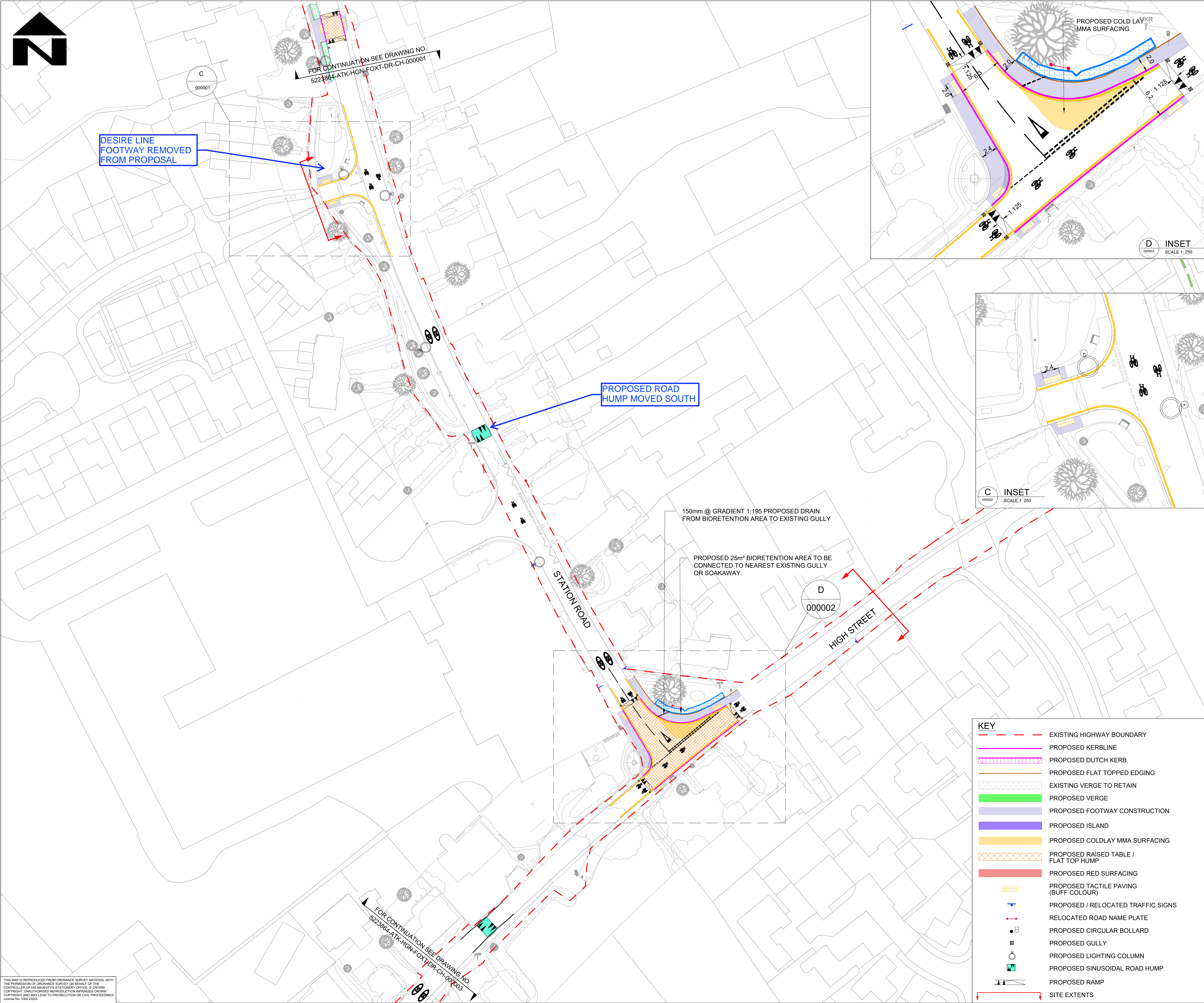

- NOTES**
- DO NOT SCALE FROM THIS DRAWING.
  - ALL DIMENSIONS ARE IN METRES UNLESS OTHERWISE STATED.
  - LIMITS OF WORK ARE APPROXIMATE AND ARE TO BE AGREED ON SITE WITH THE OVERSEEING ORGANISATION.
  - ANY WORK OUTSIDE THE HIGHWAY BOUNDARY NEEDS PRIOR PERMISSION FROM THE LAND OWNER.
  - HEALTH AND SAFETY: THE CONTRACTOR SHALL BE AWARE OF ALL STATUTORY UNDERTAKERS PLANT THAT MAY BE LOCATED WITHIN THE SITE. PLANS SHOWING APPROXIMATE LOCATIONS HAVE BEEN SUPPLIED BY ASSET OWNER. A SET OF CURRENT (LESS THAN 90 DAYS OLD) C2 RETURNS WILL BE PROVIDED TO THE CONTRACTOR AT THE START OF WORKS.
  - FOR SITE CLEARANCE DETAILS, REFER TO DRAWING NO. 5223864-ATK-HSC-FOXT-DR-CH-000001 TO 000005.
  - FOR KERB FOOTWAY AND PAVEMENT DETAILS, REFER DRAWING NO. 5223864-ATK-HPV-FOXT-DR-CH-000001 TO 000005.
  - FOR STANDARD DETAILS, REFER DRAWING NO. 5223864-ATK-HGN-XX-DR-CH-000002 TO 000004.
  - FOR TRAFFIC SIGNS DETAILS, REFER DRAWING NO. 5223864-ATK-HSN-FOXT-DR-CH-000001 TO 000005.
  - FOR ROAD MARKINGS DETAILS, REFER DRAWING NO. 5223864-ATK-HMK-FOXT-DR-CH-000001 TO 000005.
  - FOR LIGHTING DETAILS, REFER DRAWING NO. 5223864-ATK-HLG-FOXT-DR-EO-000001 TO 000006.
  - IN THE ABSENCE OF INFORMATION COVERING THE EXISTING DRAINAGE, THE DRAINAGE DESIGN IS BASED ON THE ASSUMPTION THAT THE AREAS EFFECTED BY THE MELBOURN GREENWAY IN FOXTON DRAIN TO SOAKAWAY AND THAT THE PERFORMANCE OF THE SOAKAWAY IS ADEQUATE FOR THE EXISTING CONNECTED AREAS AND ANY FUTURE IMPERMEABLE CATCHMENT AREA. THE CONTRACTOR IS TO INVESTIGATE THE DRAINAGE ON SITE TO ESTABLISH THE PRESENCE OF DRAINAGE FEATURES AND, WHERE THERE ARE SOAKAWAYS, TO VERIFY THEIR PERFORMANCE BY SUITABLE SITE TESTS.
  - WHERE FOOTWAYS OR ROADS DRAIN TO A GREEN STRIP, THE PROFILE OF THE GREEN STRIP SHALL BE GIVEN A FLAT BASE PROFILE WITH 1 IN 3 SIDE SLOPES AND A MINIMUM DEPTH OF 200mm EXCEPT WHERE SERVICES DO NOT ALLOW THIS. WHERE SERVICES OBSTRUCT, THE DESIGNER'S INSTRUCTION MUST BE SOUGHT.

**SAFETY, HEALTH AND ENVIRONMENTAL INFORMATION**

In addition to the hazards/risks normally associated with the types of work detailed on this drawing, note the following significant residual risks (Reference shall also be made to the design hazard log).

**Construction**  
Live traffic & utilities.  
Presence of soil contamination, tar, asbestos and breaking of concrete not known.

**Maintenance / Cleaning**  
None

**Use**  
None

**Decommissioning / Demolition**  
None

P01	RJ	ANV	AC	06/09/23
-----	----	-----	----	----------

Issued for pricing

P02	RJ	ANV	AC	03/11/23
-----	----	-----	----	----------

For Technical Review

P03	RJ	ANV	AC	19/12/23
-----	----	-----	----	----------

RSA 2 comment updated

P04	RM	AW	AW	31/01/24
-----	----	----	----	----------

Road hump on Station Road moved south

Rev	Drawn / Des	Checked	Approved	Date
Description				

Drawing Status	Suitability
FOR INFORMATION	S2

**ATKINS**  
5 Wellbrook Court,  
Cambridge  
CB3 0NA

Member of the SNC-Lavalin Group  
Tel: +44 (0) 1223276002

Copyright © Atkins Limited (2023) www.atkinsglobal.com



Project Title  
**GCP Early Works - Detailed Design**

Drawing Title  
**GENERAL ARRANGEMENT  
FOXTON (SCHEME 4)  
(SHEET 2 OF 5)**

Scale	Designed / Drawn	Checked	Approved	Authorised
1:500	RJ	PM	AC	---
Original Size	Date	Date	Date	Date
A1	19/12/23	19/12/23	19/12/23	---

Project	Originator	Volume	Job No.
5223864	ATK	HGN	5223864
Location	Type	Role	Number
FOXT	DR	CH	000002
			Revision
			P04

**KEY**

- EXISTING HIGHWAY BOUNDARY
- PROPOSED KERBLINE
- PROPOSED DUTCH KERB
- PROPOSED FLAT TOPPED EDGING
- EXISTING VERGE TO RETAIN
- PROPOSED VERGE
- PROPOSED FOOTWAY CONSTRUCTION
- PROPOSED ISLAND
- PROPOSED COLDLAY MMA SURFACING
- PROPOSED RAISED TABLE / FLAT TOP HUMP
- PROPOSED RED SURFACING
- PROPOSED TACTILE PAVING (BUFF COLOUR)
- PROPOSED / RELOCATED TRAFFIC SIGNS
- RELOCATED ROAD NAME PLATE
- PROPOSED CIRCULAR BOLLARD
- PROPOSED GULLY
- PROPOSED LIGHTING COLUMN
- PROPOSED SINUSOIDAL ROAD HUMP
- PROPOSED RAMP
- SITE EXTENTS

THIS MAP IS REPRODUCED FROM ORDINANCE SURVEY MATERIAL WITH THE PERMISSION OF ORDINANCE SURVEY ON BEHALF OF THE CONTROLLER OF HIS MAJESTY'S STATIONERY OFFICE. © CROWN COPYRIGHT. UNAUTHORISED REPRODUCTION INFRINGES CROWN COPYRIGHT AND MAY LEAD TO PROSECUTION OR CIVIL PROCEEDINGS. License No. 1000 23056



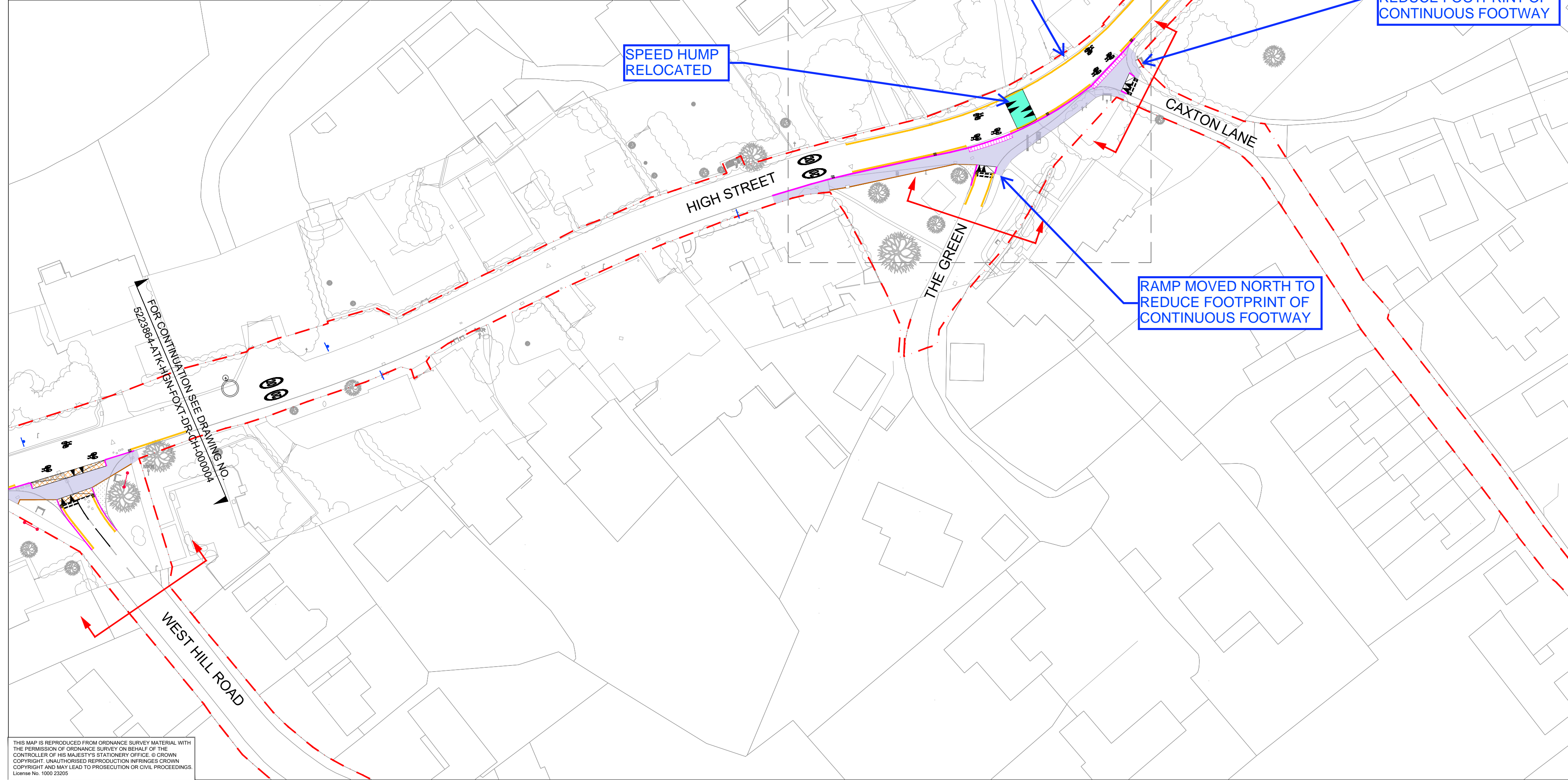
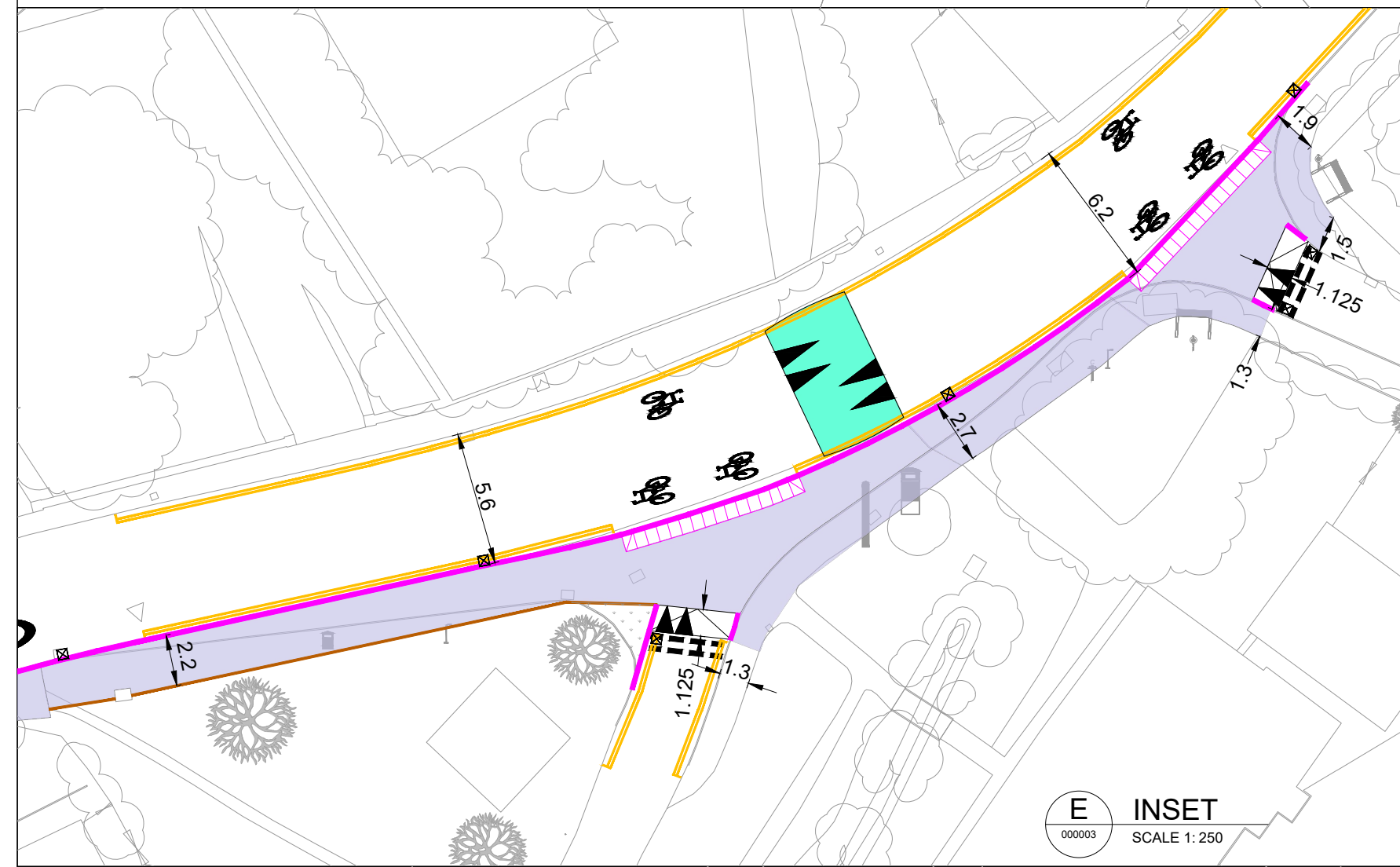
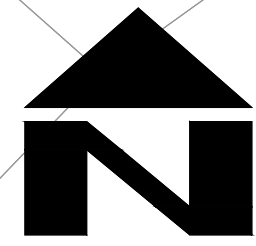

- NOTES**
- DO NOT SCALE FROM THIS DRAWING.
  - ALL DIMENSIONS ARE IN METRES UNLESS OTHERWISE STATED.
  - LIMITS OF WORK ARE APPROXIMATE AND ARE TO BE AGREED ON SITE WITH THE OVERSEEING ORGANISATION.
  - ANY WORK OUTSIDE THE HIGHWAY BOUNDARY NEEDS PRIOR PERMISSION FROM THE LAND OWNER.
  - HEALTH AND SAFETY:  
THE CONTRACTOR SHALL BE AWARE OF ALL STATUTORY UNDERTAKERS PLANT THAT MAY BE LOCATED WITHIN THE SITE. PLANS SHOWING APPROXIMATE LOCATIONS HAVE BEEN SUPPLIED BY ASSET OWNER. A SET OF CURRENT (LESS THAN 90 DAYS OLD) C2 RETURNS WILL BE PROVIDED TO THE CONTRACTOR AT THE START OF WORKS.
  - FOR SITE CLEARANCE DETAILS, REFER TO DRAWING NO. 5223864-ATK-HSC-FOXT-DR-CH-000001 TO 000005.
  - FOR KERB FOOTWAY AND PAVEMENT DETAILS, REFER DRAWING NO. 5223864-ATK-HPV-FOXT-DR-CH-000001 TO 000005.
  - FOR STANDARD DETAILS, REFER DRAWING NO. 5223864-ATK-HGN-XX-DR-CH-000002 TO 000004.
  - FOR TRAFFIC SIGNS DETAILS, REFER DRAWING NO. 5223864-ATK-HSN-FOXT-DR-CH-000001 TO 000005.
  - FOR ROAD MARKINGS DETAILS, REFER DRAWING NO. 5223864-ATK-HMK-FOXT-DR-CH-000001 TO 000005.
  - FOR LIGHTING DETAILS, REFER DRAWING NO. 5223864-ATK-HLG-FOXT-DR-EO-000001 TO 000006.
  - IN THE ABSENCE OF INFORMATION COVERING THE EXISTING DRAINAGE, THE DRAINAGE DESIGN IS BASED ON THE ASSUMPTION THAT THE AREAS EFFECTED BY THE MELBOURN GREENWAY IN FOXTON DRAIN TO SOAKAWAY AND THAT THE PERFORMANCE OF THE SOAKAWAY IS ADEQUATE FOR THE EXISTING CONNECTED AREAS AND ANY FUTURE IMPERMEABLE CATCHMENT AREA. THE CONTRACTOR IS TO INVESTIGATE THE DRAINAGE ON SITE TO ESTABLISH THE PRESENCE OF DRAINAGE FEATURES AND, WHERE THERE ARE SOAKAWAYS, TO VERIFY THEIR PERFORMANCE BY SUITABLE SITE TESTS.
  - WHERE FOOTWAYS OR ROADS DRAIN TO A GREEN STRIP, THE PROFILE OF THE GREEN STRIP SHALL BE GIVEN A FLAT BASE PROFILE WITH 1 IN 3 SIDE SLOPES AND A MINIMUM DEPTH OF 200mm EXCEPT WHERE SERVICES DO NOT ALLOW THIS. WHERE SERVICES OBSTRUCT, THE DESIGNER'S INSTRUCTION MUST BE SOUGHT.

**SAFETY, HEALTH AND ENVIRONMENTAL INFORMATION**

In addition to the hazards/risks normally associated with the types of work detailed on this drawing, note the following significant residual risks (Reference shall also be made to the design hazard log).

**Construction**  
Live traffic & utilities.  
Presence of soil contamination, tar, asbestos and breaking of concrete not known.

**Maintenance / Cleaning**  
None

**Use**  
None

**Decommissioning / Demolition**  
None

P02	RJ	ANV	AC	03/11/23
-----	----	-----	----	----------

For Technical Review

P03	RJ	ANV	AC	19/12/23
-----	----	-----	----	----------

RSA 2 comment updated

P04	RM	AW	AW	31/01/24
-----	----	----	----	----------

West Hill Road junction updated in line with GCP comments

P05	RM	AW	AW	20/02/24
-----	----	----	----	----------

Priority narrowing replaced and additional double yellow lines.

Rev	Drawn / Des	Checked	Approved	Date

Description

Drawing Status	Suitability
FOR INFORMATION	S2

**ATKINS** 5 Wellbrook Court, Cambridge CB3 0NA

Member of the SNC-Lavalin Group Tel: +44 (0) 1223276002

Copyright © Atkins Limited (2023) www.atkinsglobal.com



Project Title: GCP Early Works - Detailed Design

Drawing Title: GENERAL ARRANGEMENT FOXTON (SCHEME 4) (SHEET 3 OF 5)

Scale	Designed / Drawn	Checked	Approved	Authorised
1:500	RJ	PM	AC	---
Original Size	Date	Date	Date	Date
A1	19/12/23	19/12/23	19/12/23	---
Drawing Number	Project	Originator	Volume	Job No.
5223864	FOXT	ATK	HGN	5223864
	DR	CH	000003	Revision
				P05

- KEY**
- EXISTING HIGHWAY BOUNDARY
  - PROPOSED KERBLINE
  - PROPOSED DUTCH KERB
  - PROPOSED FLAT TOPPED EDGING
  - EXISTING VERGE TO RETAIN
  - PROPOSED VERGE
  - PROPOSED FOOTWAY CONSTRUCTION
  - PROPOSED ISLAND
  - PROPOSED COLDRAY MMA SURFACING
  - PROPOSED RAISED TABLE / FLAT TOP HUMPS
  - PROPOSED RED SURFACING
  - PROPOSED TACTILE PAVING (BUFF COLOUR)
  - PROPOSED / RELOCATED TRAFFIC SIGNS
  - RELOCATED ROAD NAME PLATE
  - PROPOSED CIRCULAR BOLLARD
  - PROPOSED GULLY
  - PROPOSED LIGHTING COLUMN
  - PROPOSED SINUSOIDAL ROAD HUMPS
  - PROPOSED RAMP
  - SITE EXTENTS

THIS MAP IS REPRODUCED FROM ORDNANCE SURVEY MATERIAL WITH THE PERMISSION OF ORDNANCE SURVEY ON BEHALF OF THE CONTROLLER OF HER MAJESTY'S STATIONERY OFFICE. © CROWN COPYRIGHT. UNAUTHORISED REPRODUCTION INFRINGES CROWN COPYRIGHT AND MAY LEAD TO PROSECUTION OR CIVIL PROCEEDINGS. License No. 1000 23056



