

NOTES

- DO NOT SCALE FROM THIS DRAWING.
- ALL DIMENSIONS ARE IN METRES UNLESS OTHERWISE STATED.
- LIMITS OF WORK ARE APPROXIMATE AND ARE TO BE AGREED ON SITE WITH THE OVERSEEING ORGANISATION.
- ANY WORK OUTSIDE THE HIGHWAY BOUNDARY NEEDS PRIOR PERMISSION FROM THE LAND OWNER.
- HEALTH AND SAFETY:
THE CONTRACTOR SHALL BE AWARE OF ALL STATUTORY UNDERTAKERS PLANT THAT MAY BE LOCATED WITHIN THE SITE. PLANS SHOWING APPROXIMATE LOCATIONS HAVE BEEN SUPPLIED BY ASSET OWNER. A SET OF CURRENT (LESS THAN 90 DAYS OLD) C2 RETURNS WILL BE PROVIDED TO THE CONTRACTOR AT THE START OF WORKS.
- FOR SITE CLEARANCE DETAILS, REFER TO DRAWING NO. 5223864-ATK-HSC-COWL-DR-CH-000001 TO 000003.
- FOR DRAINAGE DETAILS, REFER DRAWING NO. 5223864-ATK-HDG-COWL-DR-CD-000001 TO 000003.
- FOR KERBS, FOOTWAYS AND PAVEMENT DETAILS, REFER DRAWING NO. 5223864-ATK-HPV-COWL-DR-CH-000001 TO 000003.
- FOR STANDARD DETAILS, REFER DRAWING NO. 5223864-ATK-HGN-XX-DR-CH-000002 TO 000004.
- FOR TRAFFIC SIGNS DETAILS, REFER DRAWING NO. 5223864-ATK-HSN-COWL-DR-CH-000001 TO 000003.
- FOR ROAD MARKINGS DETAILS, REFER DRAWING NO. 5223864-ATK-HMK-COWL-DR-CH-000001 TO 000003.

SAFETY, HEALTH AND ENVIRONMENTAL INFORMATION

In addition to the hazards/risks normally associated with the types of work detailed on this drawing, note the following significant residual risks (Reference shall also be made to the design hazard log).

Construction
Live traffic & utilities, Presence of tar.
Presence of soil contamination, asbestos and breaking of concrete not known.

Maintenance / Cleaning
None

Use
None

Decommissioning / Demolition
None

P02	RJ	ANV	AC	09/11/23
For Technical Review				
P03	RG	PM	AC	27/03/24
Updated package following RSA2				
C01	RG	PM	AC	24/05/24
For Construction Issue				
C02	RG	PM	AC	04/07/24
Updated Construction Issue				
Rev	Drawn / Des	Checked	Approved	Date
Description				

Drawing Status	Suitability
APPROVED - PUBLISHED	A1

5 Wellbrook Court,
Cambridge
CB3 0NA

Tel: +44 (0) 1223276002

Copyright © AtkinsRéalis (2024) www.atkinsrealis.com

Client

GREATER CAMBRIDGE PARTNERSHIP
Growing and sharing prosperity
Delivering our City Deal

Project Title
GCP Early Works - Detailed Design

Drawing Title
GENERAL ARRANGEMENT
COWLEY ROAD (SCHEME 2)
(SHEET 1 OF 3)

Scale	Designed / Drawn	Checked	Approved	Authorised
1:500	RG	PM	AC	RH
Original Size	Date	Date	Date	Date
A1	04/07/24	04/07/24	04/07/24	04/07/24
Drawing Number	Project	Originator	Volume	Job No.
5223864	COWL	ATK	HGN	5223864
Location	Type	Role	Number	Revision
	DR	CH	000002	C02

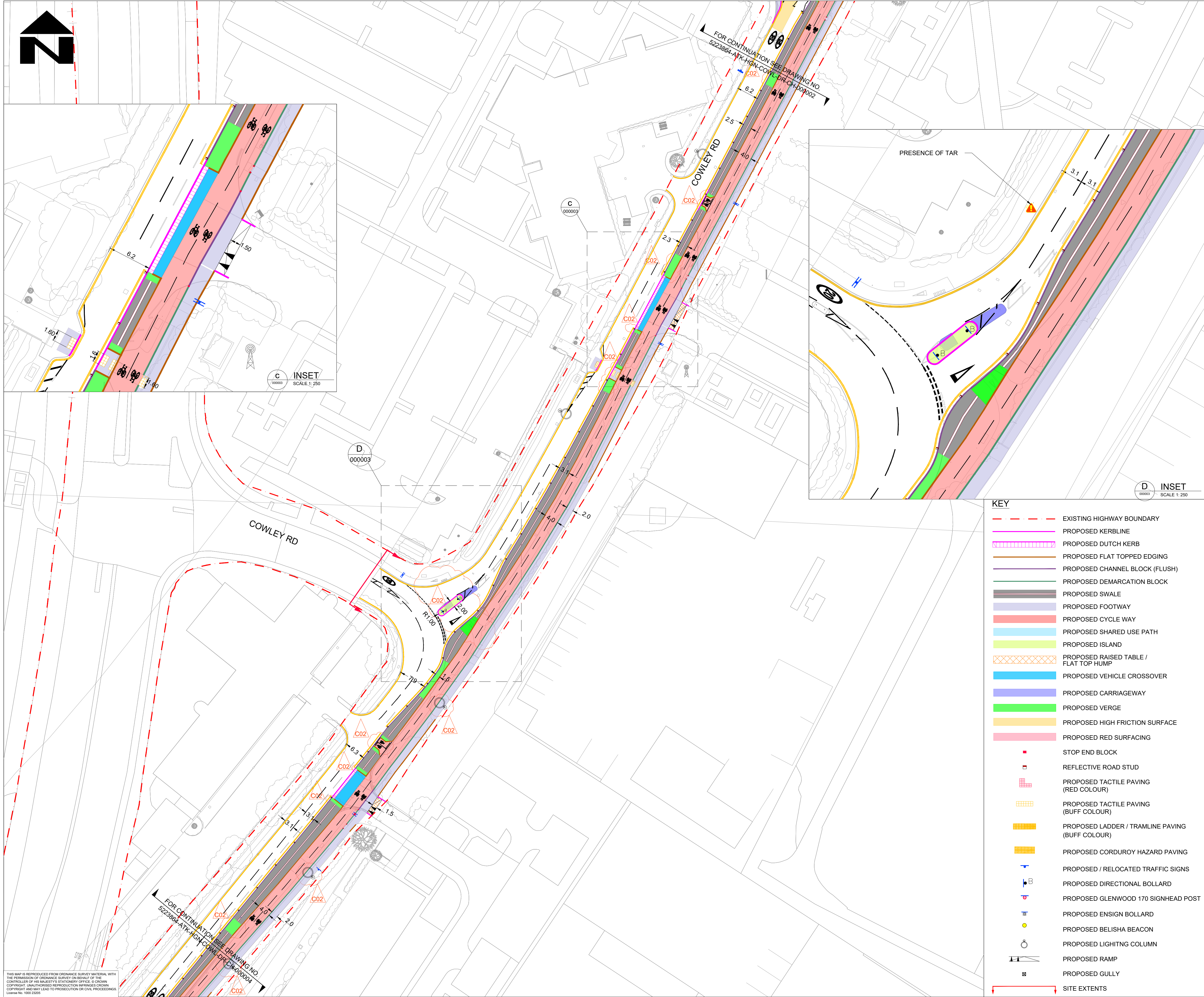

- NOTES**
- DO NOT SCALE FROM THIS DRAWING.
 - ALL DIMENSIONS ARE IN METRES UNLESS OTHERWISE STATED.
 - LIMITS OF WORK ARE APPROXIMATE AND ARE TO BE AGREED ON SITE WITH THE OVERSEEING ORGANISATION.
 - ANY WORK OUTSIDE THE HIGHWAY BOUNDARY NEEDS PRIOR PERMISSION FROM THE LAND OWNER.
 - HEALTH AND SAFETY:
THE CONTRACTOR SHALL BE AWARE OF ALL STATUTORY UNDERTAKERS PLANT THAT MAY BE LOCATED WITHIN THE SITE. PLANS SHOWING APPROXIMATE LOCATIONS HAVE BEEN SUPPLIED BY ASSET OWNER. A SET OF CURRENT (LESS THAN 90 DAYS OLD) C2 RETURNS WILL BE PROVIDED TO THE CONTRACTOR AT THE START OF WORKS.
 - FOR SITE CLEARANCE DETAILS, REFER TO DRAWING NO. 5223864-ATK-HSC-COWL-DR-CH-000001 TO 000003.
 - FOR DRAINAGE DETAILS, REFER DRAWING NO. 5223864-ATK-HDG-COWL-DR-CD-000001 TO 000003.
 - FOR KERBS, FOOTWAYS AND PAVEMENT DETAILS, REFER DRAWING NO. 5223864-ATK-HPV-COWL-DR-CH-000001 TO 000003.
 - FOR STANDARD DETAILS, REFER DRAWING NO. 5223864-ATK-HGN-XX-DR-CH-000002 TO 000004.
 - FOR TRAFFIC SIGNS DETAILS, REFER DRAWING NO. 5223864-ATK-HSN-COWL-DR-CH-000001 TO 000003.
 - FOR ROAD MARKINGS DETAILS, REFER DRAWING NO. 5223864-ATK-HMK-COWL-DR-CH-000001 TO 000003.

SAFETY, HEALTH AND ENVIRONMENTAL INFORMATION

In addition to the hazards/risks normally associated with the types of work detailed on this drawing, note the following significant residual risks (Reference shall also be made to the design hazard log).

Construction
Live traffic & utilities, Presence of tar.
Presence of soil contamination, asbestos and breaking of concrete not known.

Maintenance / Cleaning
None

Use
None

Decommissioning / Demolition
None

P02	RJ	ANV	AC	09/11/23
-----	----	-----	----	----------

For Technical Review	P03	RG	PM	AC	27/03/24
----------------------	-----	----	----	----	----------

Updated package following RSA2	C01	RG	PM	AC	24/05/24
--------------------------------	-----	----	----	----	----------

For Construction Issue	C02	RG	PM	AC	04/07/24
------------------------	-----	----	----	----	----------

Updated Construction Issue

Rev	Drawn / Des	Checked	Approved	Date
-----	-------------	---------	----------	------

Description

Drawing Status	Suitability
APPROVED - PUBLISHED	A1

5 Wellbrook Court,
Cambridge
CB3 0NA

Tel: +44 (0) 1223276002

Copyright © AtkinsRéalis (2024)

www.atkinsrealis.com

GREATER CAMBRIDGE PARTNERSHIP
Growing and sharing prosperity
Delivering our City Deal

Project Title
GCP Early Works - Detailed Design

Drawing Title
**GENERAL ARRANGEMENT
COWLEY ROAD (SCHEME 2)
(SHEET 2 OF 3)**

Scale	Designed / Drawn	Checked	Approved	Authorised
1:500	RG	PM	AC	RH
Original Size	Date	Date	Date	Date
A1	04/07/24	04/07/24	04/07/24	04/07/24
Drawing Number	Project	Originator	Volume	Job No.
5223864	COWL	ATK DR	HGN 000003	5223864
Location	Type	Role	Number	Revision
COWL	DR	CH	000003	C02

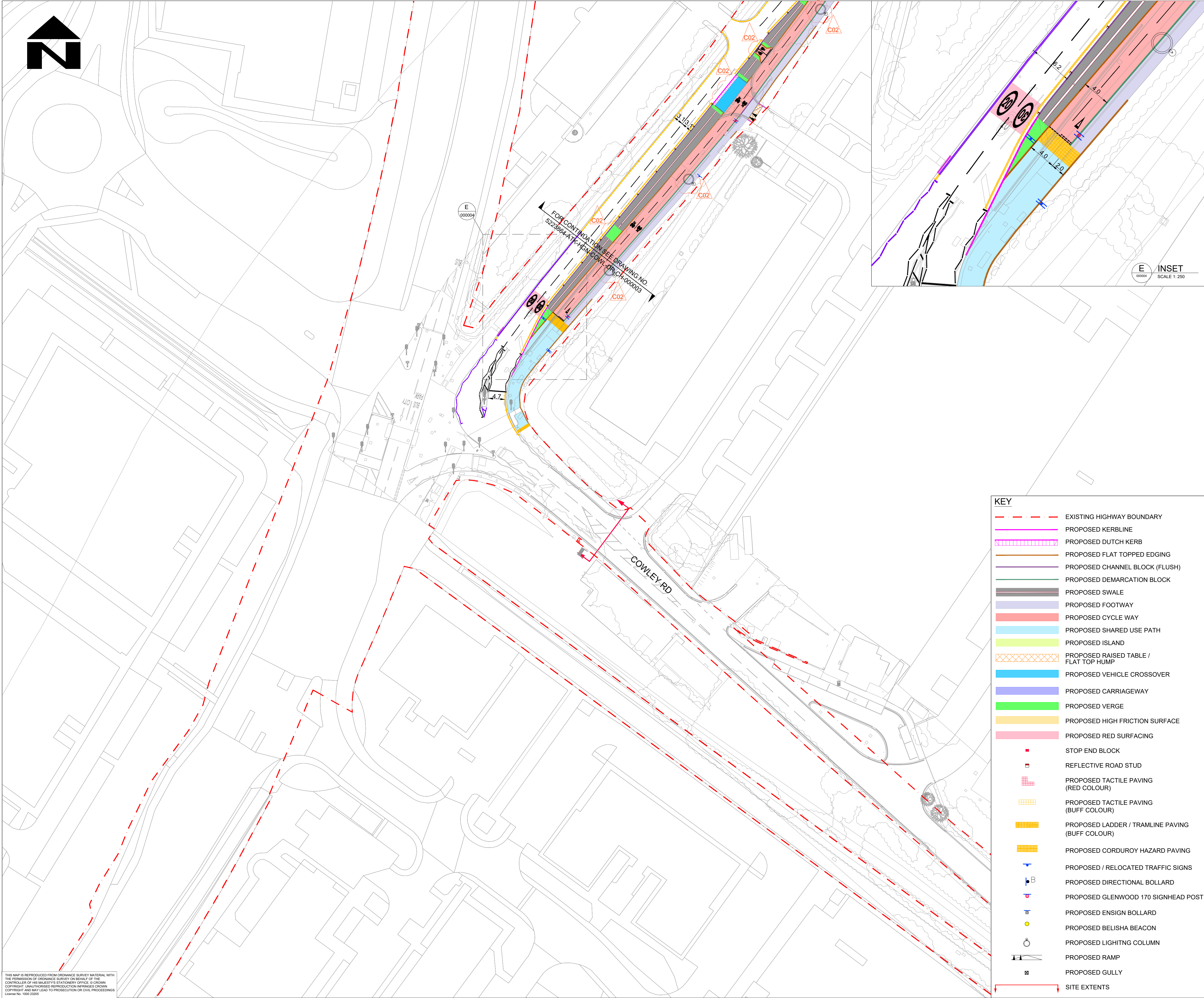

- NOTES**
- DO NOT SCALE FROM THIS DRAWING.
 - ALL DIMENSIONS ARE IN METRES UNLESS OTHERWISE STATED.
 - LIMITS OF WORK ARE APPROXIMATE AND ARE TO BE AGREED ON SITE WITH THE OVERSEEING ORGANISATION.
 - ANY WORK OUTSIDE THE HIGHWAY BOUNDARY NEEDS PRIOR PERMISSION FROM THE LAND OWNER.
 - HEALTH AND SAFETY:
THE CONTRACTOR SHALL BE AWARE OF ALL STATUTORY UNDERTAKERS PLANT THAT MAY BE LOCATED WITHIN THE SITE. PLANS SHOWING APPROXIMATE LOCATIONS HAVE BEEN SUPPLIED BY ASSET OWNER. A SET OF CURRENT (LESS THAN 90 DAYS OLD) C2 RETURNS WILL BE PROVIDED TO THE CONTRACTOR AT THE START OF WORKS.
 - FOR SITE CLEARANCE DETAILS, REFER TO DRAWING NO. 5223864-ATK-HSC-COWL-DR-CH-000001 TO 000003.
 - FOR DRAINAGE DETAILS, REFER DRAWING NO. 5223864-ATK-HDG-COWL-DR-CD-000001 TO 000003.
 - FOR KERBS, FOOTWAYS AND PAVEMENT DETAILS, REFER DRAWING NO. 5223864-ATK-HPV-COWL-DR-CH-000001 TO 000003.
 - FOR STANDARD DETAILS, REFER DRAWING NO. 5223864-ATK-HGN-XX-DR-CH-000002 TO 000004.
 - FOR TRAFFIC SIGNS DETAILS, REFER DRAWING NO. 5223864-ATK-HSN-COWL-DR-CH-000001 TO 000003.
 - FOR ROAD MARKINGS DETAILS, REFER DRAWING NO. 5223864-ATK-HMK-COWL-DR-CH-000001 TO 000003.

SAFETY, HEALTH AND ENVIRONMENTAL INFORMATION

In addition to the hazards/risks normally associated with the types of work detailed on this drawing, note the following significant residual risks (Reference shall also be made to the design hazard log).

Construction
Live traffic & utilities, Presence of tar.
Presence of soil contamination, asbestos and breaking of concrete not known.

Maintenance / Cleaning
None

Use
None

Decommissioning / Demolition
None

P02	RJ	ANV	AC	09/11/23
-----	----	-----	----	----------

For Technical Review	P03	RG	PM	AC	27/03/24
----------------------	-----	----	----	----	----------

Updated package following RSA2	C01	RG	PM	AC	24/05/24
--------------------------------	-----	----	----	----	----------

For Construction Issue	C02	RG	PM	AC	04/07/24
------------------------	-----	----	----	----	----------

Updated Construction Issue

Rev	Drawn / Des	Checked	Approved	Date
-----	-------------	---------	----------	------

Description

Drawing Status	Suitability
----------------	-------------

APPROVED - PUBLISHED **A1**

5 Wellbrook Court,
Cambridge
CB3 0NA

Tel: +44 (0) 1223276002

Copyright © AtkinsRéalis (2024) www.atkinsrealis.com

GREATER CAMBRIDGE PARTNERSHIP

Growing and sharing prosperity
Delivering our City Deal

Project Title
GCP Early Works - Detailed Design

**GENERAL ARRANGEMENT
COWLEY ROAD (SCHEME 2)
(SHEET 3 OF 3)**

Scale	Designed / Drawn	Checked	Approved	Authorised
1:500	RG	PM	AC	RH
Original Size	Date	Date	Date	Date
A1	04/07/24	04/07/24	04/07/24	04/07/24
Drawing Number	Project	Originator	Volume	Job No.
5223864	COWL	ATK DR	HGN 000004	5223864
Location	Type	Role	Number	Revision
COWL	DR	CH	000004	C02

THIS MAP IS REPRODUCED FROM ORDNANCE SURVEY MATERIAL WITH THE PERMISSION OF ORDNANCE SURVEY ON BEHALF OF THE CONTROLLER OF HIS MAJESTY'S STATIONERY OFFICE. © CROWN COPYRIGHT. UNAUTHORISED REPRODUCTION INFRINGES CROWN COPYRIGHT AND MAY LEAD TO PROSECUTION OR CIVIL PROCEEDINGS. License No. 1000 23055