

70092842-WSP-XX-DR-LP-0100-04

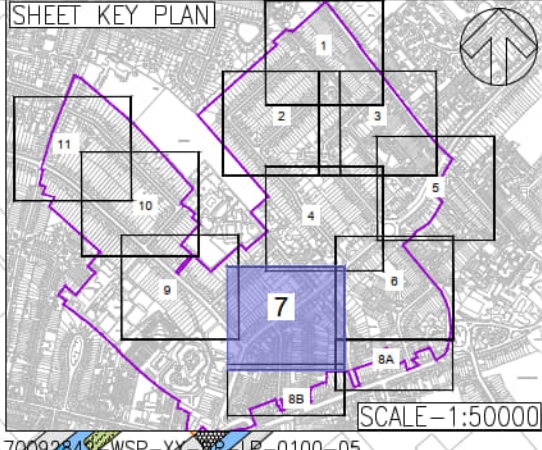

NOTE:

ALL DIMENSIONS ARE GIVEN IN METERS, UNLESS STATED OTHERWISE

KEYS:

- SCHEME BOUNDARY
- RETAINED ROAD MARKINGS
- RETAINED DOUBLE YELLOW LINE
- PROPOSED PARKING BAY MARKING
- PROPOSED DOUBLE YELLOW LINE
- PARKING BAY MARKING TO BE REMOVED
- DOUBLE YELLOW LINE TO BE REMOVED
- EXISTING ACCESS
- PRIVATE PARKING BAYS

P01	12-09-2022	AK/NTR	FOR INFORMATION	DG	OM
REV	DATE	BY	DESCRIPTION	CHK	APP

DRAWING STATUS: S2 - FOR INFORMATION



62-64 Hills Road, Cambridge, CB2 1LA, UK
T+ 44 (0) 1223 558 050, F+ 44 (0) 1223 558 051
wsp.com

CLIENT:



**Cambridgeshire
County Council**

PROJECT: GCP RESIDENT PARKING SCHEME

TITLE: GENERAL ARRANGEMENT SHEET 07 of 12

SCALE @ A3: 1:1000	CHECKED: DG	APPROVED: OM
PROJECT No: 70092842	DESIGNED: AK/NTR	DRAWN: AK
	DATE: September 22	
DRAWING No: 70092842-WSP-XX-DR-LP-0100-07	REV: P01	

© WSP UK Ltd

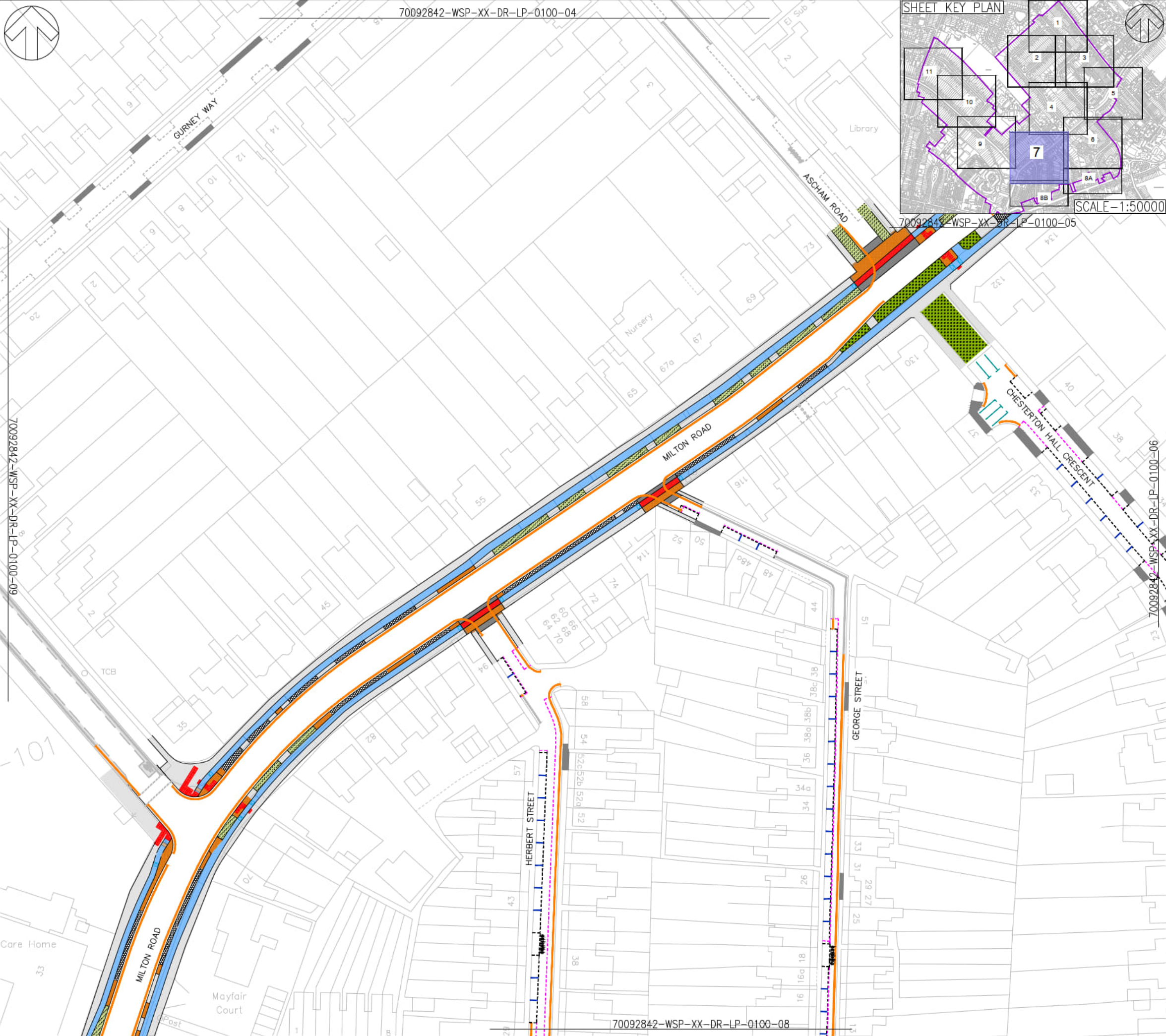

70092842-WSP-XX-DR-LP-0100-09

70092842-WSP-XX-DR-LP-0100-08