

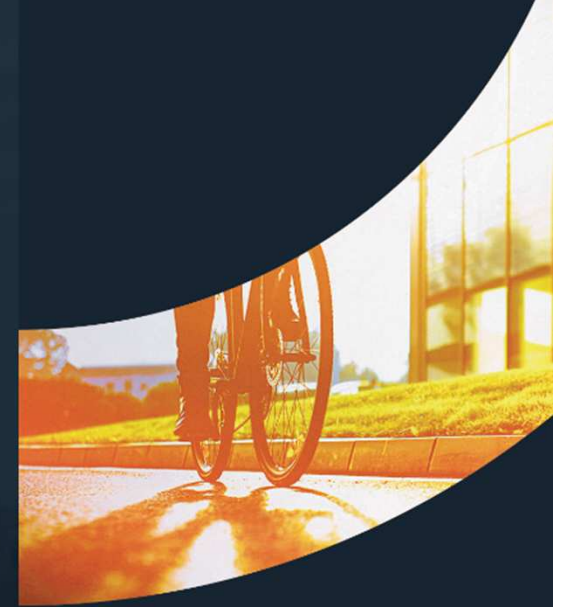

**GREATER  
CAMBRIDGE  
PARTNERSHIP**

**Growing and sharing prosperity**

Delivering our City Deal



# Milton Road

## Post Consultation Design Workshop

22 January 2019



# Milton Road Project Objectives

- Comprehensive priority for buses in both directions wherever practicable;
- Safer and more convenient routes for cycling and walking, segregated where practical and possible;
- Enhance the environment, streetscape and air quality;
- Additional capacity for sustainable trips to employment/education sites;
- Increased bus patronage and new services; and
- Maintain or reduce general traffic levels.



# Consultation Response

- Over 15,000 household received a consultation brochure
- **870 completed** questionnaires were received
- All questions gained more support than opposition with most questions gaining significant support.
- The project team have also talked in depth with Road Safety Officers, Signals Team and Cycling Officers
- This engagement process has led us to consider a number of design changes which we will outline and discuss in the workshop groups.



# Workshop Discussion

- Presentation outlining the main proposed design changes and reasons – **15 minutes**
- Smaller groups to discuss the proposed changes that have been presented with the aim to provide specific comments that relate to local context or local knowledge - **30 minutes**
- Feedback from all groups - **15 minutes**



# Proposed Design Modification

1. Relocate outbound bus stop near Westbrook Place.
2. Addition of signalised crossing near Westbrook Place and subsequent changes to the design of Gilbert Road junction.
3. More space for pedestrians and cyclists at Elizabeth Way roundabout.
4. Slight modifications to inbound bus stop location near Arbury Road junction.
5. Slight modifications to the Arbury Road junction.
6. Addition of signalised crossing near Downhams Lane.
7. Slight relocation of outbound bus stop.
8. Re-worked design for the area around Woodhead Drive to enhance the outbound bus lane, shorten the inbound bus lane, and provide an uncontrolled crossing.
9. New design option for pedestrian and cycling interfaces at Kings Hedges junction
10. Treatment of the outbound pavement between Ascham Road and Ramsden Square

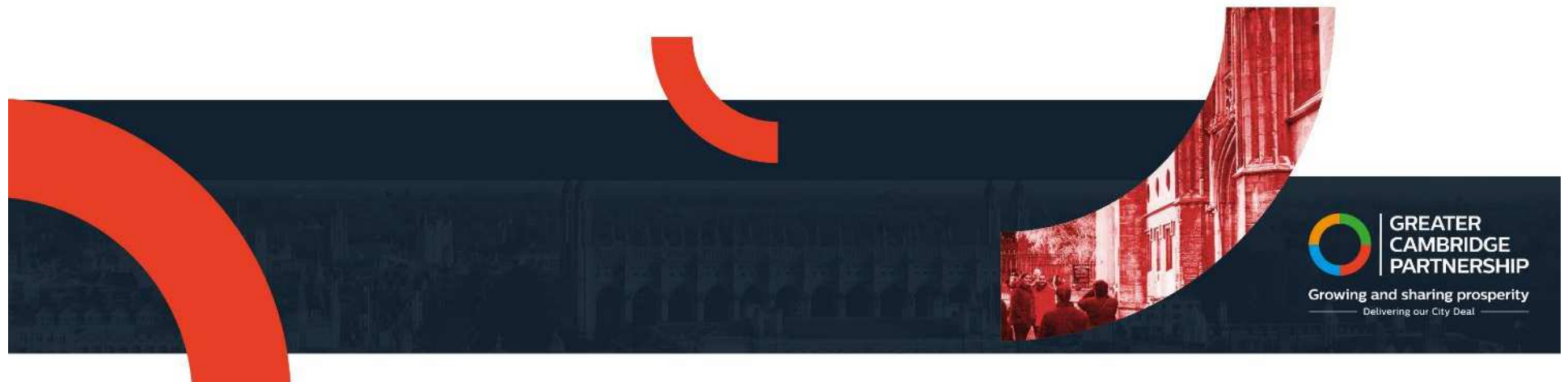



# Bus Stop and Crossing near Westbrook Place



# Gilbert Road Junction

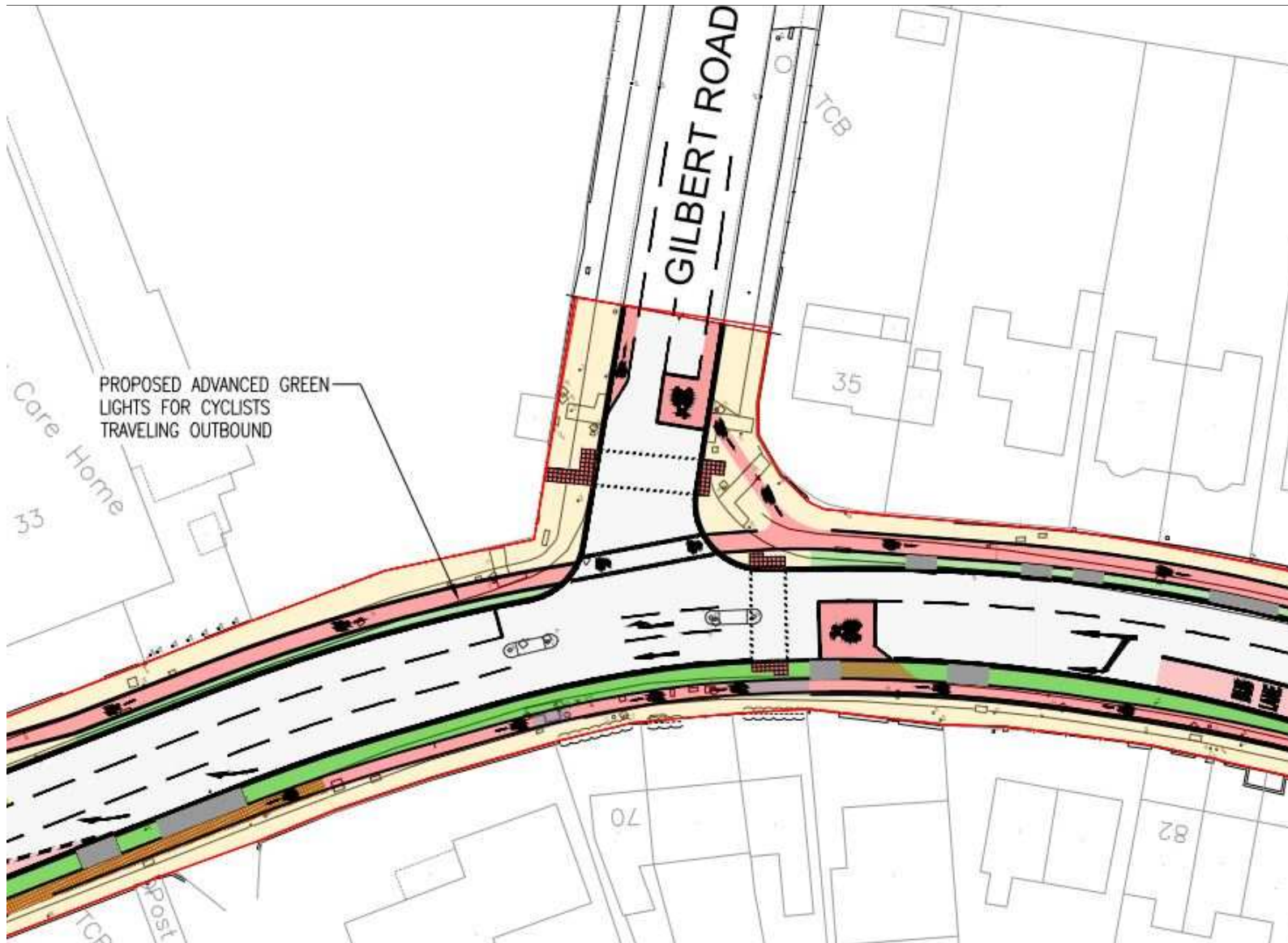



# Elizabeth Way Roundabout

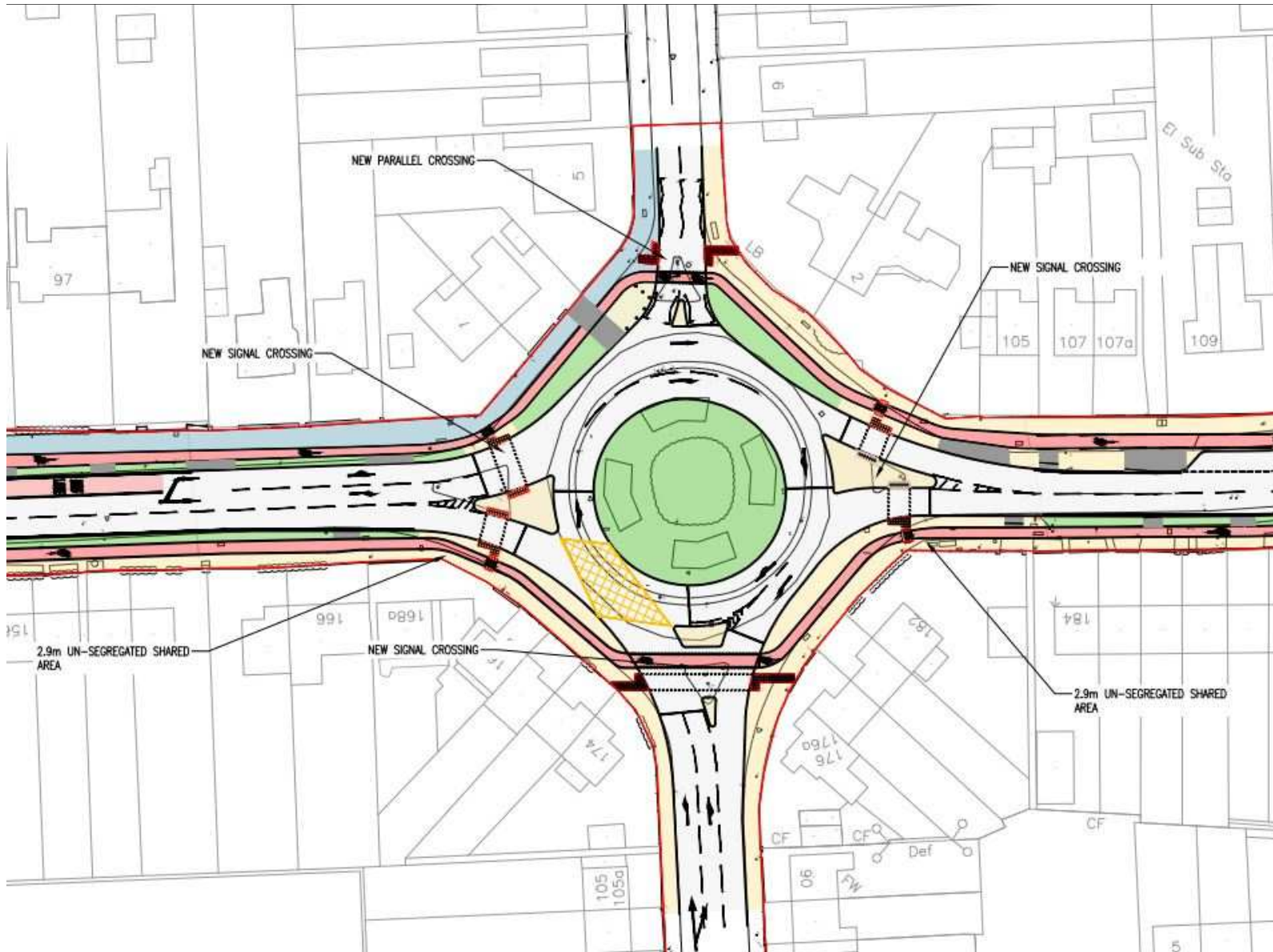



# Arbury Road Junction

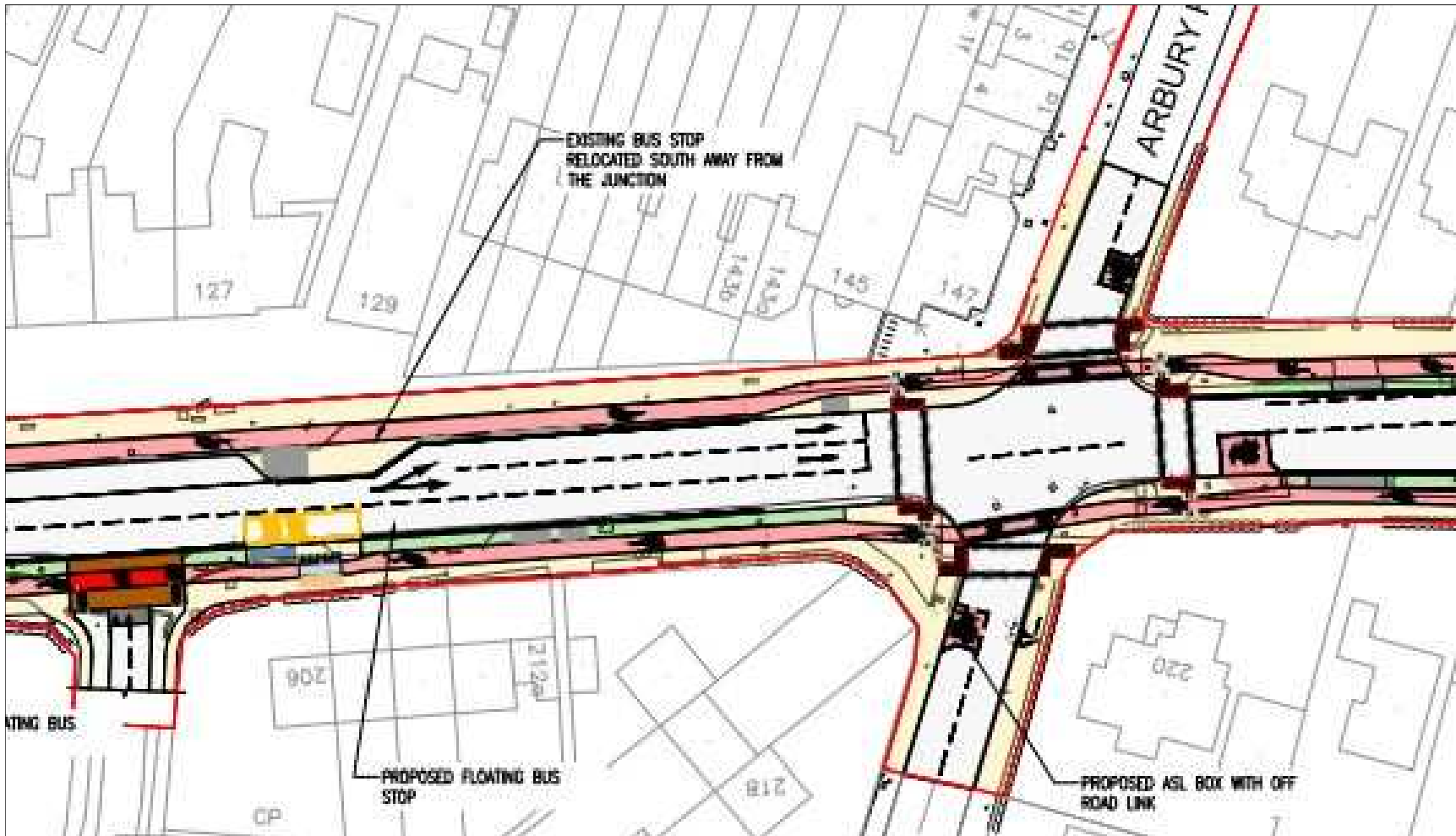

# Downham's Lane crossing and Middleton Close Bus Stop



# Area Around Woodhead Drive





# Kings Hedges Junction Option 1

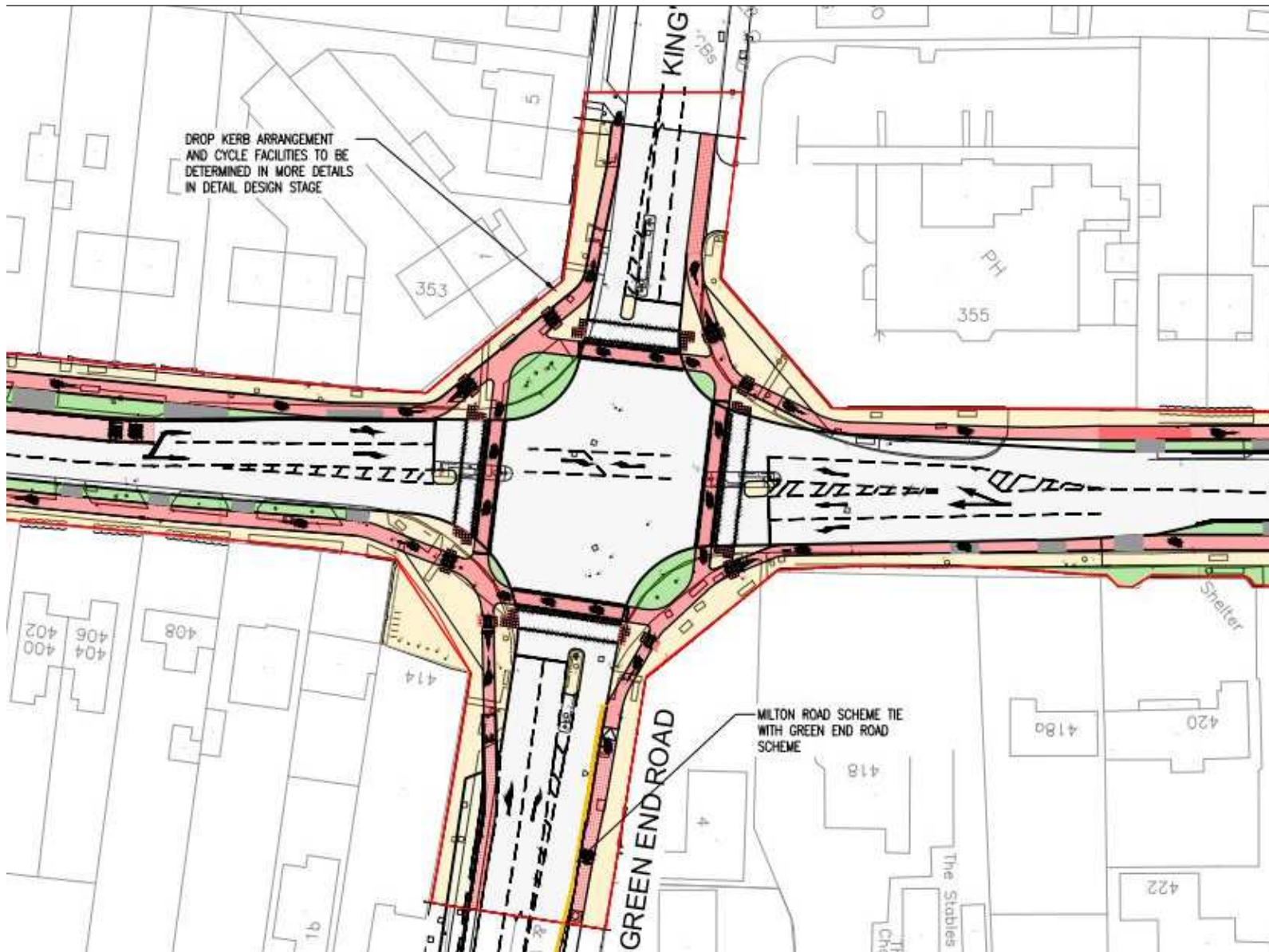



# Kings Hedges Junction Option 2



# Shared Use between Ascham Road and Highworth Avenue



# Workshop Discussion – 30 minutes

	Design Change	Requested Action
1	Westbrook Drive to Gilbert Road	General views / Comments on proposed changes
2	Elizabeth Way Roundabout	
3	Arbury Road junction	
4	Area around Woodhead Drive	Discuss pros and cons of of the revised design
5	Kings Hedges junction	Discuss pros and cons of the revised design compared to the original.
6	Shared use vs non shared use	Discuss pros and cons of of options in light of consultation response

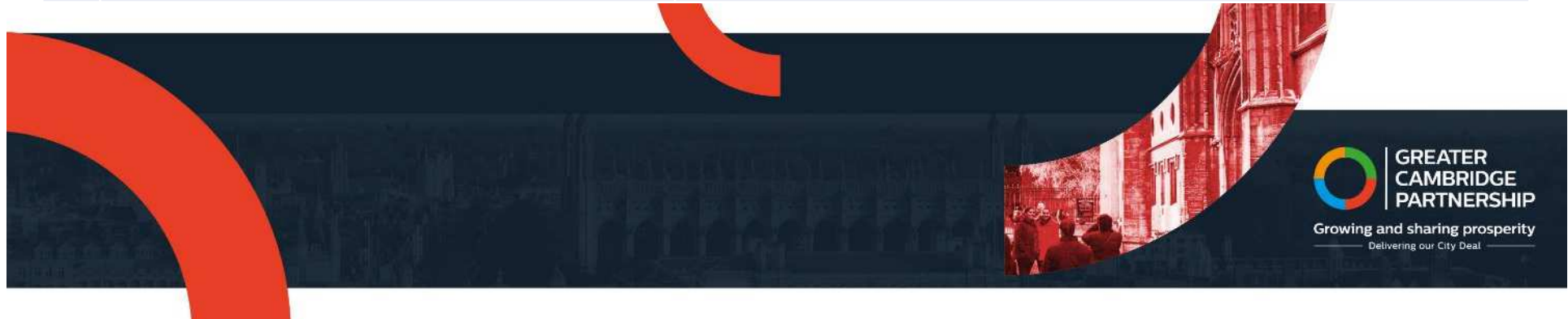

# Next Steps - Further Design Work

- Extensive work continues to take place with the Signals and Safety team to ensure the design is both safe and functions correctly.
- Formal Stage 1 safety audit to be undertaken once the design has been finalised.

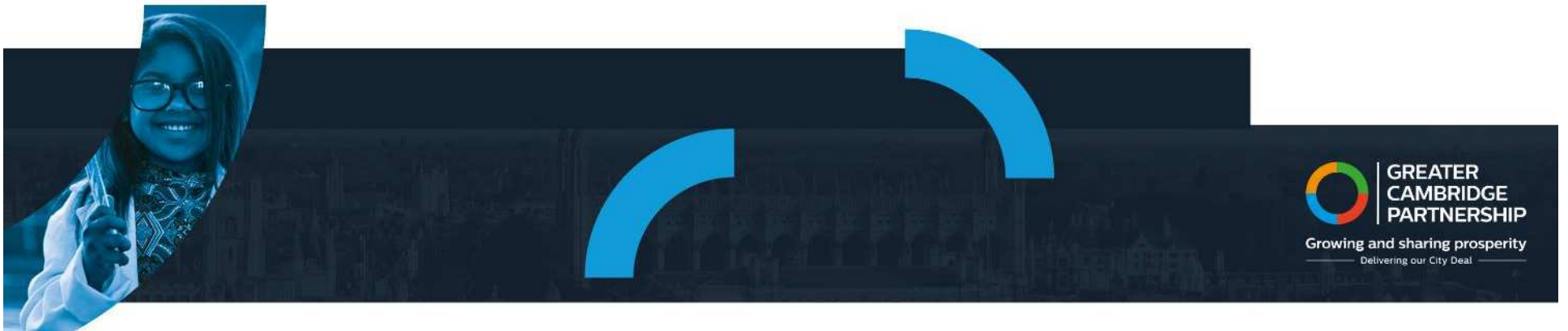



# Programme and Timescales

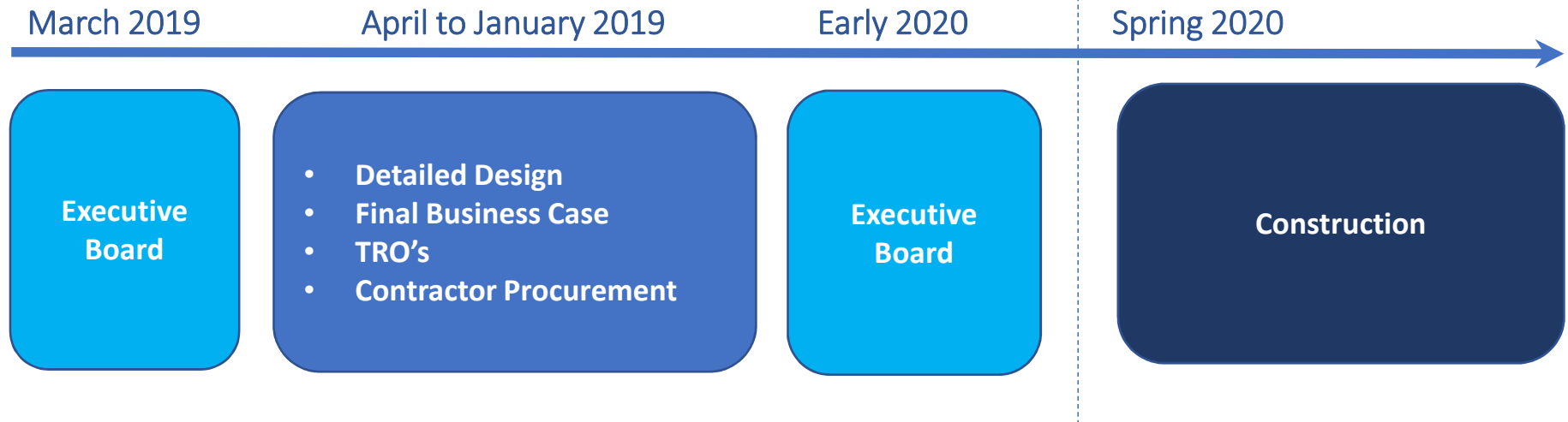

# Discussion