

- NOTES:**
- For full planting schedule refer to sheet 12 drawing: 'MILT-WSP-00-XX-DR-LA-003012'.
 - For Typical Landscape Details, refer to drawings: 'MILT-WSP-00-XX-DR-LA-003511 to 003513'.
 - For Landscape Intervention Area Sections, refer to: 'MILT-WSP-AR-XX-DR-LA-003101; MILT-WSP-EW-XX-DR-LA-003201; MILT-WSP-WD-XX-DR-LA-003301; and MILT-WSP-KH-XX-DR-LA-003401'.
 - For Landscape Management and Maintenance Plan, refer to document: 'MILT-WSP-00-XX-RP-LA-003901'.
 - For Site Clearance Trees & Vegetation plans refer to: 'MILT-WSP-00-XX-DR-LA-000201 to 000211'.

- HEALTH AND SAFETY SYMBOLS LEGEND**
- INDICATES A RESIDUAL RISK REQUIRING A COMPULSORY ACTION
 - INDICATES A RESIDUAL RISK FOR INFORMATION
 - INDICATES A RESIDUAL RISK REQUIRING A PROHIBITIVE ACTION
 - INDICATES A RESIDUAL RISK AS A WARNING
- POTENTIAL H-S RISKS**
- POTENTIAL CLASH WITH OVERHEAD CABLES WHILE MOVING OR PLANTING TREES
 - UNDERGROUND UTILITIES THROUGHOUT THE SCHEME. RISK OF STRIKING UTILITIES WHEN EXCAVATING TO REMOVE EXISTING VEGETATION OR TO PLANT PROPOSED VEGETATION
 - FALLING OF EXISTING TREE DUE TO LOCAL EXCAVATION
- Notes:
For further Health and Safety Information see Designers Risk Management Schedule

DO NOT SCALE

KEY

Work extents

PROPOSED SOFT LANDSCAPE

Root barriers are to be included to protect utilities in close proximity to trees. Refer to Typical Landscape Details, drawings: 'MILT-WSP-00-XX-DR-LA-003511. Depth, length, and specification of root barriers may differ in different locations and in relation to utilities. Contractor to ensure sufficient volume of soil for trees is provided whilst protecting each utility by root barriers.

- Tree (16-18cm girth)
- Tree (20-25cm girth)
- Ornamental Planting
- Grass verge
- Wildflower Meadow Swale
- Rain garden

EXISTING SOFT LANDSCAPE

Refer to Site Clearance Trees & Vegetation plans: 'MILT-WSP-00-XX-DR-LA-000201 to 000211'

- Tree to be retained
- Tree to be removed
- TPO tree
- Root Protection Area

PROPOSED HARD LANDSCAPE

For details, refer to drawing: 'MILT-WSP-00-XX-DR-LA-003511'

- Tree Pit Surface (Size 1). Dimensions: L 1200 x W 900mm. Permeable Resin Bound Gravel framed with aluminium edging. 400mm diameter aperture around tree stem to be in-filled with loose decorative gravel.
- Tree Pit Surface (Size 2). Dimensions: L 1250 x W 1250mm. Permeable Resin Bound Gravel framed with aluminium edging. 400mm diameter aperture around tree stem to be in-filled with loose decorative gravel.
- SC Area. Xmf. Extent of Underground Soil Cells (SC) (Total area approx. = 596m²). Supplier: Green Blue Urban. Product: RootSpace 400 Upright, Single Plane. Material: 100% recycled polypropylene.

PROPOSED STREET FURNITURE

- Bollard. Refer to engineer's drawings: 'MILT-WSP-00-XX-DR-CV-000001 to 000011'.
- Bus Shelter. Refer to engineer's drawings: 'MILT-WSP-00-XX-DR-CV-000001 to 000011'.
- Swales & Rain Garden Inlet. For details of swale and rain garden inlet, refer to landscape drawing: 'MILT-WSP-00-XX-DR-LA-003513'.

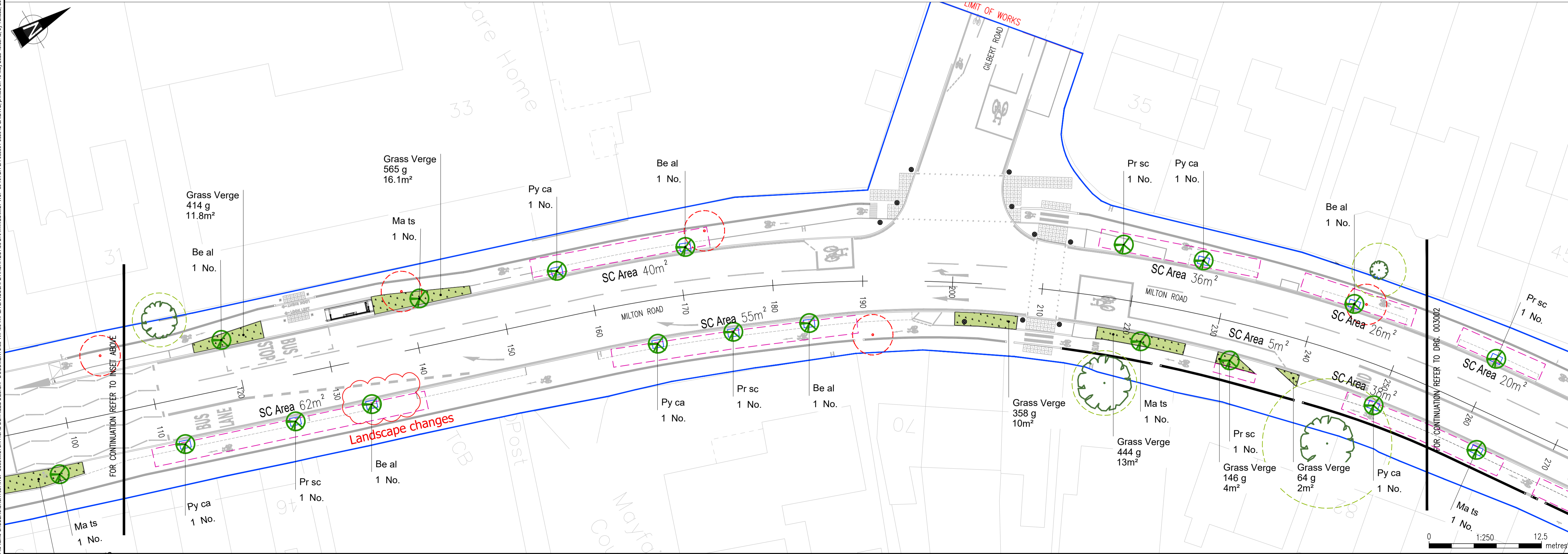
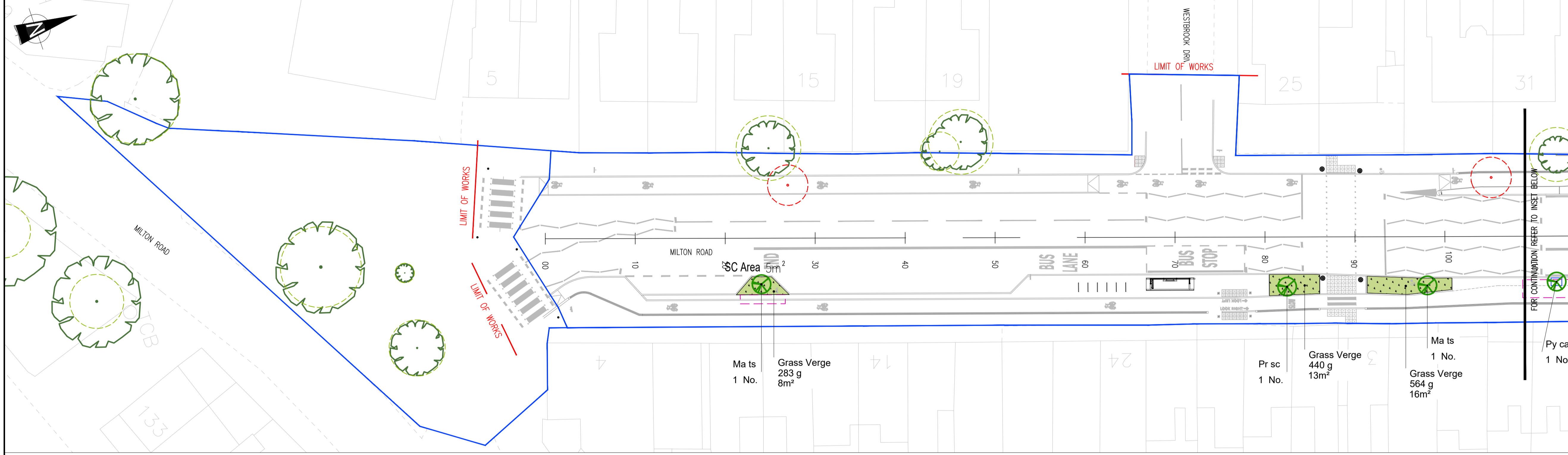

REV	DATE	BY	DESCRIPTION	CHK	APP
C03	09/05/2023	ST	REVISED LANDSCAPE DESIGN FOLLOWING REVISION TO HIGHWAYS LAYOUT	AK	PT
C02	16/03/2023	ST	REVISED LANDSCAPE DESIGN FOLLOWING REVISION TO HIGHWAYS LAYOUT	AK	PT
C01	01/04/2022	HG	ISSUED FOR CONSTRUCTION	AK	PT
P02	13/11/2020	TE	ISSUED FOR REVIEW	AK	PT
P01	07/10/2020	TE	FIRST ISSUE	AK	PT

DRAWING STATUS: **A - FIT FOR CONSTRUCTION**

62-64 Hills Road, Cambridge, CB2 1LA, UK
T+44 (0) 1223 558 050, F+44 (0) 1223 558 051
wsp.com

CLIENT: **GREATER CAMBRIDGE PARTNERSHIP**

ARCHITECT: **MILTON ROAD DETAILED DESIGN**

TITLE: **LANDSCAPE GENERAL ARRANGEMENT PLAN SHEET 01 of 12**

SCALE @ A1	CHECKED	APPROVED
1:250	AK	PT

PROJECT NO	DESIGNED	DRAWN	DATE
70056482	TE	TE/HG	OCT 2020

DRAWING NO	REV
MILT-WSP-00-XX-DR-LA-003001	C03

© WSP UK Ltd

File name: C:\Users\jst01\OneDrive\Documents\WSP\Projects\WSP\LA Landscape\ARCHITECT\DRAWINGS\MILT-WSP-00-XX-DR-LA-003001-003012-CA.DWG, printed on 10 May 2023 13:52:42, by Tahaad, Site

This drawing may contain: Ordnance Survey data © Crown copyright and database right 2023.