

DO NOT SCALE

Notes:

- This drawing must be printed in colour.
- All design information shown is outline/indicative. The detailed design of these features will be subject to approval by the Local Planning Authority as part of the deemed planning conditions.
- The drawing shall only be used for the intended purpose it has been issued for which is for outline/illustrative design for a TWAO application.
- The 2D layout has been developed based on the OS Mastermap Topography Layer or Topographical surveys where available. The outline design may be subject to change during the subsequent design stages as more detailed topographical survey data becomes available.
- The 3D aspects of the design have been developed based on Topographical survey data where available. The Environment Agency LiDAR Composite DTM 2m (2020) licensed under the Open Government Licence v3.0 has been used to fill any gaps in the Topographical survey data. The outline design may be subject to change during the subsequent design stages as more detailed topographical survey data becomes available.
- Public transport stop locations and waiting areas are indicative and may be subject to change.
- The designs for street lighting, fencing, vehicle restraint systems and other features will be developed in the subsequent design stage.
- All linear dimensions shown on plan are in metres unless otherwise indicated, and measurements must not be scaled from the drawing.
- All existing private property accesses along the extents of the proposed scheme are to be maintained where possible. Designs for alternative suitable accesses and accommodation works will be developed where necessary.
- The landscaping details shown are indicative. Refer to drawing numbers 70086660\_WSP\_XX\_DR\_LX\_0001 to 0019 for further details

Key:

- Site Extents Boundary
  - Existing and Improved Highway
  - Busway
  - Busway Stop
  - Maintenance & Emergency Access Track
  - Proposed Footway & Footway Improvements
  - Earthworks Cutting (Slope varies 1 in 3 or 1 in 4)
  - Earthworks Embankment (Slope varies 1 in 3 or 1 in 4)
  - Drainage Swale
  - Detention basin/retention ponds shown indicatively (sizes and shapes vary)
  - Retaining Feature
  - Busway Speed Restrictions (50mph unless otherwise shown)
  - Traffic Signals (Indicative)
  - Developer Designed Section of Busway and Maintenance & Emergency Access Track
  - Existing Public Right of Way - Footpath
  - Existing Public Right of Way - Bridleway
  - Diverted Public Right of Way - Footpath
  - Diverted Public Right of Way - Bridleway
  - Existing Public Right of Way to be Stopped Up - Footpath
  - Existing Public Right of Way to be Stopped Up - Bridleway
- SOFT LANDSCAPE - Refer to landscape general arrangement drawings for further details
- Individual Trees- Locations Indicative to be finalised through detailed design stages
  - Grassland Feature
  - Shrub Planting
  - Hedgerows
  - Marginal/Aquatics and Emergent Planting
  - Native Woodland Planting

P01	08/03/2023	JS	FIRST ISSUE	PK	PK
REV	DATE	BY	DESCRIPTION	CHK	APP

DRAWING STATUS: S2 - FOR INFORMATION



62-64 Hills Road, Cambridge, CB2 1LA, UK  
T+ 44 (0) 1223 558 050, F+ 44 (0) 1223 558 051  
wsp.com

CLIENT: GREATER CAMBRIDGE PARTNERSHIP

ARCHITECT:

SITE PROJECT: C2C TWAO STAGE

TITLE: DEEMED PLANNING DRAWINGS  
PROPOSED SITE PLANS  
(SHEET 12 OF 17)

SCALE @ A1:	1:1250	CHECKED:	BN	APPROVED:	BN
PROJECT NO:	70086660	DESIGNED:	JS	DRAWN:	VR
				DATE:	March 23

DRAWING No: 70086660-WSP-HGN-XX-DR-HW-002012 REV: P01

© WSP UK Ltd

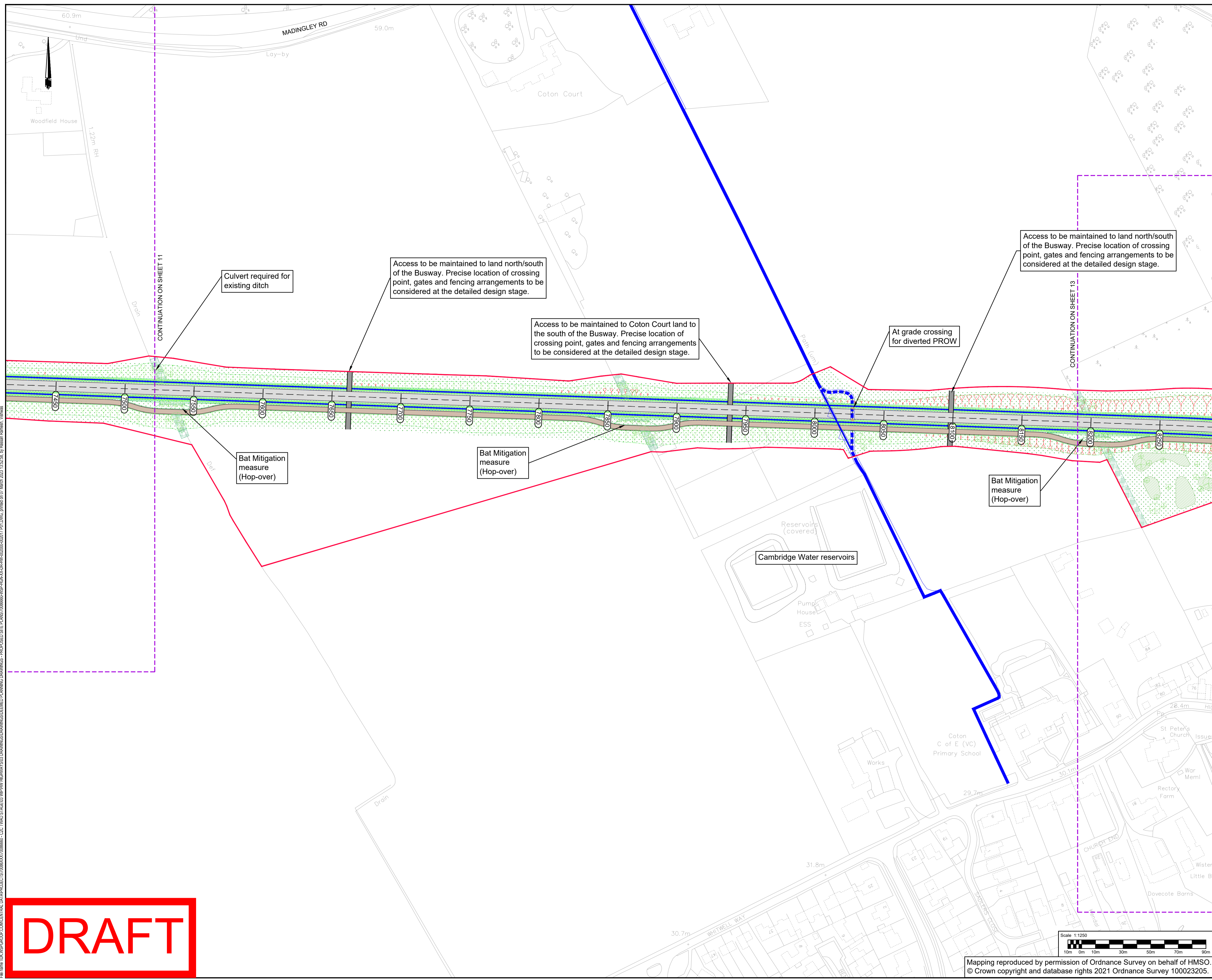

File: c:\msd\group\central\_data\project\70086660\c2c\_twao\_stage\03\_mph\hw\hgw\hgw\002012\p01.dwg, Printed on 07 March 2023 11:52:38, by Hassan Ramach, Value

**DRAFT**

Mapping reproduced by permission of Ordnance Survey on behalf of HMSO. © Crown copyright and database rights 2021 Ordnance Survey 100023205.