

DO NOT SCALE

Notes:

1. This drawing must be printed in colour.
2. All design information shown is outline/indicative. The detailed design of these features will be subject to approval by the Local Planning Authority as part of the deemed planning conditions.
3. Refer to the Proposed Site Plans for further details of the permanent works.
4. The drawing shall only be used for the intended purpose it has been issued for which is for outline/illustrative design for a TWAO application.
5. All linear dimensions shown on plan are in metres unless otherwise indicated, and measurements must not be scaled from the drawing.

Site Traffic:

6. Temporary haul route to run parallel to permanent route with turning heads. Use of a gyratory system to make haul route one way for main activities e.g. Surfacing, is to be considered.
7. Site traffic to approach site on the A428 and M11, then go south side
8. Access to compounds onto highway will be limited to minimise habitat loss

Construction Compounds:

9. Local area compounds are located at 1km intervals for welfare, local storage and plant
10. The main compound is located at the future park and ride site
11. Larger compounds are required at the retaining walls junction and M11 bridge locations
12. M11 bridge compounds for bridge construction, deck fabrication and storage
13. Compounds at side road crossings for welfare, site access, control offices and storage
14. Compounds fenced and include topsoil storage for reinstatement and placed to shield from nearby properties
15. Utility works contractors will share the compounds shown

Key:

- Site Extents Boundary
- Construction Compounds
- Site Access Points

P01	03/03/2023	AC	FIRST ISSUE		JL	BN
REV	DATE	BY	DESCRIPTION		CHK	APP

DRAWING STATUS: S2 - FOR INFORMATION



62-64 Hills Road, Cambridge, CB2 1LA, UK
T+ 44 (0) 1223 558 050, F+ 44 (0) 1223 558 051
wsp.com

CLIENT: GREATER CAMBRIDGE PARTNERSHIP

SITE PROJECT: C2C TWAO STAGE

TITLE: DEEMED PLANNING DRAWINGS
CONSTRUCTION PLANS
(SHEET 1 OF 17)

SCALE @ A1:	1:1250	CHECKED:	JL	APPROVED:	BN
PROJECT NO:	70086660	DESIGNED:	JL	DRAWN:	AC
				DATE:	March 23

DRAWING No:	70086660-WSP-TTM-XX-DR-CP-900001	REV:	P01
-------------	----------------------------------	------	-----

© WSP UK Ltd

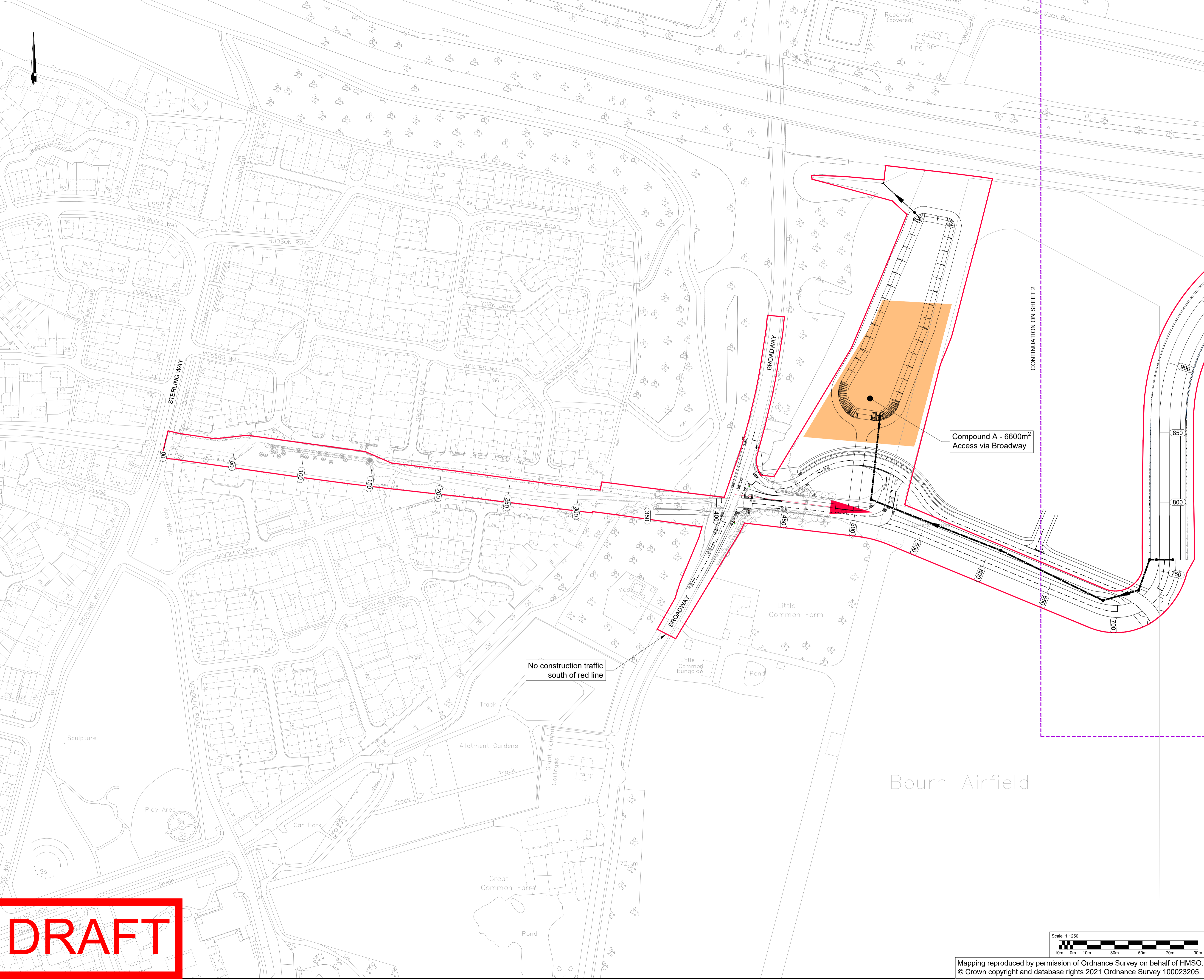

File: \\uk\wsp\group\cam\central_data\projects\70086660\SS-TTM-XX-DR-CP-900001\SS-TTM-XX-DR-CP-900001\SS-TTM-XX-DR-CP-900001\SS-TTM-XX-DR-CP-900001.dwg, printed on 08 March 2023, 12:45:45, by Newman, Ben

DRAFT

Mapping reproduced by permission of Ordnance Survey on behalf of HMSO.
© Crown copyright and database rights 2021 Ordnance Survey 100023205.