



MOTT  
MACDONALD



GREATER  
CAMBRIDGE  
PARTNERSHIP

# A1307 Cambridge South East Transport

27<sup>th</sup> May 2021

Phase 1 General Scheme Update

Greater Cambridge Partnership

**M****MOTT  
MACDONALD****M**GREATER  
CAMBRIDGE  
PARTNERSHIP

# Agenda

- Linton Greenway (The Abingtons to Linton)
- Hildersham Crossroads
- Bartlow Road roundabout
- Dean Road Crossroads
- Average speed camera works Linton to Horseheath



# Background

- ▶ The last meeting was held in January 2021 in order to provide update as to status for all the schemes along A1307 corridor, including where measures are still being considered to be taken forward as part of the scheme, subject to funding
- ▶ Purpose of this meeting is to provide update as to status for all the schemes along A1307 corridor, including which elements are currently being developed following the funding review

## Scheme 3 - Linton Greenway

### Section 4: Newmarket Road to Dalehead Foods

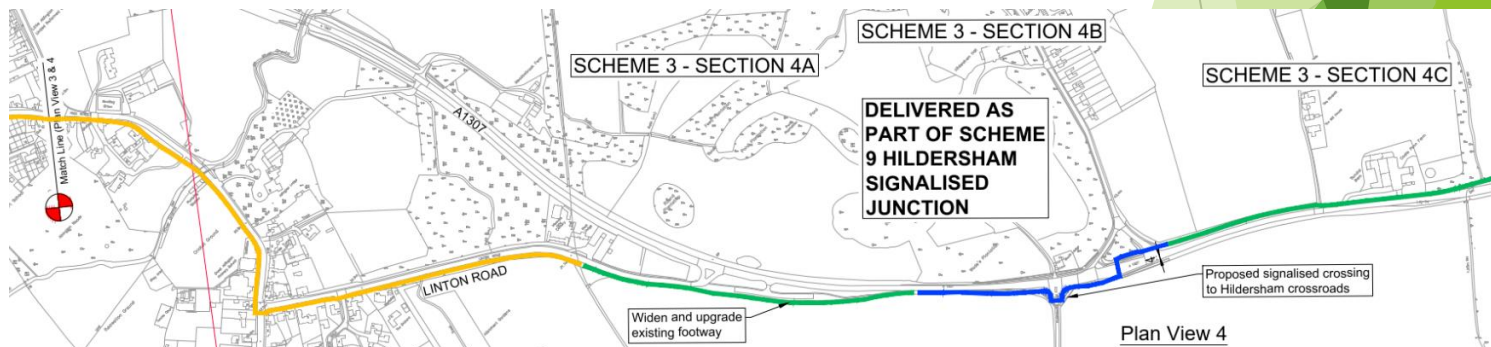
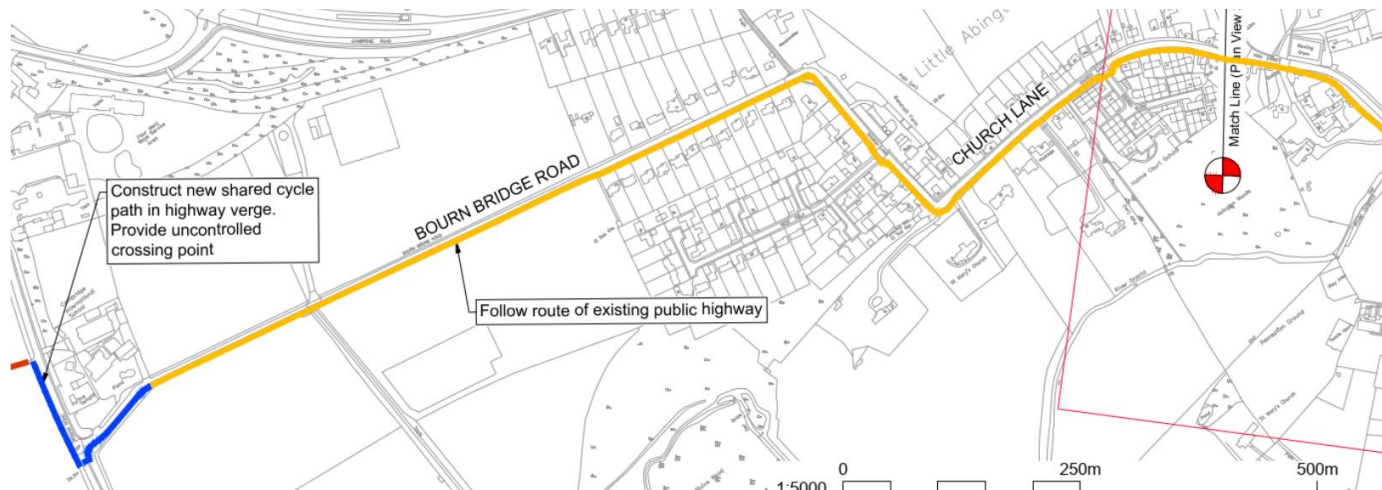

## Scheme 3 - Linton Greenway

### Section 4: Newmarket Road to Dalehead Foods

#### Cycling Level of Service (CLOS) assessment

Route	Sub-Categories	Score
<b>A</b> (Newmarket Road - Bourn Bridge Road - Church Lane - Linton Road)	Cohesion	33
	Directness	
	Safety	
	Comfort	
	Attractiveness	
<b>B</b> (Newmarket Road - Bourn Bridge Road - Church Lane - High Street - Pampisford Road)	Cohesion	32
	Directness	
	Safety	
	Comfort	
	Attractiveness	
<b>C</b> (Newmarket Road - Pampisford Road)	Cohesion	33
	Directness	
	Safety	
	Comfort	
	Attractiveness	

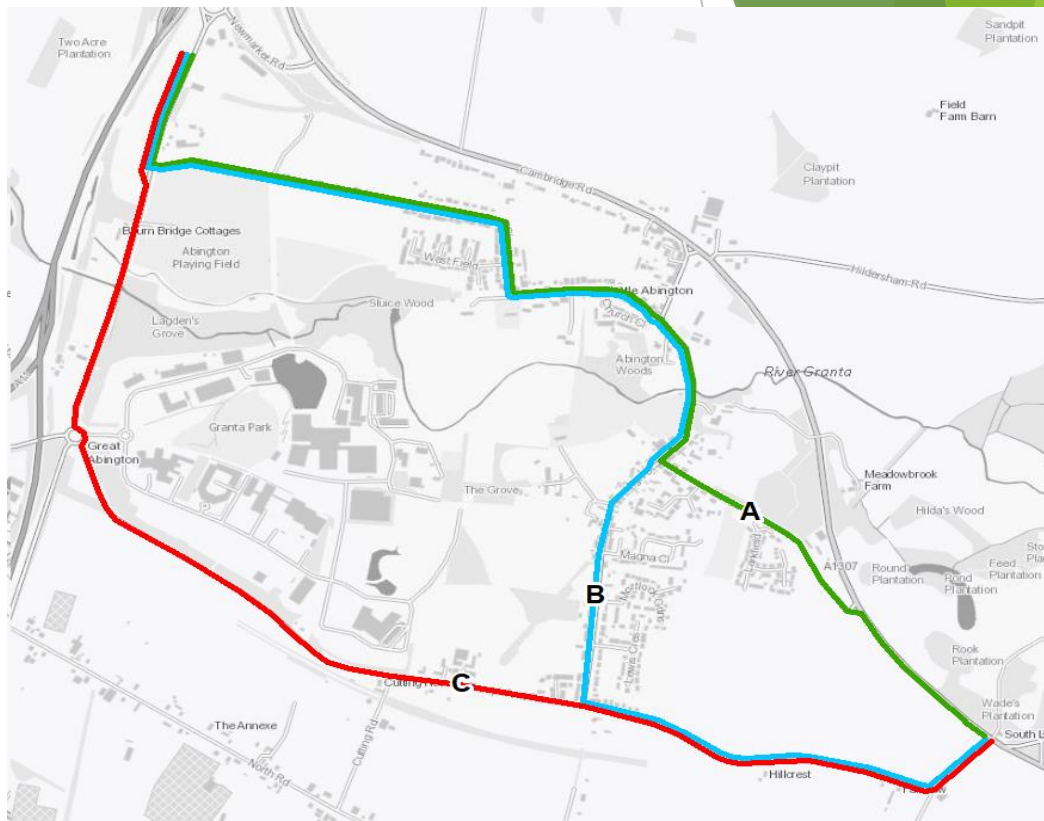

## Scheme 3 - Linton Greenway

### Section 4: Newmarket Road to Dalehead Foods

#### Summary of Route review

Option A and Option C scored the same based on the Cycle Level of Service Assessment, but Option A is the shortest route and does not require additional land take

Given the rural nature of the Abingtons and the average levels of traffic, providing on-carriageway facilities is LTN 1/20 compliant

The assessment undertaken has been from a technical perspective and there are other considerations to take into account

Option C presents the most challenges in terms of buildability due to the requirement for a segregated facility for pedestrians and cyclists

However it presents the most connection to Granta Park which Option A and B bypass. Options A & B would require an additional spur to link up

Potentially scope in the future to provide an improved cycle link to Granta Park through CSET Phase 2 or S106 funding from Granta Park

## Scheme 3 - Linton Greenway

### Section 4: Newmarket Road to Dalehead Foods

Current Status	<ul style="list-style-type: none"><li>- Current preferred option for Greenway alignment is through the Abingtons as most deliverable route</li><li>- Secured funding to improve scheme proposals in line with LTN 1/20, including speed reduction, in order to tie in with current proposals for Hildersham junction signalisation proposals on scheme 9</li><li>- Reviewing further Pampisford road route option and interface with Granta Park/CSET Phase 2 following engagement with Little Abington and Great Abington Parish Councils around the route selection process</li><li>- Secured funding to look at developing proposals that realigns the A1307 for this short section in order to provide the 1m segregation and 2.5m path and decommission existing laybys north of Dalehead foods</li></ul>
Next Steps	<ul style="list-style-type: none"><li>- Provide further specific feedback on the Pampisford route to Little Abington and Great Abington Parish Councils (Route C)</li><li>- Present revised proposals regarding specific design proposals for the Abington route (Route A)</li><li>- Progress the scheme through detailed design and Road Safety Audit processes</li></ul>

Questions / Comments



## Scheme 9 - Hildersham Junction Signalization

Current Status	Design developed following feedback from previous meeting on Pampisford Road crossing alignment
Next Steps	<ul style="list-style-type: none"> <li>- Complete final land negotiations and Road Safety Audit process</li> <li>- Target to be on site in Winter 2021/Spring 2022</li> </ul>

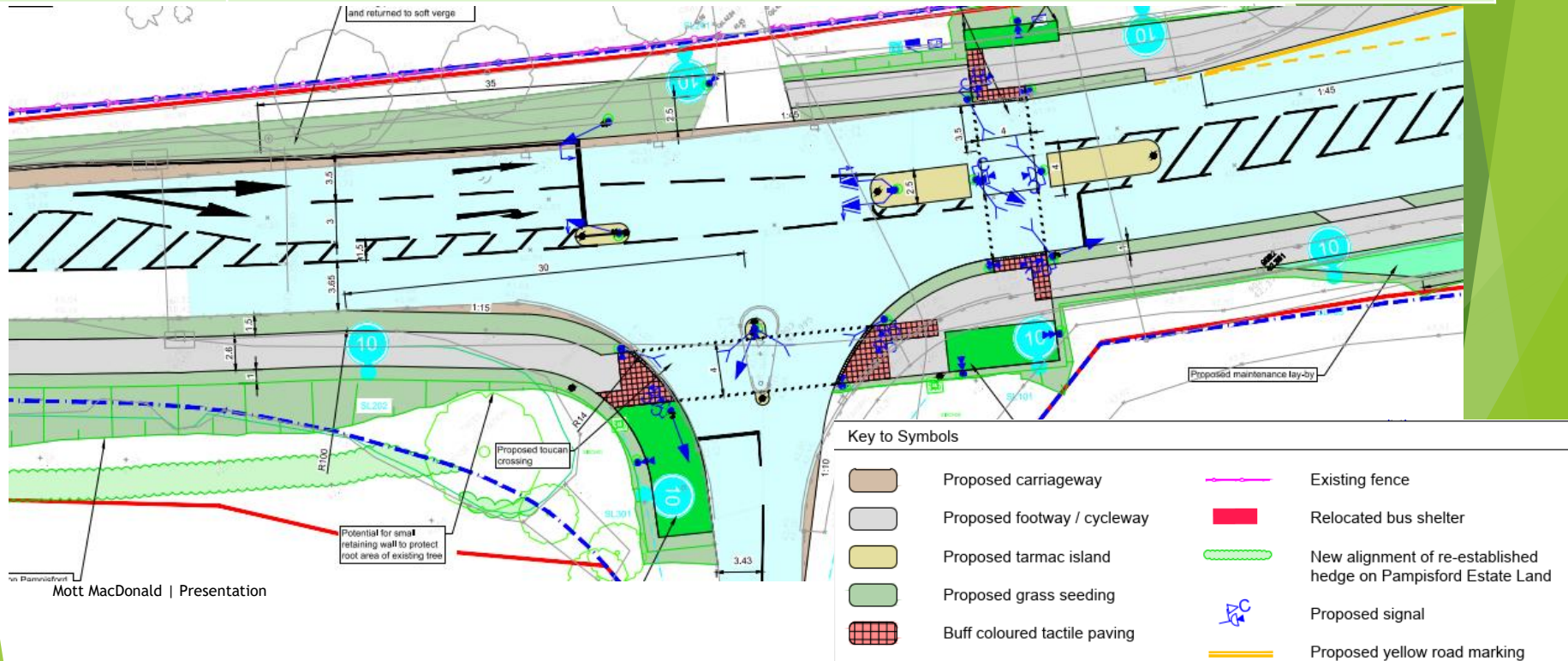

Questions / Comments

## Scheme 3 - Linton Greenway

### Section 5: Linton Village College to Linton

Current Status	<ul style="list-style-type: none"><li>- Secured funding to carry out improvements to Linton Village College junction</li><li>- Incorporate segregation for short section through Linton Meadows, as requested by Linton Parish Council</li></ul>
Next Steps	<ul style="list-style-type: none"><li>- Progress the scheme through detailed design and Road Safety Audit process</li><li>- Target construction on site during Winter 2021 / Spring 2022</li></ul>

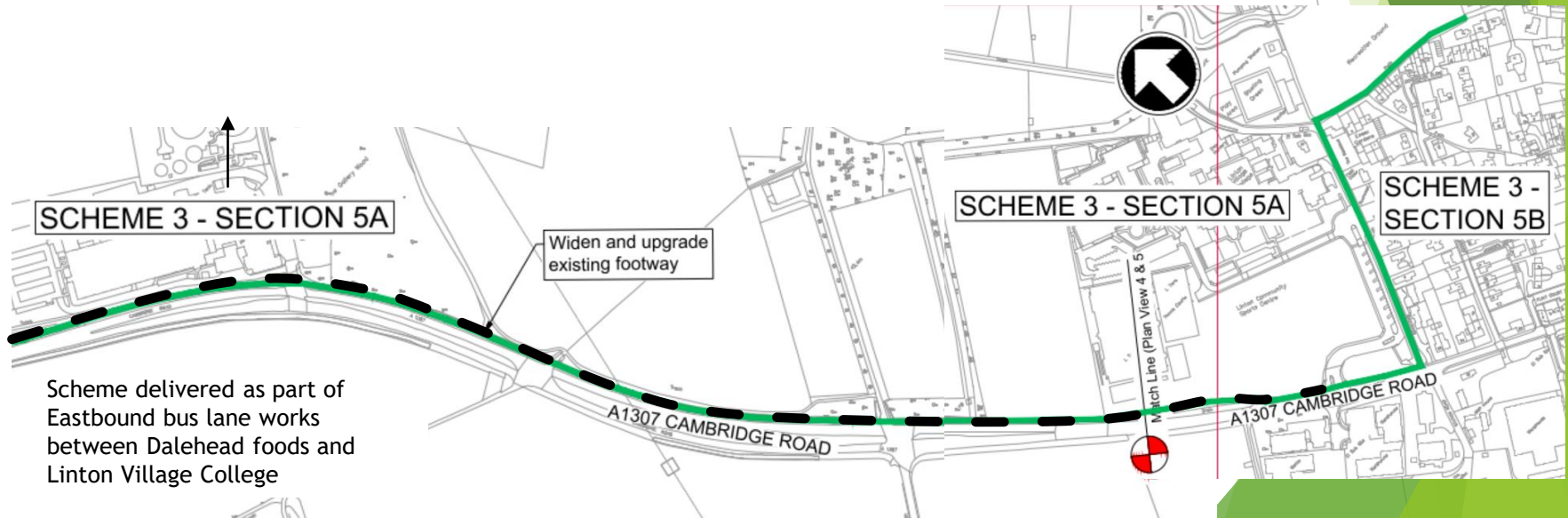

## Scheme 3 - Linton Greenway

### Section 5: Linton Village College to Linton

Current Status	<ul style="list-style-type: none"><li>- Secured funding to carry out improvements to Linton Village College junction</li><li>- Incorporate segregation for short section through Linton Meadows, as requested by Linton PC</li></ul>
Next Steps	<ul style="list-style-type: none"><li>- Progress the scheme through detailed design and Road Safety Audit process</li><li>- Target construction on site during Winter 2021 / Spring 2022</li></ul>

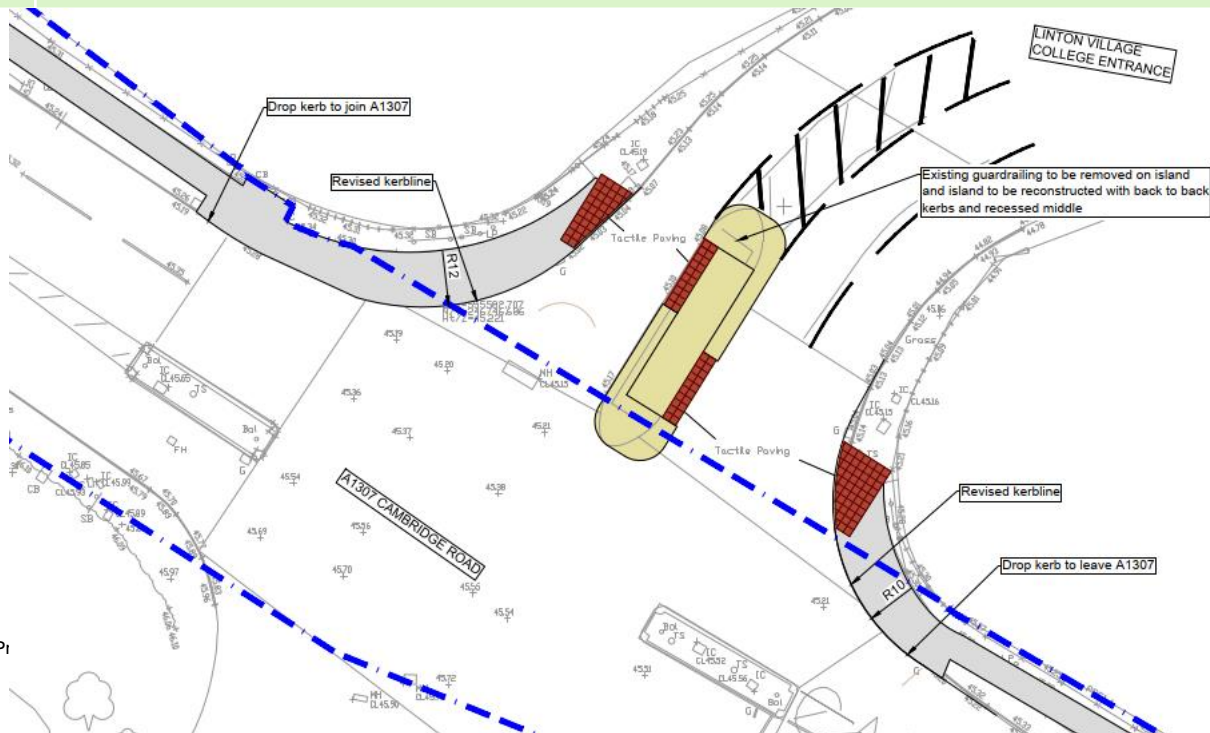

Questions / Comments

## Scheme 14 - Westbound Bus Lane

### Current Status

Scheme formally removed from CSET Phase 1 programme at GCP March board meeting, therefore no further developments proposed

## Scheme 15 - Bartlow Road Roundabout

### Current Status

- Finalising design and tender documents to issue documents to contractors for pricing
- Crossing distance reduced for exit arm of Cambridge-bound arm
- Ongoing discussions regarding land acquisition for the scheme

### Next Steps

- Complete final land negotiations & Tender process
- Target to be on site in Spring/Summer 2022 following advance utility diversion works

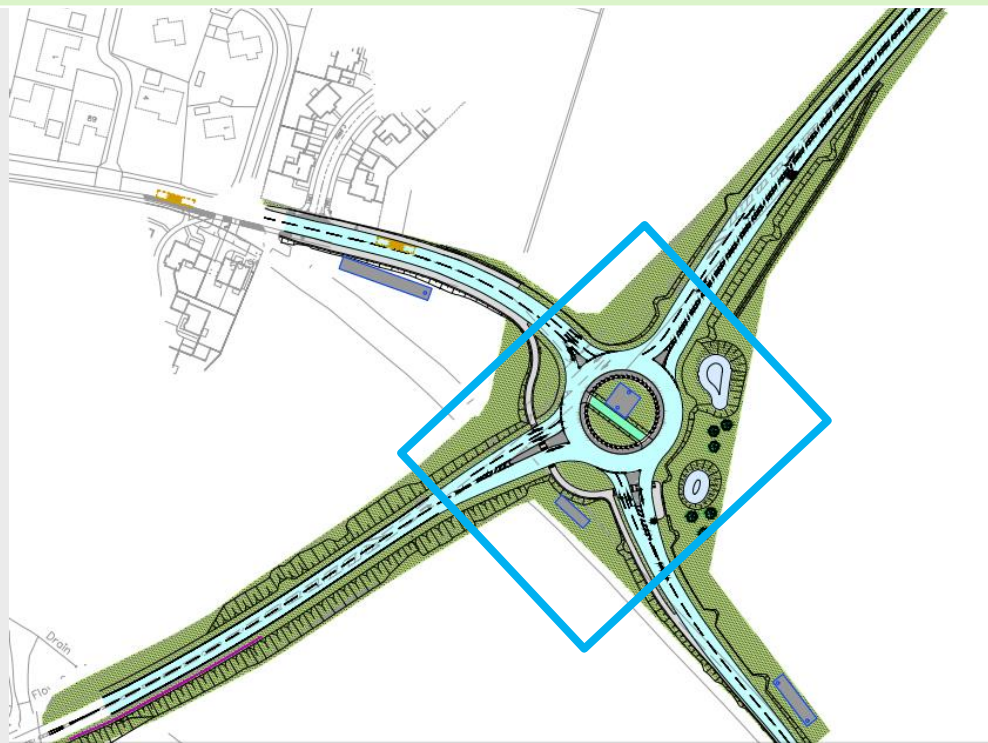

### Key to Symbols

-  Carriageway Resurfacing
-  Proposed seeding
-  Proposed traffic island
-  Proposed footway
-  Bodpave cellular pavers
-  Tactile paving
-  Proposed road markings
-  Proposed trees
-  Chevron blockworks with 30% slopes
-  Proposed Underground Geo-cellular Storage Crates



## Scheme 15 - Bartlow Road Roundabout

### Current Status

- Finalising design and tender documents to issue documents to contractors for pricing
- Crossing distance reduced for exit arm of Cambridge-bound arm
- Ongoing discussions regarding land acquisition for the scheme

### Next Steps

- Complete final land negotiations & Tender process
- Target to be on site in Spring/Summer 2022 following advance utility diversion works

Bartlow Road  
(Towards Linton)

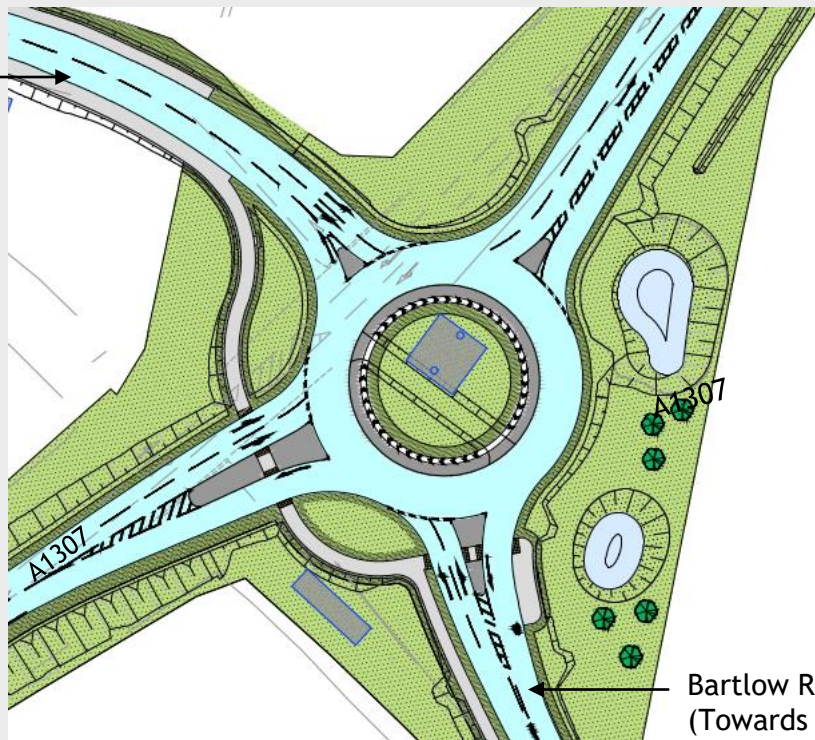

Bartlow Road  
(Towards Bartlow)

### Key to Symbols

- Carriageway Resurfacing
- Proposed seeding
- Proposed traffic island
- Proposed footway
- Bodpave cellular pavers
- Tactile paving
- Proposed road markings
- Proposed trees
- Chevron blockworks with 30% slopes
- Proposed Underground Geo-cellular Storage Crates



Questions / Comments

## Scheme 16 - Right turn ban at Dean Road (south) Crossroads

Current Status	- Concluding discussions with CCC Safety team to provide right turn facility out of Dean Road for pedal cycles only
Next Steps	- Complete Tender process as part of Scheme 15 Bartlow road roundabout - Construction to commence once scheme 15 roundabout is in operation

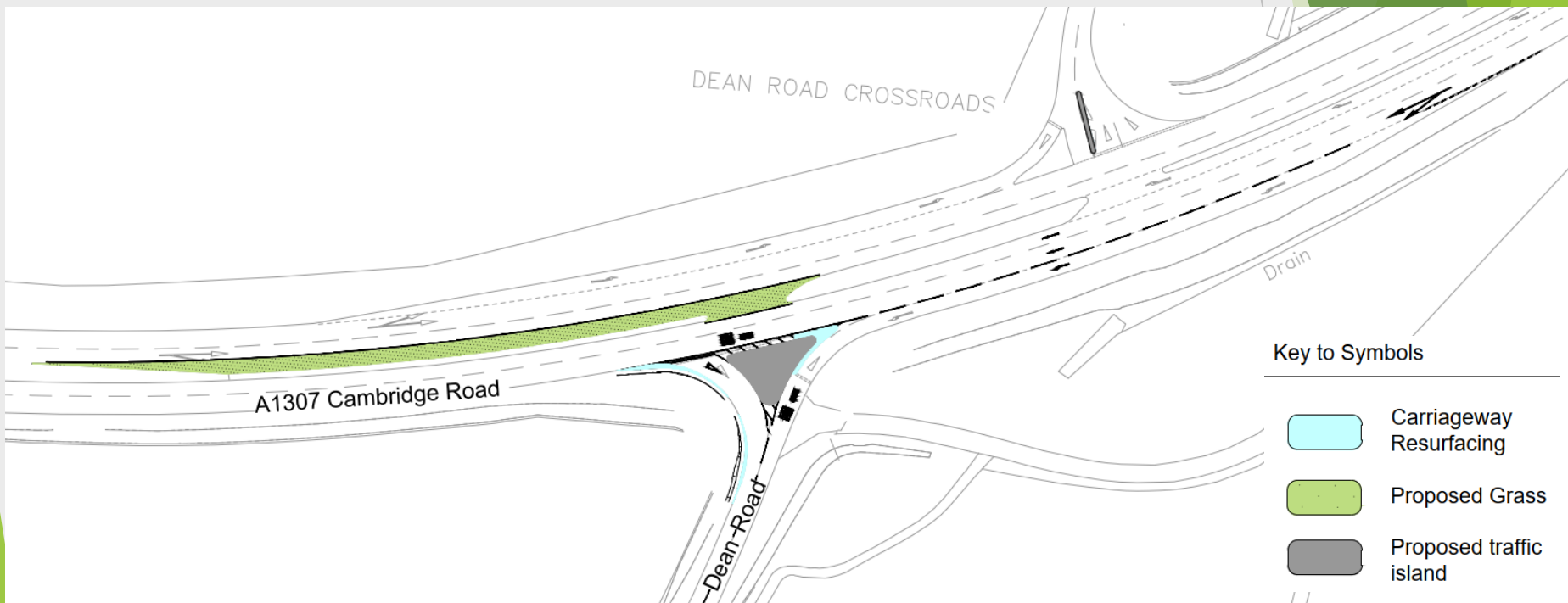

Questions / Comments

## Scheme 17 - Average Speed Camera Installation between Horseheath and Haverhill

Current Status

- Currently on site and due to be completed by end of May

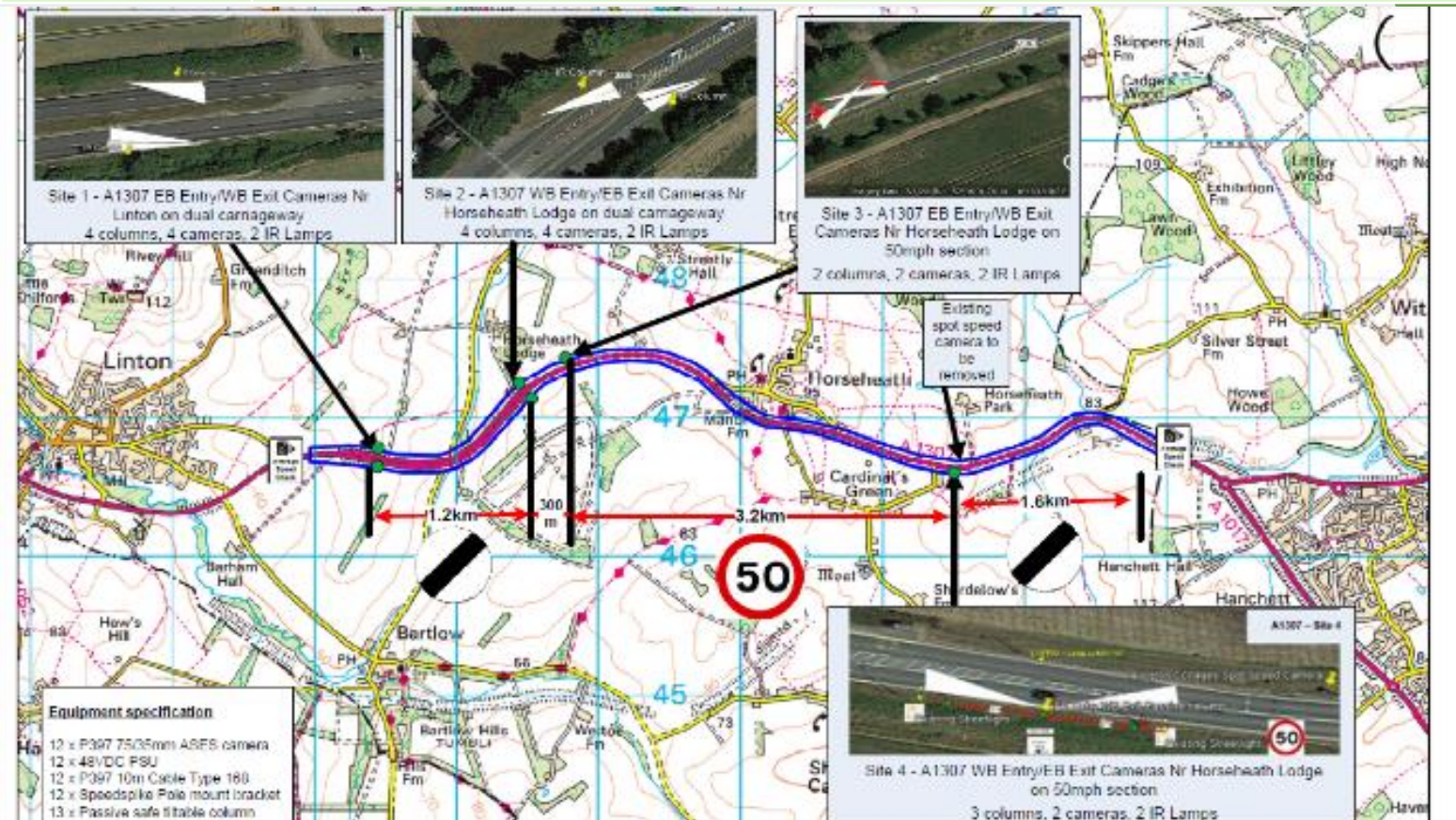

Questions / Comments