

DO NOT SCALE

100  
0 10  
Millimetres

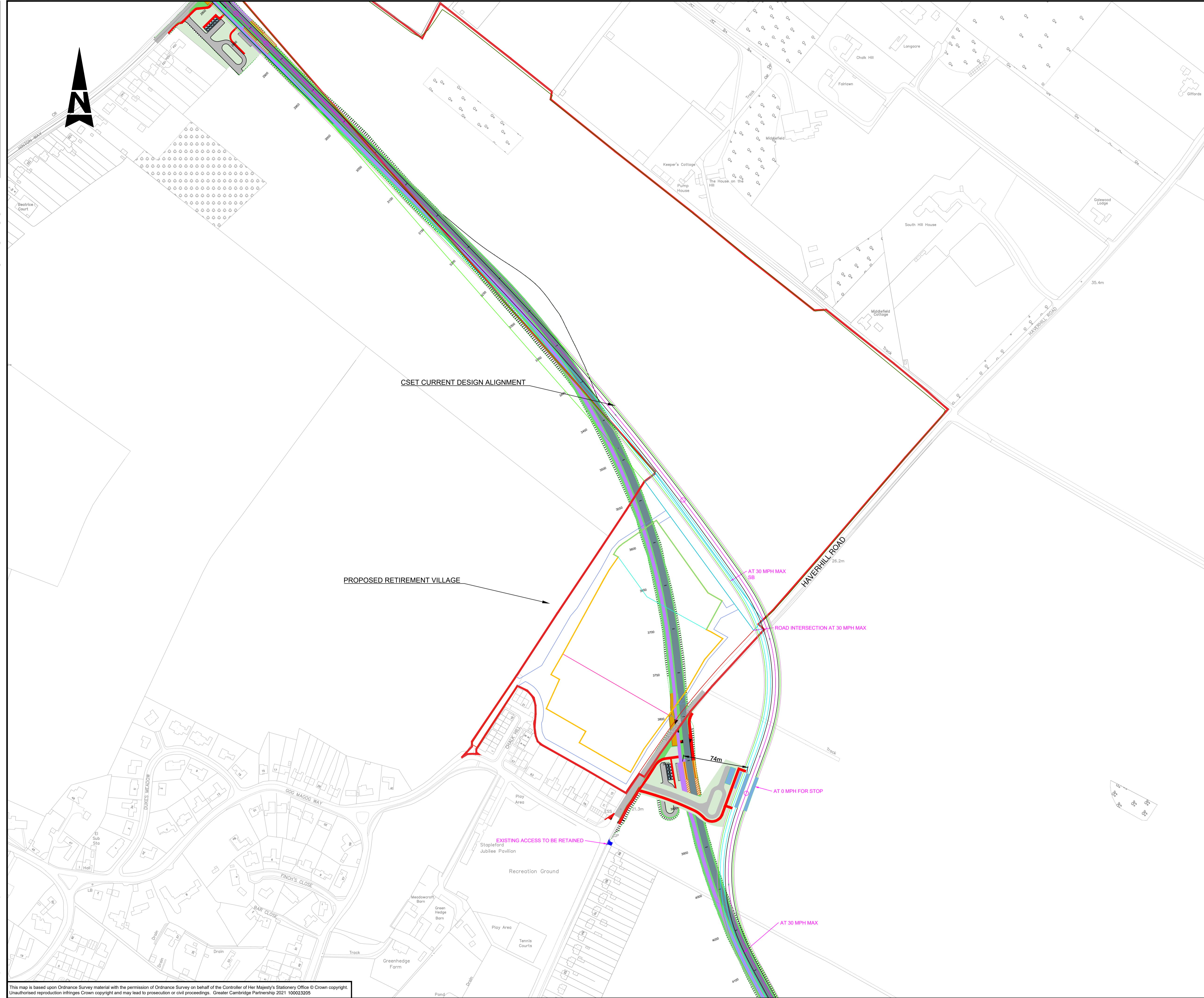

- Notes:**
- THIS DRAWING IS A DRAFT WORK IN PROGRESS AND REQUIRES RAW SOURCE FILES TO VERIFY IMPACT FROM ADJACENT PLANNING APPLICATIONS.
  - THIS DRAWING IS NOT TO BE SCALED. THE CONTRACTOR IS TO VERIFY DIMENSIONS ON SITE AND ADVISE OF ANY INFORMATION DISCREPANCIES.
  - THIS DRAWING IS BASED AROUND SCALED AND TRACED PDF FILES FOR THE PROPOSED DEVELOPMENT. THE ACCURACY OF THESE CANNOT BE RELIED UPON
  - ALL DIMENSION REFERENCED ARE IN METRES
  - DRAWING IS TO BE PRINTED IN COLOUR.
  - THE AERIAL EXTRACT IS TAKEN FROM THE ILLUSTRATIVE MASTERPLAN FROM THE PLANNING APPLICATION
- KEY:**
- PLANNING APPLICATION BOUNDARY
  - VERGE
  - INDICATIVE EARTHWORKS (TBC)
  - 3.5m ATC

**SAFETY, HEALTH AND ENVIRONMENTAL INFORMATION**

In addition to the hazards/risks normally associated with the types of work detailed on this drawing, note the following significant residual risks (Reference shall also be made to the design hazard log).

Construction  
TRUNK WATER MAIN AND MEDIUM PRESSURE GAS MAIN IN VICINITY

Maintenance/ Cleaning  
NONE

Use  
NONE

Decommissioning / Demolition  
NONE

Rev.	Date	Description	By	Chk'd	App'd
P01.2	19/05/2022	OPTION 2 ALIGNMENT AMENDED	RE	AH	AH

Drawing Status: **WORK IN PROGRESS- DRAFT** Suitability: **S0**

**ATKINS**

The Axis  
10 Holliday Street  
Birmingham  
West Midlands  
B1 1TF

Tel: +44 (0)121 483 5000  
Fax: +44 (0)121 483 5252  
Copyright © Atkins Limited (2021) www.atkinsglobal.com

Client: **GREATER CAMBRIDGE PARTNERSHIP**

GREATER CAMBRIDGE PARTNERSHIP

Project Title: **CAMBRIDGE SOUTH EAST TRANSPORTATION PHASE 2**

Drawing Title: **STAPLEFORD RESIDENTIAL DEVELOPMENT 30 MPH VERSION 2 (OPTION 2)**

Scale	Designed / Drawn	Checked	Approved	Authorised
1:2000	JS	AH	AH	PG
Original Size	Date	Date	Date	Date
A1	05/04/2022	05/04/2022	05/04/2022	
Drawing Number	Project	Originator	Volume	Project Ref. No.
	5210174-ATK-HGN-00-DR-00022			P01.2
Location	Type	Role	Number	Revision
				P01.2

Plotted by: EVANS944 Date: May 19, 2022 9:36am

This map is based upon Ordnance Survey material with the permission of Ordnance Survey on behalf of the Controller of Her Majesty's Stationery Office © Crown copyright. Unauthorised reproduction infringes Crown copyright and may lead to prosecution or civil proceedings. Greater Cambridge Partnership 2021 100023205