

DO NOT SCALE

Millimetres  
0 10 100

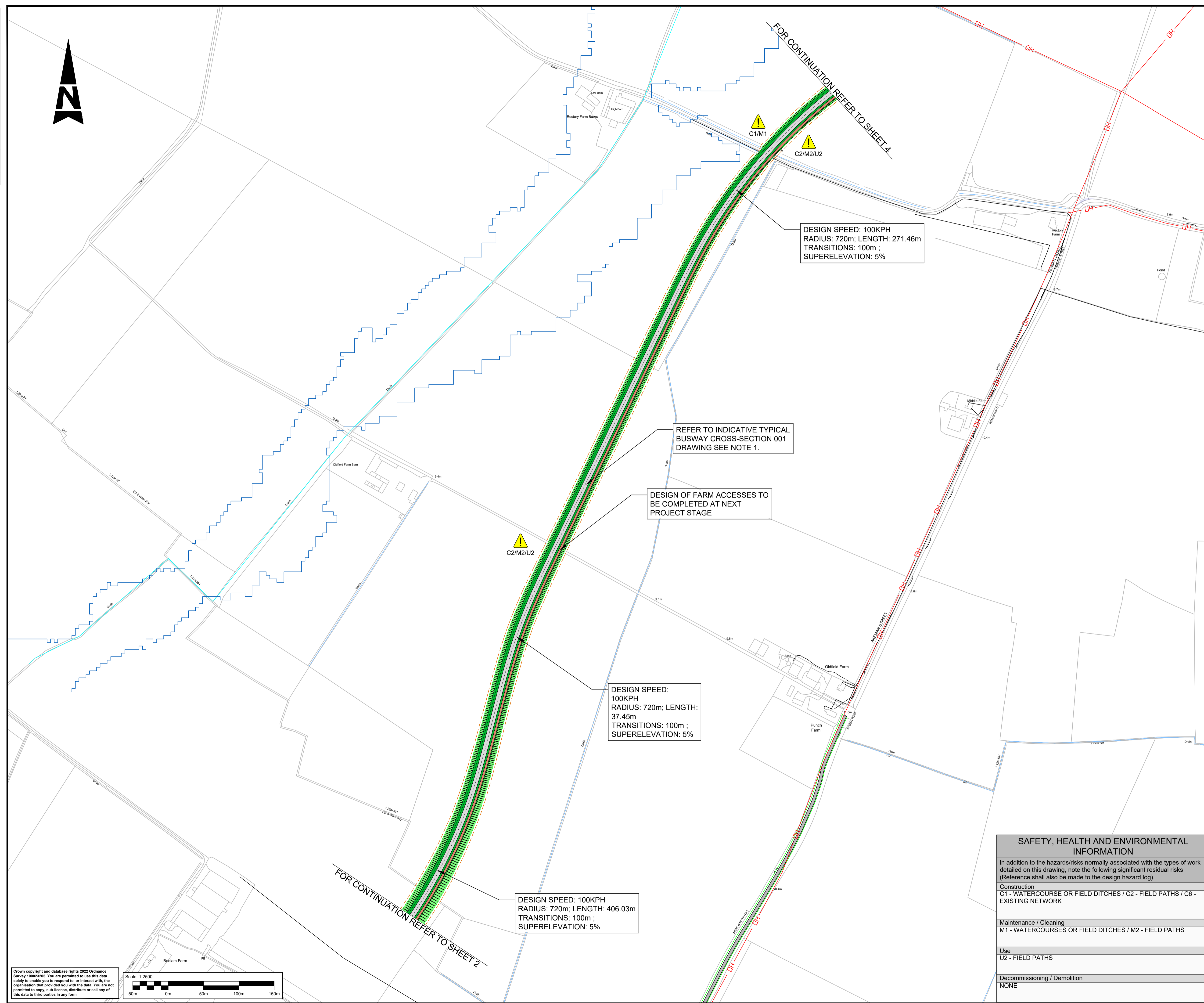
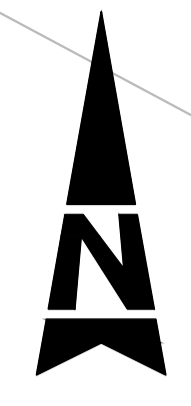

DESIGN SPEED: 100KPH  
RADIUS: 720m; LENGTH: 271.46m  
TRANSITIONS: 100m ;  
SUPERELEVATION: 5%

REFER TO INDICATIVE TYPICAL  
BUSWAY CROSS-SECTION 001  
DRAWING SEE NOTE 1.

DESIGN OF FARM ACCESSES TO  
BE COMPLETED AT NEXT  
PROJECT STAGE

DESIGN SPEED:  
100KPH  
RADIUS: 720m; LENGTH:  
37.45m  
TRANSITIONS: 100m ;  
SUPERELEVATION: 5%

DESIGN SPEED: 100KPH  
RADIUS: 720m; LENGTH: 406.03m  
TRANSITIONS: 100m ;  
SUPERELEVATION: 5%

- NOTES:**
- THIS SHOULD BE READ IN CONJUNCTION WITH THE TYPICAL CROSS-SECTIONS W2NC-ATK-HGN-XX-DR-CH-000001 TO 000003 AND DESIGN REPORT W2NC-ATK-HGN-XX-RP-CH-000001.
  - PROPOSED EARTHWORK SLOPES TO BE 1(H) : 3(V) . THIS IS INDICATIVE ONLY AND TO BE CONFIRMED IN NEXT STAGES AFTER GROUND INVESTIGATIONS
  - PLANTING AND LANDSCAPING DETAILS ARE FOR ILLUSTRATIVE PURPOSES ONLY.
  - WATERBODY CROSSINGS TO BE DESIGNED IN NEXT STAGES.
  - SOME MINOR MODIFICATION TO SIDE ROADS MAY BE NECESSARY.THESE WILL BE CONSIDERED IN DETAIL IN THE NEXT DESIGN STAGE.
  - DEPARTURES IDENTIFIED ARE INDICATIVE AT THIS STAGE AND TO BE CONFIRMED AT THE NEXT ONE.
  - DRAINAGE AND SUDS FEATURES TO BE DESIGNED IN THE NEXT STAGE. THESE ARE TO BE INCORPORATED WITH THE HIGHWAY BOUNDARY.
  - MERE WAY WORKS ARE BEING DEVELOPED BY OTHERS

- KEY:**
- PROPOSED BUSWAY / CARRIAGEWAY
  - PROPOSED VERGE/SWALE
  - PROPOSED EARTHWORKS
  - PROPOSED FOOTWAY/CYCLEWAY
  - EXISTING PONDS / LAKES
  - EXISTING RELEVANT FIELD / HIGHWAY DITCHES
  - UNDERGROUND UTILITIES
  - OVERHEAD CABLE
  - EXISTING WATERCOURSES
  - PROPOSED HIGHWAY BOUNDARY FENCE
  - FLOOD ZONE 3

Description	Status	Revision	Drawn	Checked	Reviewed	Authorised	Issue Date

AMENDMENTS AFTER GCP AND AUTHORISER COMMENTS

Description	Status	Revision	Drawn	Checked	Reviewed	Authorised	Issue Date
A1	CO2	TFL	DS	PRM	AB		28/11/22

FIRST ISSUE

Description	Status	Revision	Drawn	Checked	Reviewed	Authorised	Issue Date
A1	CO1	AJM	DS	PRM	AB		20/10/22

APPROVED - PUBLISHED A1

**SNC-LAVALIN**  
**ATKINS**

Member of the SNC-Lavalin Group  
Copyright © SNC Lavalin (2022)

5 Wellbrook Court  
Girton Road  
Cambridge  
Cambridgeshire  
CB3 0NA  
Tel: +44 (0)1223 276002  
Fax: +44 (0)1223 277529  
www.atkinsglobal.com

**GREATER CAMBRIDGE PARTNERSHIP**  
Growing and sharing prosperity  
Delivering our City Deal

Project Title: **WATERBEACH TO CAMBRIDGE BUSWAY**

Drawing Title: **WESTERN CORRIDOR**

**SAFETY, HEALTH AND ENVIRONMENTAL INFORMATION**

In addition to the hazards/risks normally associated with the types of work detailed on this drawing, note the following significant residual risks (Reference shall also be made to the design hazard log).

Construction	C1 - WATERCOURSE OR FIELD DITCHES / C2 - FIELD PATHS / C6 - EXISTING NETWORK
Maintenance / Cleaning	M1 - WATERCOURSES OR FIELD DITCHES / M2 - FIELD PATHS
Use	U2 - FIELD PATHS
Decommissioning / Demolition	NONE

Drawing Number	Project	Originator	Volume
W2NC	-	ATK	- HML -
Location	Type	Role	Number
WES	- DR - CH -	000003	
Original Size	Scale	Project Ref. No.	Sheet
A1	1:2500	5209223	3 of 5
			Rev
			C02

Crown copyright and database rights 2022 Ordnance Survey 100023206. You are permitted to use this data solely to enable you to respond to, or interact with, the organisation that provided you with the data. You are not permitted to copy, sub-license, distribute or sell any of this data to third parties in any form.

Scale 1:2500